



6 Abbey Water, Romsey, Hampshire, SO51 8EJ

Winkworth



TOWN CENTRE LIVING

We are delighted to offer this two bedroom two bathroom period property in a prized location close to the heart of Romsey Town, located off the main thorough fare but within a minutes walk of its extensive amenities. Local Facilities include a range of individual shops, schools, leisure facilities, doctors and dentist surgeries and public transport by way of bus and rail services. The M27 can be accessed at junction 3, about 3 ½ miles distant. The major centres of Salisbury, Southampton, Winchester and Portsmouth are all easily accessed.

6 Abbey Water is a charming detached property in the loveliest of positions. The property is entered via the hallway which provides access to the downstairs living accommodation which comprises, kitchen/dining room with a useful range of eye and base level units. There is a spacious sitting room with doors onto the rear walled courtyard garden and a cloakroom. To the first floor are two double bedrooms both with en-suite bathrooms.

Outside double gates provide access to the off road parking space and rear courtyard, with an additional on street parking space to the front of the property. The property benefits from stunning views of The Abbey and Abbey Water with its abundance of wildlife. Viewing is highly recommended.



Winkworth

**Address: 6 Abbey Water, Romsey,
Hampshire, SO51 8EJ**

Council Tax Band: "E"

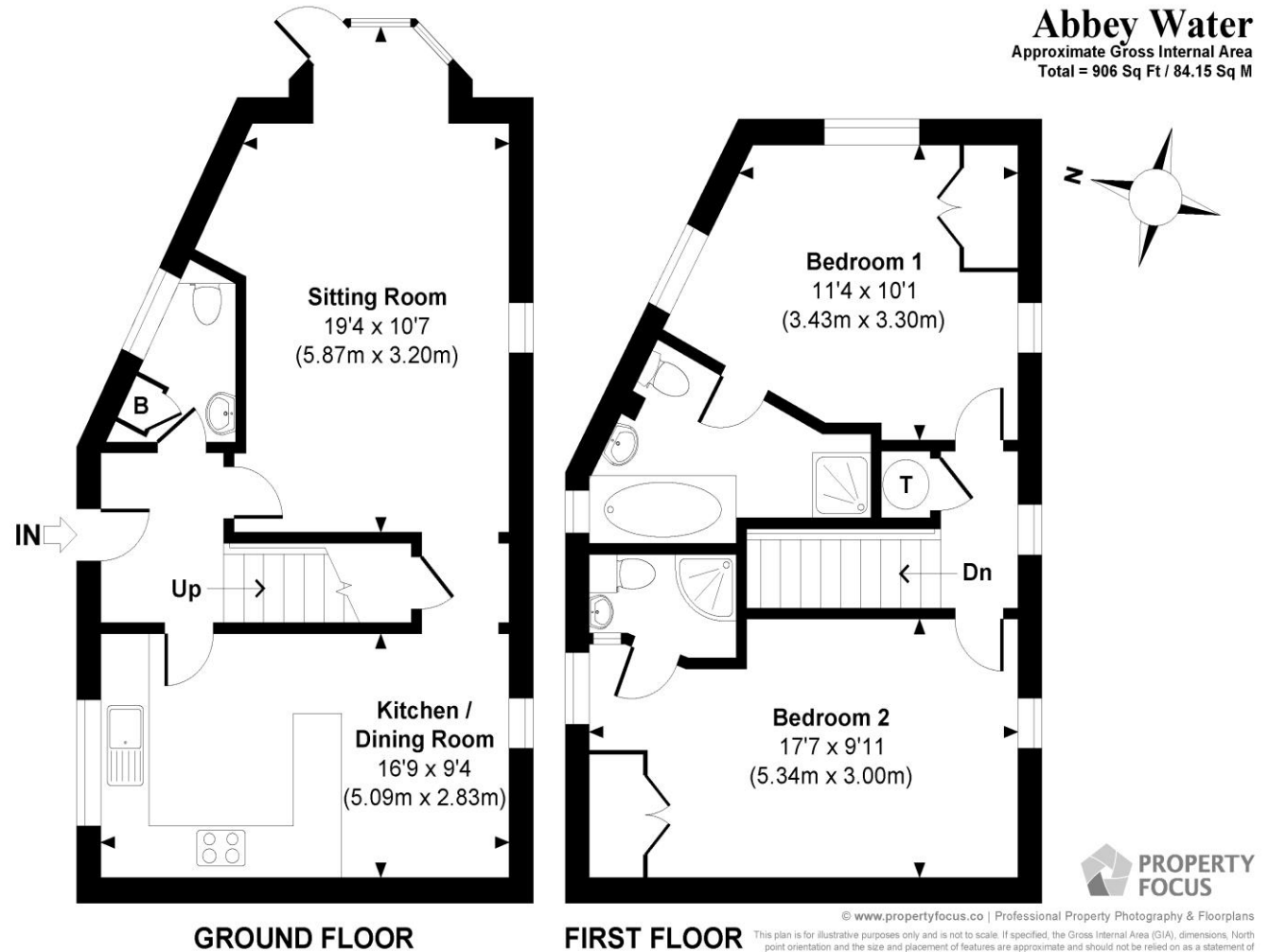

winkworth.co.uk/romsey

Winkworth Romsey

18 Market Place, Romsey, Hampshire, SO51 8NA
01794 511911 | romsey@winkworth.co.uk

winkworth.co.uk/romsey

Winkworth Winchester

2 Black Swan Buildings, Southgate Street,
Winchester, Hampshire, SO23 9DT
01962 866777 | winchester@winkworth.co.uk

Winkworth Mayfair & Country House Department

11 Berkeley Street, Mayfair, London, W1J 8DS
020 7871 0589 | countryhouse@winkworth.co.uk

Winkworth

See things differently