



## Portobello Road, W10

Offers Over £350,000 *Leasehold*



Perfectly positioned in the very heart of Portobello, this superb apartment sits moments from the colour, energy and charm of the world-famous market while enjoying the comfort of its own private outdoor space. Entered at ground floor level, the property offers a well-proportioned reception room, separate kitchen, generous double bedroom, contemporary shower room and a delightful private patio garden — a rare find in such a vibrant central setting.

### KEY FEATURES

- Ground floor entrance
- Private patio garden
- Separate fitted kitchen
- Spacious double bedroom
- Moments from market
- Excellent local transport
- Vibrant W10 location



North Kensington

020 7792 5000 | northkensington@winkworth.co.uk

**Winkworth**

for every step...





Portobello Road needs little introduction. Stretching from Notting Hill through to North Kensington, it is internationally celebrated for its antiques, fashion, street food and lively atmosphere, particularly on the renowned Friday and Saturday market days. A wide selection of cafés, restaurants and everyday conveniences are right on the doorstep, with further amenities found along Ladbroke Grove.

Transport links are excellent with Ladbroke Grove Underground Station (Circle and Hammersmith & City lines) within easy walking distance.







## MATERIAL INFO

**Tenure:** Leasehold  
**Term:** 80 year and 11 months  
**Service Charge:** £1,900 pa  
**Ground Rent:** £20  
**Council Tax Band:** RBKC Band B  
**EPC rating:** E

# Portobello Road

Approx. Gross Internal Area 329 Sq Ft - 30.57 Sq M

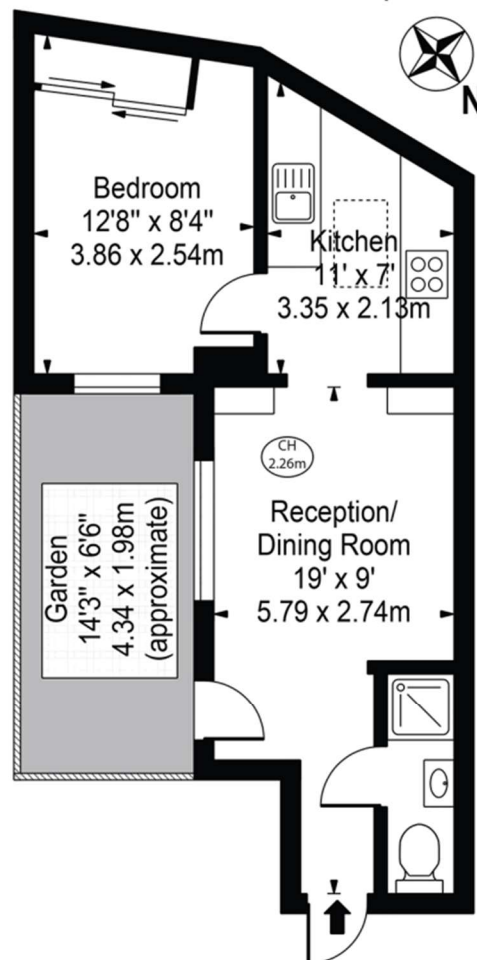

**Ground Floor**  
For Illustration Purposes Only - Not To Scale

This floor plan should be used as a general outline for guidance only and does not constitute in whole or in part an offer or contract. Any intending purchaser or lessee should satisfy themselves by inspection, searches, enquiries and full survey as to the correctness of each statement. Any areas, measurements or distances quoted are approximate and should not be used to value a property or be the basis of any sale or let.

Copyright Morriarti Photography & Design LTD

Score	Energy rating	Current	Potential
92+	A		
81-91	B		
69-80	C		
55-68	D		66 D
39-54	E	41 E	
21-38	F		
1-20	G		

For more information, scan the QR code or visit the link below

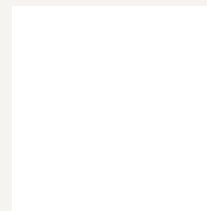

<https://www.winkworth.co.uk/sale/property/LAD260021>

Where no figures are shown, we have been unable to ascertain the information. All figures that are shown were correct at the time of printing.

**North Kensington**

020 7792 5000 | [northkensington@winkworth.co.uk](mailto:northkensington@winkworth.co.uk)

**Winkworth**

for every step...

Winkworth wishes to inform prospective buyers and tenants that these particulars are a guide and act as information only. All our details are given in good faith and believed to be correct at the time of printing but they don't form part of an offer or contract. No Winkworth employee has authority to make or give any representation or warranty in relation to this property. All fixtures and fittings, whether fitted or not are deemed removable by the vendor unless stated otherwise and room sizes are measured between internal wall surfaces, including furnishings.