

Erasmus Street, SW1P

£2,500 PER MONTH

FURNISHED

AT A GLANCE

- Millbank Estate
- Two Bedroom Flat
- First Floor
- Close to Amenities
- Excellent Location
- Council Tax Band: D

Winkworth

for every step...



| Score | Energy rating | Current | Potential |
|-------|---------------|---------|-----------|
| 92+ | A | | |
| 81-91 | B | | 82 B |
| 69-80 | C | | |
| 55-68 | D | | |
| 39-54 | E | 42 E | |
| 21-38 | F | | |
| 1-20 | G | | |

ERASMUS STREET, SW1P

£2,500 PER MONTH

FURNISHED

Accommodation is arranged over the first floor and comprises of entrance hall with storage, cloakroom, two double bedrooms, kitchen, bathroom and reception room.

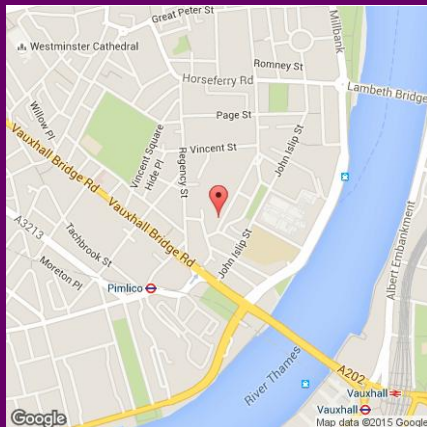

winkworth wishes to inform prospective buyers and tenants that these particulars are a guide and act as information only. All our details are given in good faith and believed to be correct at the time of printing but they don't form part of an offer or contract. No winkworth employee has authority to make or give any representation or warranty in relation to this property. All fixtures and fittings, whether fitted or not are deemed removable by the vendor unless stated otherwise and room sizes are measured between internal wall surfaces - including fireplaces.

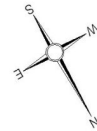

Gainsborough House, SW1

Approx. Gross Internal Area
700 Sq Ft - 65.03 Sq M

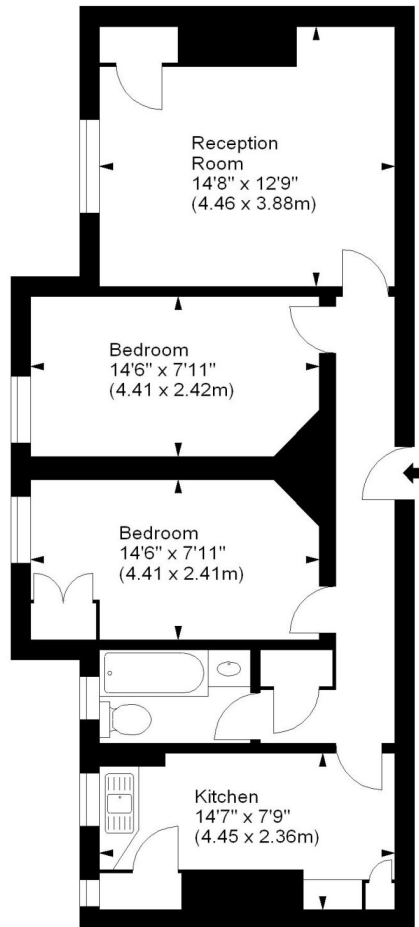

First Floor

For illustration purposes only. Not to scale.
All measurements are taken and shown at floor level.
www.r3photoarchv.co.uk © Photoarchv / Floor Plans / Lease Plans / EPCs

Pimlico & Westminster | 020 7828 1786 |
pimlico@winkworth.co.uk

winkworth.co.uk/pimlico

Winkworth

for every step...