



5 The Triangle, Whiteparish, Salisbury, Wiltshire, SP5 2RT

Winkworth



LOVELY FAMILY HOME

5 The Triangle is a three bedroom, link detached house in the highly desirable village of Whiteparish. Day to day amenities are well provided for in the village and include a post office/store, primary school which has been graded outstanding by Ofsted, church, doctor's surgery and a good choice of public houses. Whiteparish has a thriving community and Village Hall. The market town of Romsey provides a wide array of facilities, a little further afield are the cathedral cities of Salisbury and Winchester. The commercial centres of Southampton and Bournemouth are also within a comfortable commute both with their regional airports, whilst the A36 is also only minutes away linking to the M3/A303/M25.

The property, which is offered with no forward chain, is set in a quiet cul-de-sac in the heart of the village. There is a spacious entrance porch way which leads to all principle ground floor rooms. There is a living room with feature fire place which leads through to the separate dining room. The kitchen is adjacent, to which a potential buyer would more than likely knock through in order to create a more 'open plan' living accommodation. There is also conservatory with double doors to the rear garden, as well as a utility room and cloakroom to the ground floor. To the first floor there are three generous bedrooms and a family bathroom. There is also a shower room that was created in the second bedroom. The master bedroom overlooks the rear gardens and given the space, an en suite could easily be added.

As you approach the property, there is a private driveway which leads to the single attached garage. There is a beautiful front garden which is mainly laid to lawn with mature trees. To the rear, the garden has been beautifully landscaped and features a pond as well as a patio area ideal for al fresco dining.



Winkworth

**Address: 5 The Triangle,
Whiteparish, Salisbury, Wiltshire,
SP5 2RT
Council Tax Band: "E"**

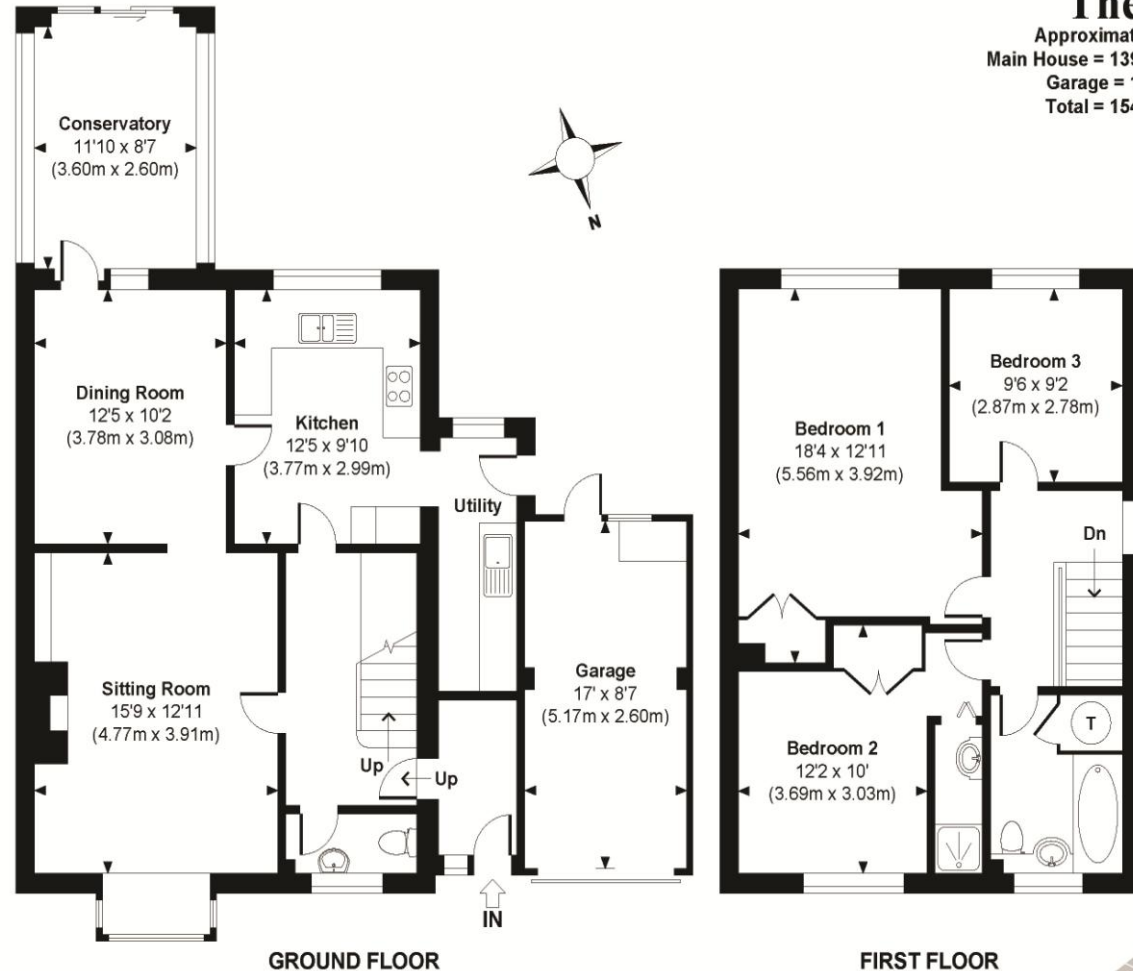

The Triangle

Approximate Gross Internal Area
Main House = 1397 Sq Ft / 129.84 Sq M
Garage = 145 Sq Ft / 13.44 Sq M
Total = 1542 Sq Ft / 143.28 Sq M



© www.propertyfocus.co.uk | Professional Property Photography & Floorplans

Measured and drawn to RICS guidelines. Plan is for illustrative purposes only and is not to scale. All dimensions, North point orientation and the size and placement of features are approximate and should not be relied on as a statement of fact. No responsibility is taken for any error, omission or misrepresentation.

winkworth.co.uk/romsey

Winkworth Romsey

18 Market Place, Romsey, Hampshire, SO51 8NA
01794 511911 | romsey@winkworth.co.uk

winkworth.co.uk/romsey

Winkworth Winchester

2 Black Swan Buildings, Southgate Street,
Winchester, Hampshire, SO23 9DT
01962 866777 | winchester@winkworth.co.uk

Winkworth Mayfair & Country House Department

11 Berkeley Street, Mayfair, London, W1J 8DS
020 7871 0589 | countryhouse@winkworth.co.uk

Winkworth

See things differently