



NORWOOD ROAD, SE24  
£1,900 PER MONTH PART FURNISHED

## A BRIGHT, TWO DOUBLE BEDROOM VICTORIAN CONVERSION LOCATED IN TULSE HILL/HERNE HILL

Herne Hill | 0207 501 8950 | hernehill@winkworth.co.uk

**Winkworth**

for every step...

*winkworth.co.uk*



## DESCRIPTION:

Available exclusively through Winkworth we are delighted to present to let this first floor Victorian conversion apartment. The accommodation briefly comprises of a bright semi-open plan reception/kitchen. The modern kitchen has plenty of wall and base units with wooden countertops and is equipped with the usual integrated appliances i.e. fridge/freezer, electric hob, electric oven, washing machine and a dishwasher. The luxury modern bathroom has a shower overhead, a wash hand basin and a WC. There are two good sized double bedrooms to the rear of the property and the property benefits from double glazing throughout and lovely, large sash windows perfect for giving plenty of natural light. The property is offered on a part-furnished basis and is available from the 14th of August 2023.

## AT A GLANCE

- First Floor Victorian Conversion
- Semi-Open Plan Kitchen/Reception Room
- Two Double Bedrooms
- Modern Bathroom
- Part Furnished
- Available 14<sup>th</sup> of August 2023
- Lambeth Council Tax Band: D
- Sole Agent







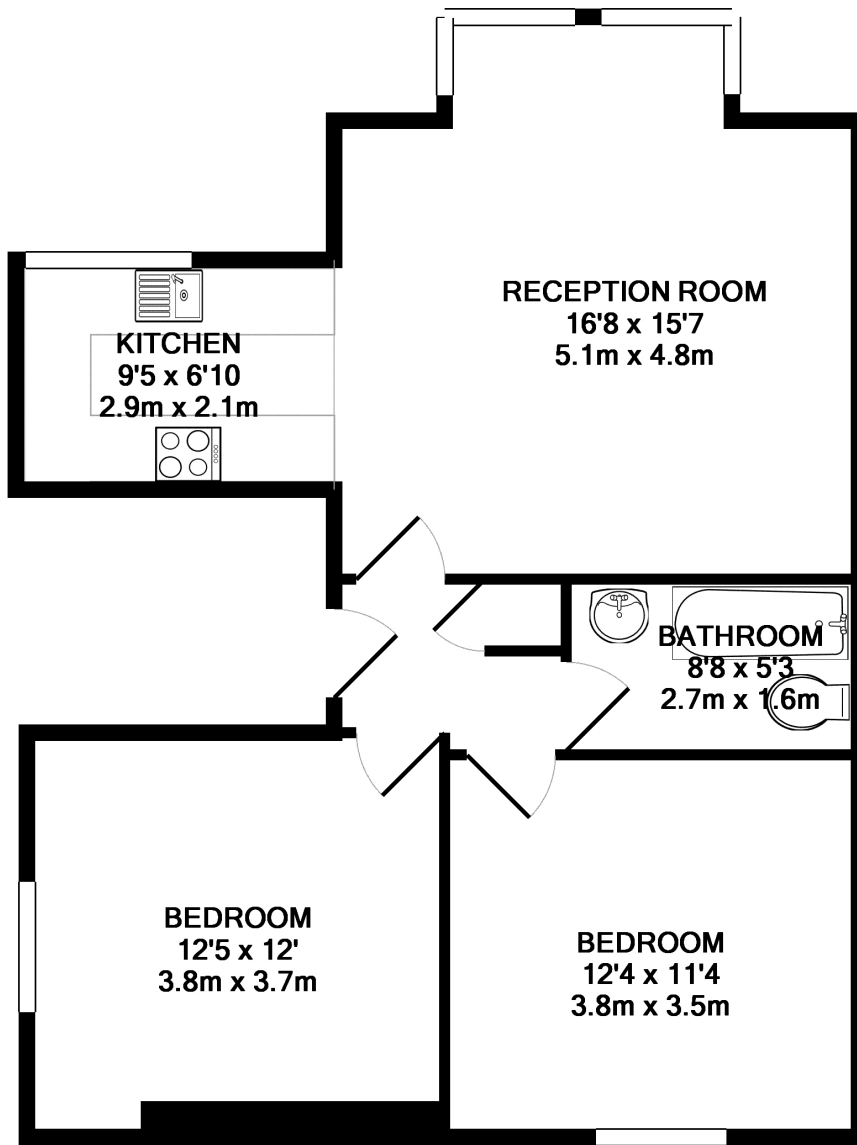

TOTAL APPROX. FLOOR AREA 661 SQ.FT. (61.4 SQ.M.)

Whilst every attempt has been made to ensure the accuracy of the floor plan contained here, measurements of doors, windows, rooms and any other items are approximate and no responsibility is taken for any error, omission, or mis-statement. This plan is for illustrative purposes only and should be used as such by any prospective purchaser. The services, systems and appliances shown have not been tested and no guarantee as to their operability or efficiency can be given

Made with Metropix ©2014

This floorplan is for illustration purposes only and is not to scale. The position and size of doors, windows, appliances and other features are approximate.

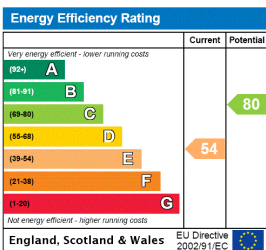

Herne Hill | 0207 501 8950 | hernehill@winkworth.co.uk



for every step...

winkworth.co.uk

Winkworth wishes to inform prospective buyers and tenants that these particulars are a guide and act as information only. All our details are given in good faith and believed to be correct at the time of printing but they don't form part of an offer or contract. No Winkworth employee has authority to make or give any representation or warranty in relation to this property. All fixtures and fittings, whether fitted or not are deemed removable by the vendor unless stated otherwise and room sizes are measured between internal wall surfaces, including furnishings.