

FLAT 2, CHURCH RISE, LONDON, SE23  
**£370,000 LEASEHOLD**

**STYLISH ONE-BED WITH PRIVATE COURTYARD,  
MOMENTS FROM THE STATION**

Forest Hill | | [foresthill@winkworth.co.uk](mailto:foresthill@winkworth.co.uk)





**DESCRIPTION:**

A charming, purpose-built one-bedroom apartment with a separate office, private courtyard, and access to a communal garden. Located just 0.3 miles from Forest Hill Station and close to green spaces, it's offered chain-free and ideal for first-time buyers or investors.







Church Rise, London, SE23

Approximate Area = 592 sq ft / 55 sq m

For identification only - Not to scale

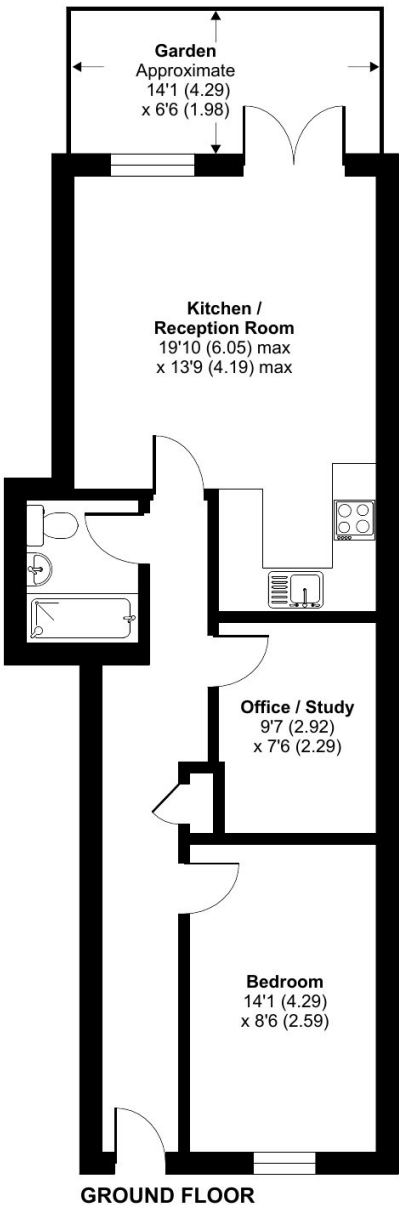

Floor plan produced in accordance with RICS Property Measurement Standards incorporating International Property Measurement Standards (IPMS2 Residential). © nlclicom 2025. Produced for Winkworth Forest Hill and New Cross. REF: 1283400

This floorplan is for illustration purposes only and is not to scale. The position and size of doors, windows, appliances and other features are approximate.

Score	Energy rating	Current	Potential
92+	A		
81-91	B		
69-80	C		
55-68	D	64 D	78 C
39-54	E		
21-38	F		
1-20	G		

Tenure: Leasehold  
Term: 113 years