



SEDGEFORD ROAD, W12

£4,000 PER MONTH UNFURNISHED £4,000 PER CALENDAR MONTH

A spacious four bedroom, two bathroom, Edwardian house with a west facing garden of over 60ft. Unfurnished, Available immediately

Shepherds Bush, 020 8735 3266, shepherdsbush@winkworth.co.uk

Winkworth

winkworth.co.uk/shepherds-bush

DESCRIPTION: Situated on this ever popular tree lined residential road, this light and spacious property with a calm contemporary decor.

The accommodation comprises four double bedrooms, family bathroom, en suite bathroom to the master bedroom, a ground floor W.C, two reception rooms and an extending modern stylish kitchen with dining/breakfast room leading out to the impressive 61 ft. West facing garden.

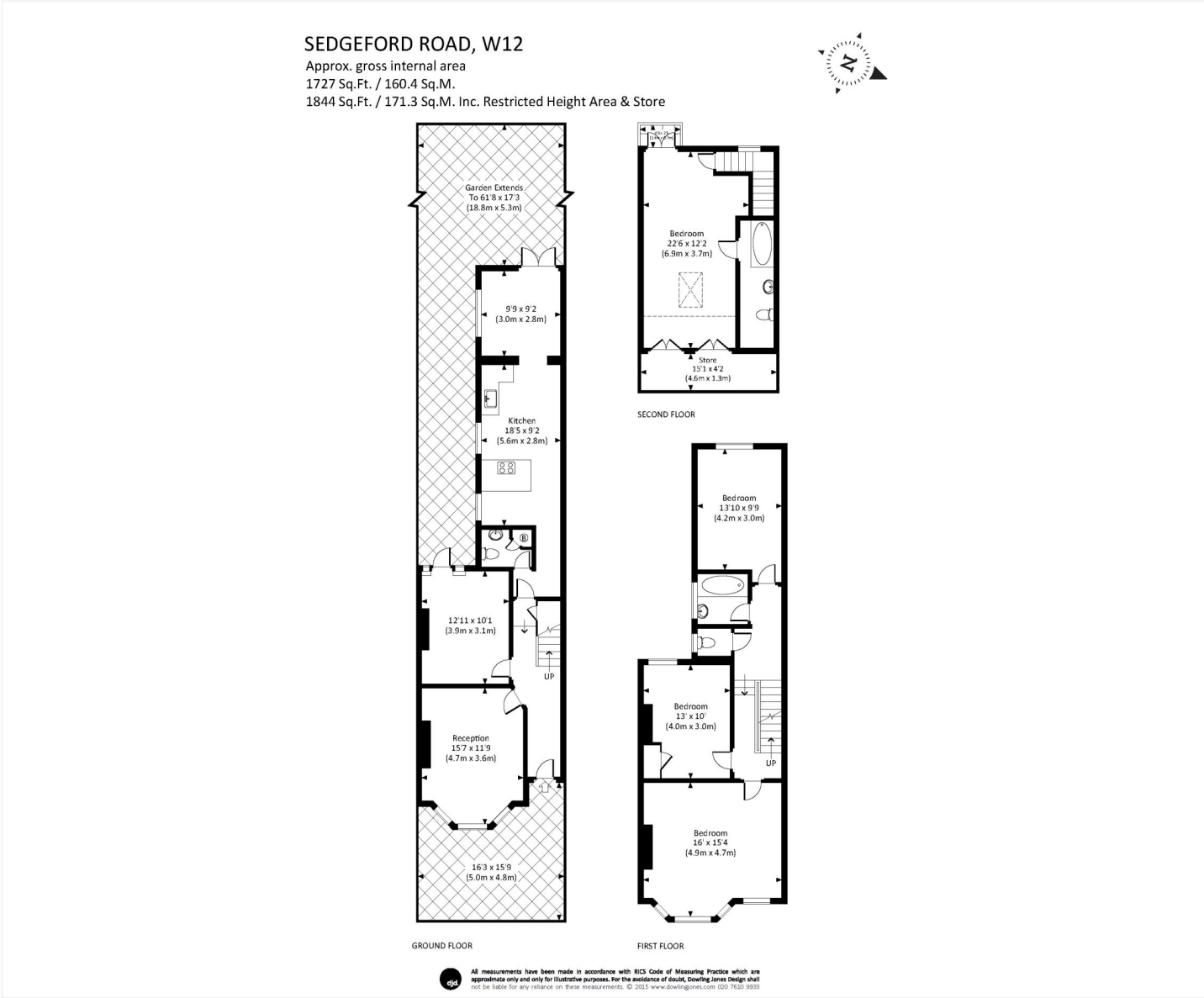

This floorplan is for illustration purposes only and is not to scale. The position and size of doors, windows, appliances and other features are approximate.

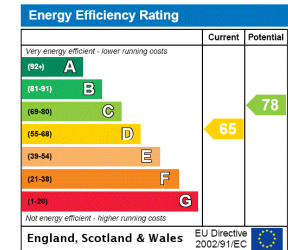

LOCAL AUTHORITY: Hammersmith & Fulham, S.Bush

COUNCIL TAX BAND: G

PARKING RESTRICTIONS:

Shepherds Bush | 020 8735 3266 | shepherdsbush@winkworth.co.uk

Follow us on twitter @WinkworthW12



winkworth.co.uk/shepherds-bush

TENANTS GUIDE

HOLDING DEPOSIT

To secure a property we take one weeks rent as a holding deposit, this must be paid in cleared funds Via bank transfer. Once the landlord has confirmed the acceptance of your offer, we proceed in taking references. Should the landlord not accept or later withdraw from the offer, the holding deposit will be returned in full. Subject to terms & conditions of the holding deposit, where the tenant decide not to move into the property for whatever reason, the holding deposit is forfeited.

REFERENCES:

Prospective tenants are required to provide three references; bank statements, employment and previous/existing landlord. Where a prospective tenant is self-employed or a company owner more detailed references will be required. Where a guarantor is accepted, they should be a UK resident and a property owner, and will be required to provide proof of income and bank reference. Blinc will perform the credit check for both tenant(s) and guarantor(s).

DEPOSIT:

A five-week security deposit is standard for our office (six weeks if the rent is over £50,000 per annum). In most cases Winkworth will be the Deposit Holder, subject to the terms and conditions of the 'Tenancy Deposit Scheme'. Feel free to ask for confirmation of whom Deposit Holder will be.

INVENTORY:

An inventory lists the contents and condition of the property. Where a professional inventory is carried out the landlord pays for the check-in and also pays for the check-out. In other circumstances the landlord may provide their own inventory.

TOTAL COST OF MOVING IN:

You will be required to pay one calendar months' rent in advance and the security deposit

The holding deposit already paid will be deducted from the total amount due, which must be paid on or before the commencement date of the agreement. This will be paid by bank transfer directly into our account*

* Some transfers can take up to three working days to leave your account and to clear in ours. Funds must be cleared in our account before we can allow the tenant to move in.

EPC - ENERGY PERFORMANCE CERTIFICATE

Agents are required to give tenants a copy of the full EPC report prior to your move in date, which will be done at the time the holding deposit is paid and on the day of your move in.

UTILITY COMPANIES:

Although we write to all utility companies, informing them when the tenants are moving into the property, it is the responsibility of the tenants to ensure that they are registered with all utility companies, as you will be asked at the end of the tenancy to provide copies of your final utility bills addressed to the tenant for the property.

TELEVISION & TELEPHONE:

Tenants are responsible for their television licence, whether the landlord provides a television or not. Tenants are also responsible for transferring the telephone landline into their names.

INSURANCE:

The landlord has his/her own property and contents insured this does not include any of the tenant's belongings. It is tenants responsible to insure their own belongings.

The logo for Winkworth, featuring the word "Winkworth" in a white serif font on a dark blue rectangular background.

PETS:

Pets are not permitted under the terms of the tenancy agreement. Should the tenant wish to have a pet(s) in the property they should negotiate this prior to paying the holding deposit. If consent is given this should be confirmed in writing and also included in the tenancy agreement.

PARKING/CAR OWNERS:

Some properties and developments are part of the Local Authorities 'Low Car Housing Scheme' and as such there is no parking in the development or on the property nor any right to apply to the local authority for a parking permit (except those with disabilities who are blue badge holders). If this issue is important to you, we advise seek confirmation from the Local Authority or a member of our staff that any property of interest is not within such a scheme.

Hammersmith and Fulham - Council tax levels 1st April 2025 - 31st March 2026		
Band		2025/26
A		£967.61
B		£1,128.88
C		£1,290.14
D		£1,451.42
E		£1,773.95
F		£2,096.49
G		£2,419.03
H		£2,902.84

Acton and Ealing - Council tax levels 1st April 2025 - 31st March 2026		
Band		2025/26
A		£1,360.68
B		£1,587.47
C		£1,814.24
D		£2,041.02
E		£2,494.57
F		£2,948.14
G		£3,401.70
H		£4,082.04

Shepherds Bush | 020 8735 3266 | shepherdsbush@winkworth.co.uk

Follow us on twitter [@WinkworthW12](https://twitter.com/WinkworthW12)

winkworth.co.uk/shepherds-bush

Winkworth