

**Winkworth**

Pulborough Road, Southfields, SW18 5UJ





A fantastic five bedroom, two bathroom Edwardian home in the highly sought-after Pulborough Triangle, in close proximity to the outstanding Sheringdale and St. Michael's Primary Schools. Sold with no onward chain.

This beautiful home offers accommodation arranged over three floors to include a spacious front reception room with period fireplace, separate kitchen/dining room, and five bedrooms which are serviced by two bathrooms, one of which is en-suite. At the rear is a lovely 44 ft. private garden. There is the potential to further extend on the ground floor subject to the usual consents.

Pulborough Road is a popular residential road well located for access to all of the amenities Southfields has to offer. Of particular note is the close proximity to Sheringdale and St. Michael's Primary Schools, both of which boast outstanding Ofsted ratings. Southfields Underground provides District Line services into central London.

- PERIOD HOUSE
- KITCHEN/DINING ROOM
- SEPARATE RECEPTION
- FIVE BEDROOMS
- TWO BATHROOMS
- FANTASTIC LOCATION
- OUTSTANDING SCHOOLS
- POTENTIAL TO EXTEND (STPP)
- NO ONWARD CHAIN

Pulborough Road, Southfields, SW18 5UJ



**Freehold**

Internal area  
Approximate gross internal area:  
**Total 1,340 sq ft/ 125 sq m**

# Pulborough Road, Southfields, SW18 5UJ



## Pulborough Road

Approximate Gross Internal Area Total = 124.5 sq m / 1340 sq ft  
(Including Eaves)

**Winkworth**

= Reduced headroom below 1.5m / 5'0"



**Ground Floor**  
Sq m 44.9 / Sq ft 483



**Second Floor**  
Sq m 35.7 / Sq ft 385

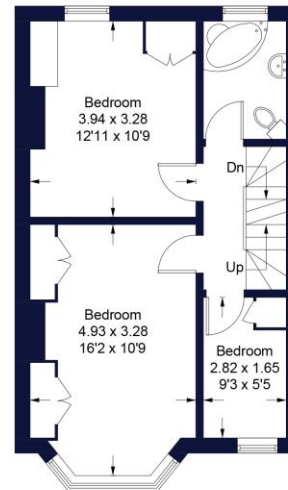

**First Floor**  
Sq m 43.9 / Sq ft 472

Illustration for identification purposes only, measurements are approximate, not to scale. FloorplansUsketch.com © 2020 (ID718373)

W621 Ravensworth 01670 713330

**Winkworth**

Under the Property Misdescriptions Act these particulars are intended as a guide and act as information only. They give a fair overall description for the guidance of potential purchasers or tenants but do not constitute an offer or part of a contract. All details and approximate measurements are given in good faith and are believed to be correct at the time of printing, but any potential purchasers or tenants should not rely on the mis-statements or representations of fact but must satisfy themselves by inspection or otherwise as to their correctness. No employee of Winkworth has authority to make or give any representation or warranty to this property.

Southfields office 241 Wimbledon Park Road, London SW18 5RJ | Tel: 0208 877 1000 | E-mail: Southfields@winkworth.co.uk  
[winkworth.co.uk](http://winkworth.co.uk)