



Grove Hall Court, St John's Wood, London, NW8

£995,000 *Leasehold*

3  1  2 

A top-floor, three-bedroom apartment in this elegant 24/7 portered block. The property offers well-proportioned accommodation with a principal bedroom with en-suite shower room a further two bedrooms and guest bathroom. Grove Hall Court is situated on Hall Road and well located for the amenities of St John's Wood High Street. The closest underground station is St John's Wood (Jubilee line) which is 0.4 miles away.



Winkworth St John's Wood

020 7586 7001 | stjohnswood@winkworth.co.uk



KEY FEATURES

- Leasehold
- Principal Bedroom With En Suite Shower Room
- Two Further Bedrooms
- Bathroom
- Reception Room
- Kitchen
- Communal Gardens
- Porterage
- Passenger Lift
- Double Glazing



MATERIAL INFO

Tenure: Leasehold

Lease Expiry Date: 05/01/2166

Service Charge: £16,445.92 per annum

Service Charge Note: Includes Reserve Fund Contribution of £8,370 per annum

Ground Rent: £0 Annually (subject to increase)

Council Tax Band: G

EPC rating: E



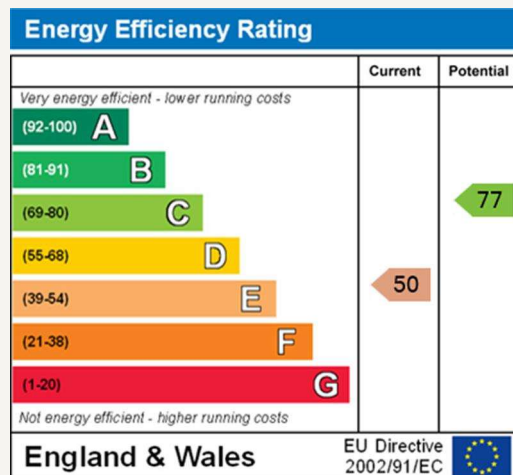

For more information, scan the QR code or visit the link below



<https://www.winkworth.co.uk/sale/property/SJD070016>

GROVE HALL COURT, HALL ROAD, LONDON, NW8 9NY

Approx. Gross Internal Floor Area 1082 sq ft. / 101 sq.m

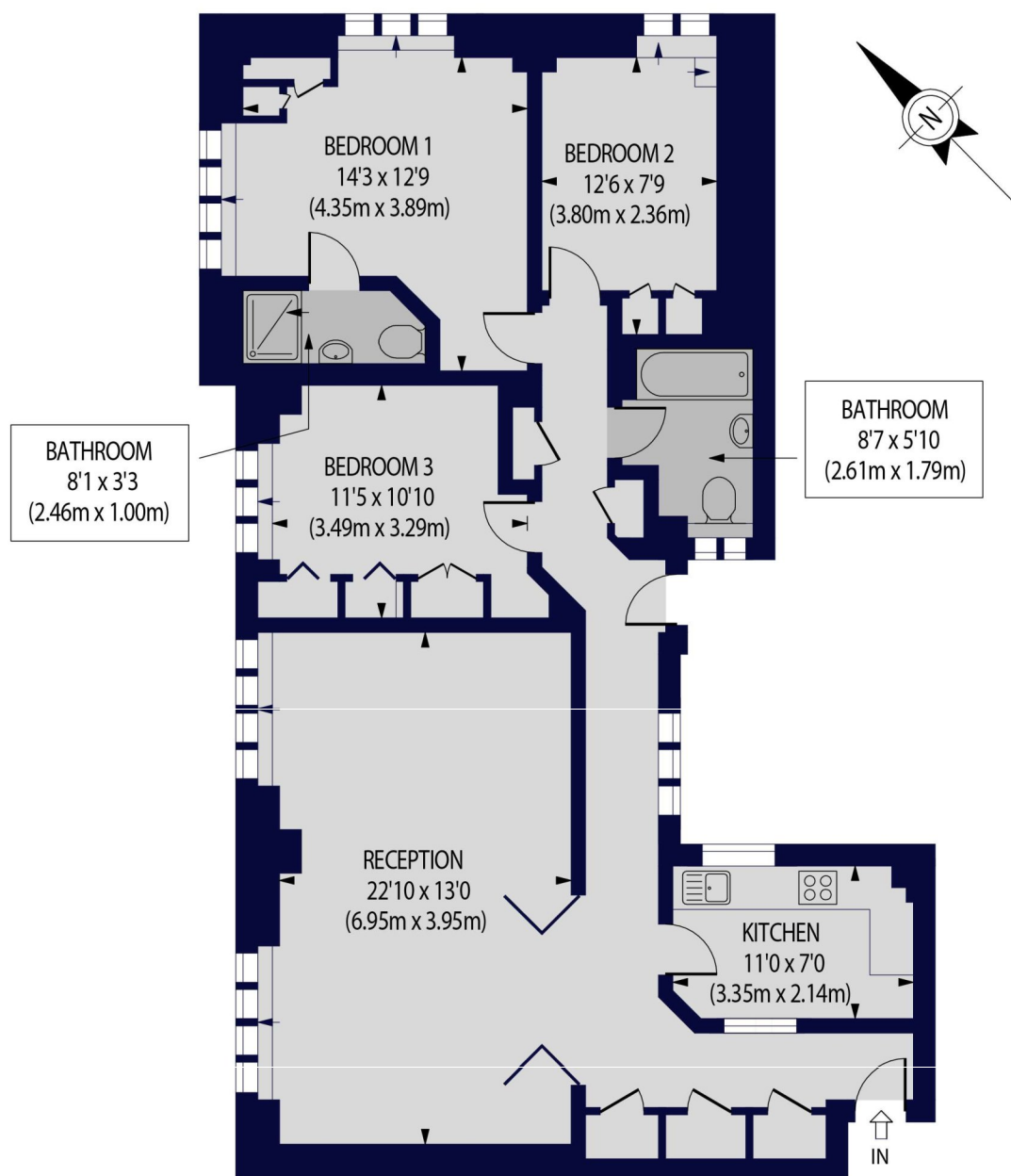

SEVENTH FLOOR

For Illustration Purposes Only - Not To Scale Floor Plan by www.nogaphotostudio.com Ref: No.43999

This floor plan should be used as a general outline for guidance only. Any intending purchaser or lessee should satisfy themselves by inspection, searches, enquiries and full survey as to the correctness of each statement. Any areas, measurements or distances quoted are approximate and should not be used to value a property or be the basis of any sale or let.

Winkworth

Where no figures are shown, we have been unable to ascertain the information. All figures that are shown were correct at the time of printing.

Winkworth St John's Wood

020 7586 7001 | stjohnswood@winkworth.co.uk

Winkworth wishes to inform prospective buyers and tenants that these particulars are a guide and act as information only. All our details are given in good faith and believed to be correct at the time of printing but they don't form part of an offer or contract. No Winkworth employee has authority to make or give any representation or warranty in relation to this property. All fixtures and fittings, whether fitted or not are deemed removable by the vendor unless stated otherwise and room sizes are measured between internal wall surfaces, including furnishings.