



MARNE STREET, LONDON, W10
£670,000 FREEHOLD

**A WELL-PRESENTED, TWO DOUBLE BEDROOM, FREEHOLD
COTTAGE IN THE POPULAR QUEENS PARK AVENUES.**

Kensal Rise & Queens Park | 0208 960 4947 | kensalrise@winkworth.co.uk

Winkworth

winkworth.co.uk

See things differently



LOCATION:

Marne Street is conveniently located for transport links at Queens Park on the Bakerloo and Overground lines and a regular Buses along Kilburn Lane or the No. 18 on Harrow Road to take you to Euston. The amenities of both Chamberlayne Road and Salusbury Road are also only a short walk away, as well as the popular Jaego's House on Harrow Road.





DESCRIPTION:

This two bedroom freehold Cottage is the perfect home for a couple or young family. The ground floor comprises of a double reception and dining room with beautifully restored parquet floors and built in joinery. The garden is paved with a shed and additional storage. The kitchen is separate and could benefit from updating, along with the bathroom. Upstairs, there are two double sized bedrooms, both with built in wardrobes.

Overall, the property is in good order, but can benefit from a new owner to add their own touch to it. There is also potential to extend further (STPP).

Viewing comes highly recommended.



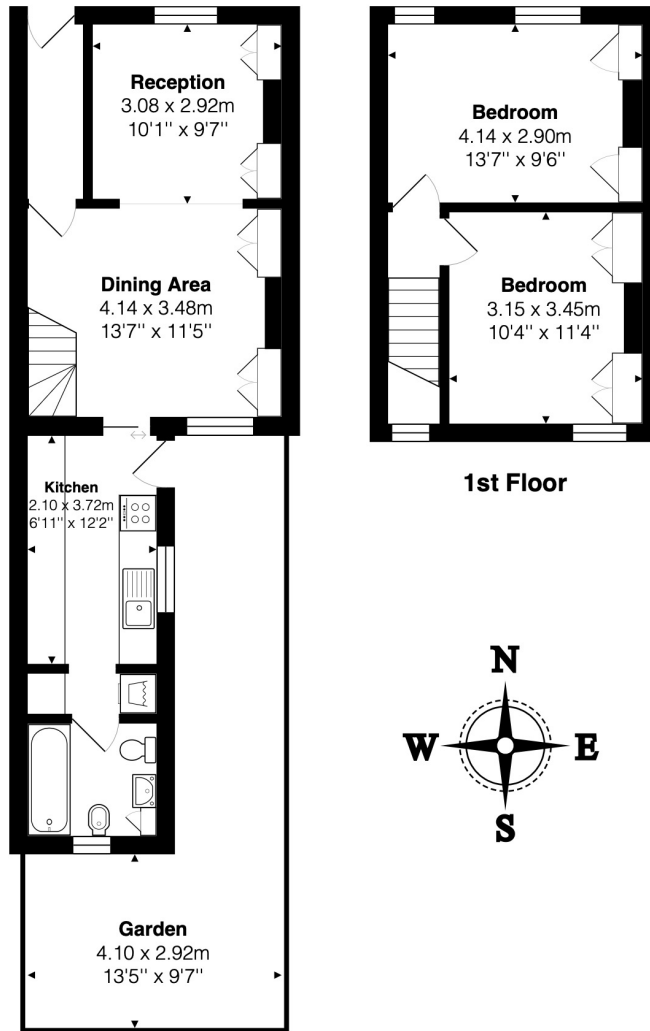

Total Area: 67.8 m² ... 730 ft² (excluding garden)
 All measurements are approximate and for display purposes only

This floorplan is for illustration purposes only and is not to scale. The position and size of doors, windows, appliances and other features are approximate.

Kensal Rise & Queens Park | 0208 960 4947 | kensalrise@winkworth.co.uk



winkworth.co.uk

See things differently

winkworth wishes to inform prospective buyers and tenants that these particulars are a guide and act as information only. All our details are given in good faith and believed to be correct at the time of printing but they don't form part of an offer or contract. No Winkworth employee has authority to make or give any representation or warranty in relation to this property. All fixtures and fittings, whether fitted or not are deemed removable by the vendor unless stated otherwise and room sizes are measured between internal wall surfaces, including furnishings.