



HINDMANS ROAD, EAST DULWICH, SE22
£420,000 SHARE OF FREEHOLD

A BEAUTIFUL ONE-BEDROOM FIRST-FLOOR
FLAT, SITUATED ON A HIGHLY SOUGHT-
AFTER ROAD IN SE22.

Dulwich | 020 8299 2722 | dulwich@winkworth.co.uk

Winkworth

winkworth.co.uk

See things differently



DESCRIPTION:

A beautiful one-bedroom first-floor flat, situated on a highly sought-after road in SE22. Comprising a large living room with high ceilings, a fully fitted open-plan kitchen-diner, a large double bedroom and bathroom. The property is very well situated to benefit from easy access to the hustle and bustle of Lordship Lane with its extensive array of shops, bars and restaurants. Large green, open spaces can be found at Dulwich Park, Peckham Rye Park or Goose Green.

AT A GLANCE

- One Bedroom
- First Floor Flat
- Reception Room
- Open-Plan Kitchen-Diner
- Chain Free
- Great Location



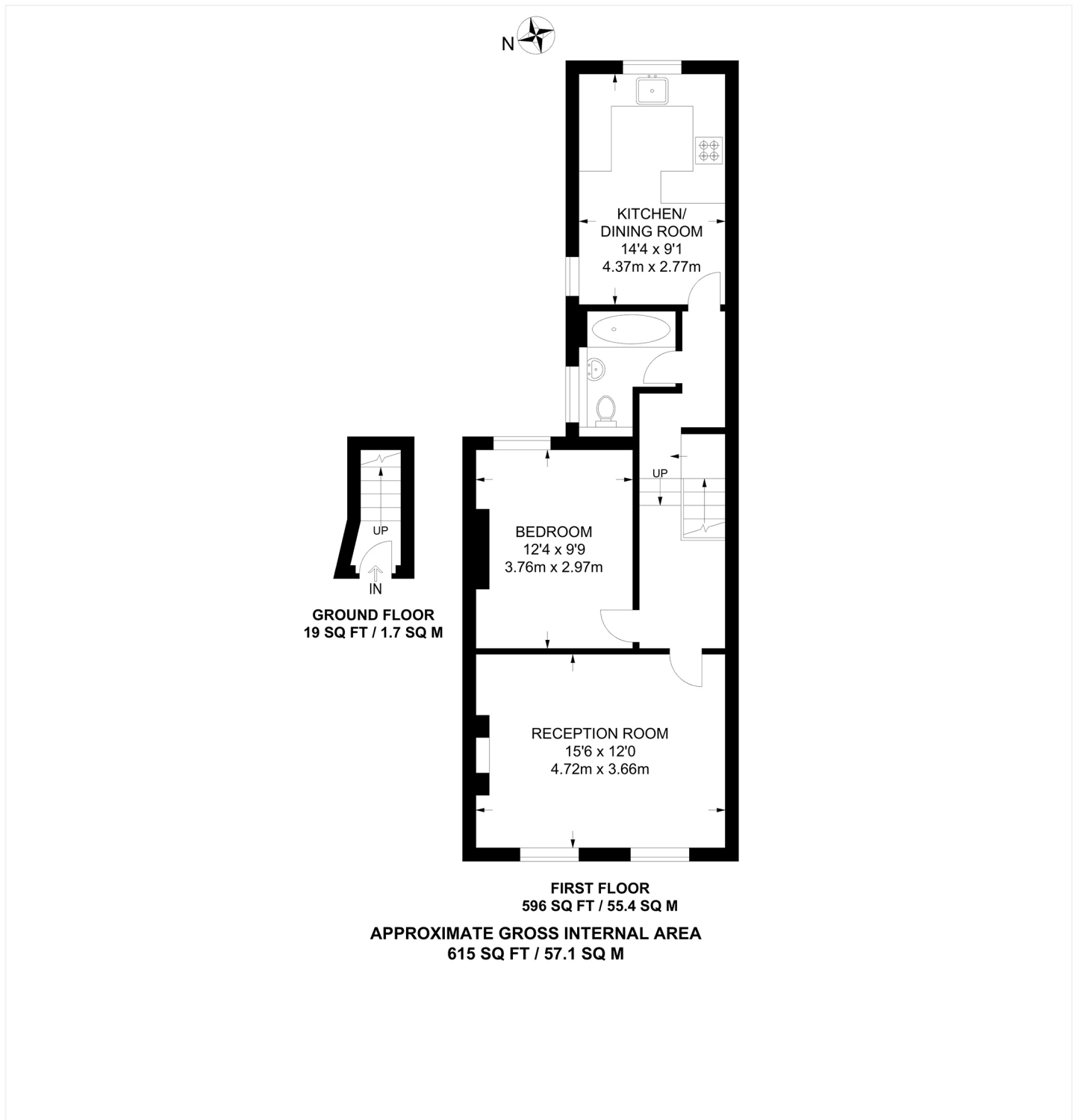

This floorplan is for illustration purposes only and is not to scale. The position and size of doors, windows, appliances and other features are approximate.

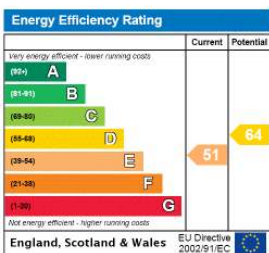

Dulwich | 020 8299 2722 | dulwich@winkworth.co.uk



winkworth.co.uk

See things differently

Winkworth wishes to inform prospective buyers and tenants that these particulars are a guide and act as information only. All our details are given in good faith and believed to be correct at the time of printing but they don't form part of an offer or contract. No Winkworth employee has authority to make or give any representation or warranty in relation to this property. All fixtures and fittings, whether fitted or not are deemed removable by the vendor unless stated otherwise and room sizes are measured between internal wall surfaces, including furnishings.