



CREDENHILL STREET, SW16
£500,000 LEASEHOLD

TWO BEDROOM GROUND FLOOR GARDEN MAISONETTE

Tooting | 020 8767 5221 | tooting@winkworth.co.uk 17 Upper Tooting Road,
London, SW17 7TS

Winkworth

for every step...

winkworth.co.uk



SUMMARY:

Brilliant two bedroom garden maisonette. Offered to the market with no onward chain and long lease. Benefitting from two genuine double bedrooms, open plan kitchen, modern bathroom and private spacious garden.

Tenure: Leasehold 999 yrs from 2013

Service charge: zero

Ground rent: peppercorn

Credenhill Street is situated within the highly acclaimed Furzedown location. A wide range of local amenities can be found within easy reach on Moyser Road and Tooting High Road. Transport links are found a short walk away at Tooting Broadway Underground (Northern Line), Streatham Common (providing access to London Bridge, Victoria and Clapham Junction), and Streatham Overground Station (providing Thames Link services). Numerous bus routes passing at the end of the street.



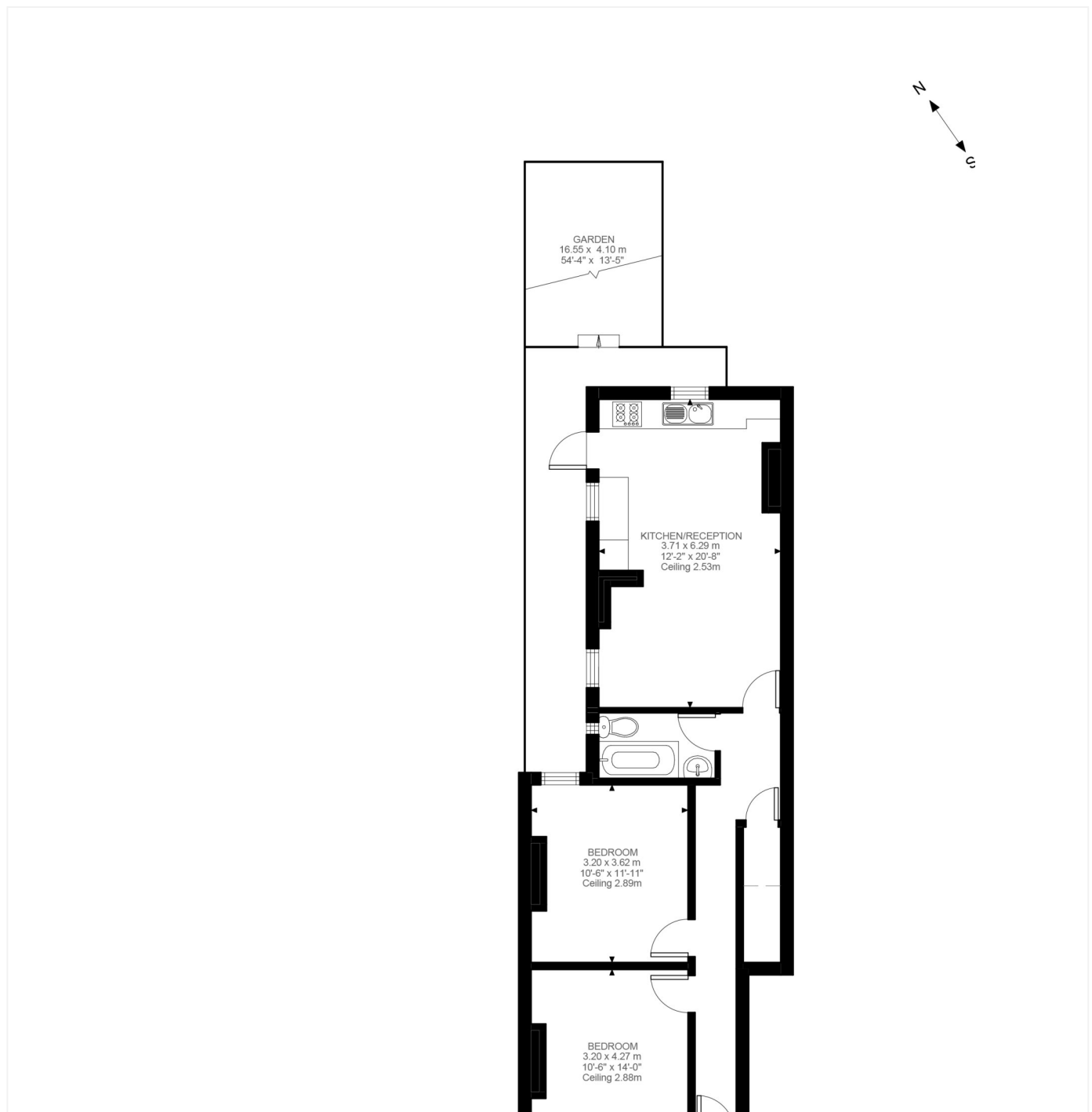

This floorplan is for illustration purposes only and is not to scale. The position and size of doors, windows, appliances and other features are approximate.

Energy Efficiency Rating		
	Current	Potential
Very energy efficient - lower running costs		
A (92-100)		
B (81-91)		
C (69-80)		78
D (55-68)	68	
E (39-54)		
F (21-38)		
G (1-20)		
Not energy efficient - higher running costs		
England, Scotland & Wales EU Directive 2002/91/EC		

Tooting | 020 8767 5221 | tooting@winkworth.co.uk
17 Upper Tooting Road, London, SW17 7TS

Winkworth

for every step...

winkworth.co.uk

Winkworth wishes to inform prospective buyers and tenants that these particulars are a guide and act as information only. All our details are given in good faith and believed to be correct at the time of printing but they don't form part of an offer or contract. No Winkworth employee has authority to make or give any representation or warranty in relation to this property. All fixtures and fittings, whether fitted or not are deemed removable by the vendor unless stated otherwise and room sizes are measured between internal wall surfaces, including furnishings.