

Winchester Way, Sleaford, Lincolnshire

This floorplan is for illustration purposes only and is not to scale. The position and size of doors, windows, appliances and other features are approximate.

Score	Energy rating	Current	Potential
92+	A		
81-91	B		88 B
69-80	C	73 C	
55-68	D		
39-54	E		
21-38	F		
1-20	G		

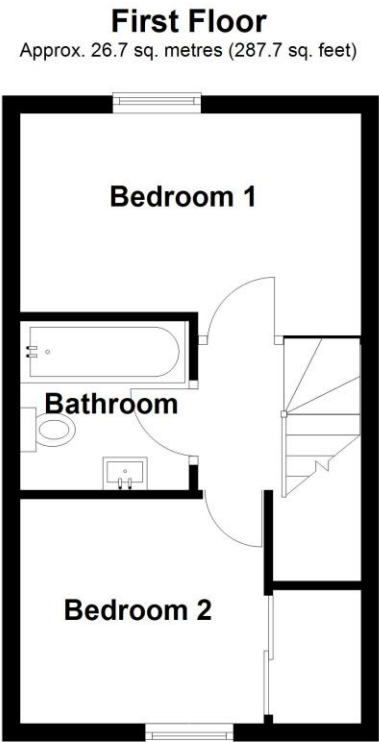
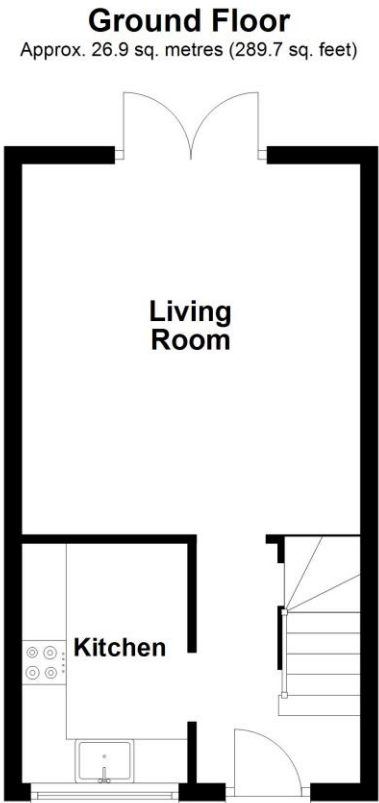

Total area: approx. 53.6 sq. metres (577.4 sq. feet)



87 Winchester Way, Sleaford, Lincolnshire, NG34 8WJ

£157,000 Freehold

This well-presented Two Bedroom home is situated in a highly sought-after location, offering convenient access to local amenities and excellent transport links.

TWO DOUBLE BEDROOMS | MODERN KITCHEN | STYLISH BATHROOM |  
SPACIOUS LOUNGE | PARKING FOR TWO CARS | LOW MAINTENANCE  
GARDEN | SOUGHT AFTER LOCATION | CLOSE TO AMENITIES

Winkworth

Winkworth

See things differently.

See things differently.

Winkworth Sleaford | 01529 303377 | sleaford@winkworth.co.uk

winkworth.co.uk/sleaford

Under the Property Misdescriptions Act 1991 these particulars are a guide and act as information only. All details are given in good faith and are believed to be correct at time of printing. Winkworth give no representation as to their accuracy and potential purchasers or tenants must satisfy themselves or otherwise as to their correctness. No employee of Winkworth has authority to make or give any



DESCRIPTION

Beautifully proportioned and immaculately presented throughout, the property benefits from gas central heating and UPVC double glazing throughout.

The accommodation briefly includes an Entrance Hall, spacious Lounge, a modern Kitchen, Two generously sized bedrooms, and a modern family bathroom with a stylish three-piece suite.

Externally, the property features a gravelled driveway with parking for two vehicles. There is a generous, low-maintenance garden, ideal for family gatherings or entertaining guests.

An early viewing is highly recommended to fully appreciate all this superb home has to offer.

ACCOMMODATION

Entrance Hall

Kitchen - 8'11" x 6'2" (2.72m x 1.88m)

Living Room - 13'9" x 12'8" (4.2m x 3.86m)

Bedroom One - 12'8" x 8'3" (3.86m x 2.51m)

Bedroom Two - 9'1" x 8'4" (2.77m x 2.54m)

Family Bathroom - 6'4" x 6'2" (1.93m x 1.88m)

LOCAL AUTHORITY

North Kesteven District Council

TENURE

Freehold

COUNCIL TAX BAND

A

