



Windsor Court Newbury, RG14 5XF

Two bedroom flat on the popular Windsor Court development.

A ground floor two bedroom apartment located just 0.4 miles from town centre.

The property benefits from a bright and airy sitting room with French open doors to the communal gardens.

This property comes equipped with a spacious double bedroom, one single bedroom, bathroom, kitchen and one parking space.

Superfast broadband available and no known mobile connectivity issues.

EPC: C

West Berkshire Council Tax Band: C



Winkworth

AT A GLANCE

NO ONWARD CHAIN

Two Bedrooms
Family Bathroom
Kitchen
Living Room
Doors to Garden
Great investment opportunity

UTILITIES

Mains Electric
Mains Water
Mains Drainage

LEASEHOLD DETAILS

Approx 99 Years lease remaining
Ground rent: Approx £100 pa
Service charge: Approx £1,932 (24/25)
Lease copy available on request.

DIRECTIONS

What3words:///prices.boring.trail

Windsor Court, Newbury, RG14

Approximate Area = 605 sq ft / 56.2 sq m

For identification only - Not to scale

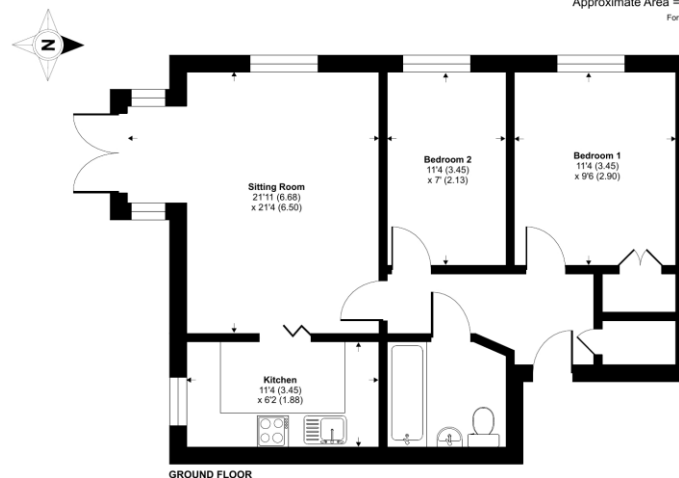

Floor plan produced in accordance with RICS Property Measurement 2nd Edition, incorporating International Property Measurement Standards (IPMS2 Residential). © richcom 2025. Produced for Winkworth. REF: 1303912

Winkworth



Newbury Office

43 Northbrook Street, Newbury, Berkshire RG14 1DT
01635 552552 | newbury@winkworth.co.uk

[winkworth.co.uk/newbury](https://www.winkworth.co.uk/newbury)

Winkworth

See things differently.