



**Steplake House, Steplake Lane, Sherfield English, Romsey, SO51 6FR**  
**Offers In Excess Of - £1,000,000**

**Winkworth**





## STUNNING FAMILY HOME

Steplake House enjoys an extremely private and tucked away position in a rural location on the fringes of the villages of Wellow and Sherfield English. The immediate scenery is stunning offering picturesque walks, cycle rides and horse riding. Such is the privacy of Wellow Wood hamlet that it remains quite unknown to many locals. Within walking distance is the beautiful village green and the popular Hatchet public house along with the post office and active village hall. More extensive amenities are available in the nearby market town of Romsey just a few miles away. There is excellent schooling for children of all ages both in the state and private sector. The commercial cathedral cities of Winchester and Salisbury are within easy commute, along with the commercial centres of Southampton and Bournemouth both with international airports. In addition, there are good motorway and rail links to London and beyond.

Located in Sherfield English, Steplake House offers the charm of a country cottage whilst providing extensive accommodation in the most idyllic of settings. The property is entered through a covered porch area into a large and welcoming entrance hall, from where doors link to the principal downstairs rooms. The ground floor offers generous living accommodation, consisting of a light and airy kitchen/breakfast/family room which is open to the vaulted conservatory with wonderful views over the rear garden. A useful utility room and separate boot room/cloakroom are located just off the kitchen. The four remaining downstairs rooms are currently set up as follows: Triple aspect sitting room, dining room, reception room and bedroom five, some of these rooms could easily be repurposed to provide a play room or home office. Bedroom five benefits from an en-suite shower room. Upstairs the generous landing leads to four further bedrooms, the principal benefitting from an en-suite bathroom with separate shower, and ever-popular dressing area. Bedroom two benefits from an en-suite shower room. Bedrooms three and four have use of a bathroom with separate shower cubicle.

The gardens at Steplake House are simply beautiful, a real oasis of calm and totally secure, perfect for any dog owners. Offering exceptionally private formal gardens enclosed by gated access which leads to a driveway for multiple vehicles. Paved patio areas provide perfect spaces for entertaining whilst providing wonderful views over the garden. The plot extends to approximately 1.56 acres, supplementing the more formal garden is a sizeable orchard planted with mature shrubs and specimen trees.



















# Winkworth

Approximate Area = 2755 sq ft / 258 sq m  
For identification only - Not to scale

**Address:** Steplake House, Steplake Lane, Sherfield English, Romsey, Hampshire, SO51 6FR  
**Council Tax Band:** "F"    **EPC:** "D"  
**Freehold**

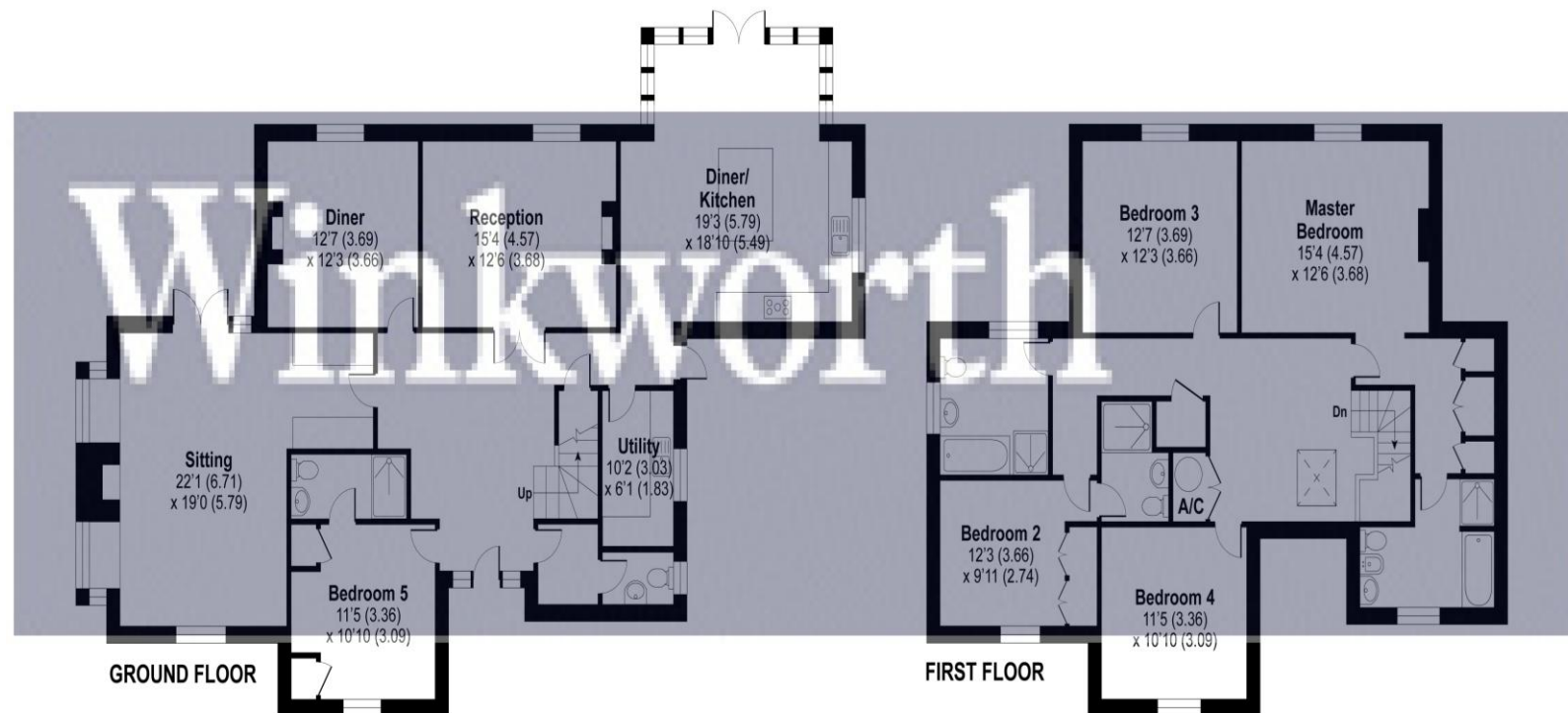

[winkworth.co.uk/romsey](http://winkworth.co.uk/romsey)

## winkworth Romsey

18 Market Place, Romsey, Hampshire, SO51 8NA  
01794 511911 | [romsey@winkworth.co.uk](mailto:romsey@winkworth.co.uk)

[winkworth.co.uk/romsey](http://winkworth.co.uk/romsey)

## winkworth Winchester

2 Black Swan Buildings, Southgate Street,  
Winchester, Hampshire, SO23 9DT  
01962 866777 | [winchester@winkworth.co.uk](mailto:winchester@winkworth.co.uk)

## winkworth Mayfair & Country House Department

11 Berkeley Street, Mayfair, London, W1J 8DS  
020 7871 0589 | [countryhouse@winkworth.co.uk](mailto:countryhouse@winkworth.co.uk)

# Winkworth

See things differently