



Shillingford Close, Mill Hill East, London, NW7

£380,000 *Leasehold*

2  1  2 

A modern, two double bedroom, two bathroom, top floor apartment, situated in one of Mill Hill's most desired developments - and only a 10 minute walking distance to Mill Hill East under ground station, (Northern Line), and Virgin Active / Waitrose shopping.

KEY FEATURES

- Purpose built block
- Top floor
- Two bedrooms
- Two bathrooms
- Spacious reception room
- Parking & Long lease
- Chain free



Finchley

020 8349 3388 | finchley@winkworth.co.uk

Winkworth

for every step...



The property is comprised of one double bedroom with fitted wardrobes, and one large single bedroom with wardrobes, two modern bathrooms (one ensuite), fully fitted kitchen, large living room, door entry system, allocated parking space, second floor, double glazed windows, and gas central heating.

Offered on a chain free basis and with a long lease.





MATERIAL INFO

Tenure: Leasehold
Term: 973 year and 3 months
Service Charge: £ to be confirmed
Ground Rent: £ 300
Council Tax Band: E
EPC rating: C

Shillingford Close, NW7
Approx. Gross Internal Floor Area 654 sq. ft / 60.72 sq. m

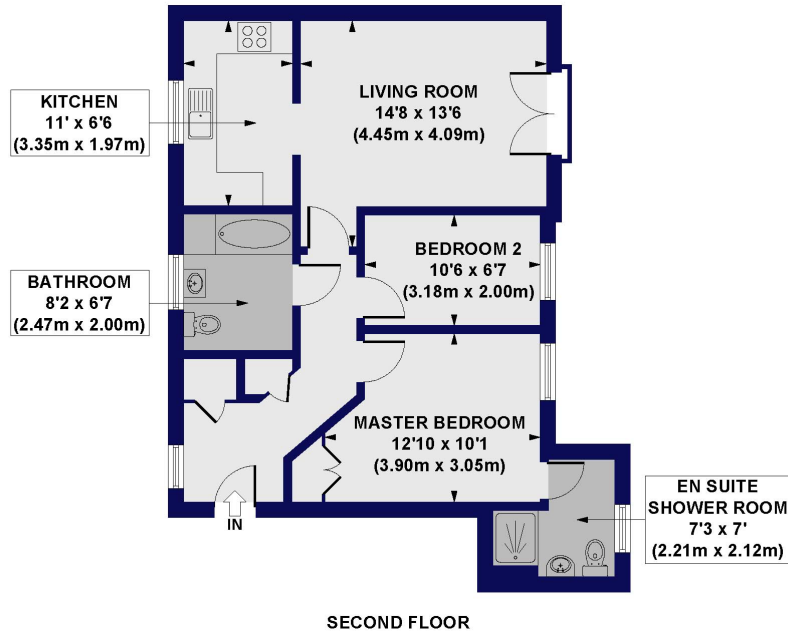

All measurements of walls, doors, windows, fittings and appliances, including their size and location, are shown as standard sizes and do not constitute any warranty or representation by the seller, their agent or CP Creative. Any intending purchaser must satisfy himself by inspection or otherwise as to the correctness of the information contained in these plans. This plan is for illustrative purposes only and should be used as such by any prospective purchasers.

Winkworth

Score	Energy rating	Current	Potential
92+	A		
81-91	B		
69-80	C	79 C	80 C
55-68	D		
39-54	E		
21-38	F		
1-20	G		

For more information, scan the QR code or visit the link below



<https://www.winkworth.co.uk/sale/property/FIN260050>

Where no figures are shown, we have been unable to ascertain the information. All figures that are shown were correct at the time of printing.

Finchley

020 8349 3388 | finchley@winkworth.co.uk

Winkworth

for every step...

Winkworth wishes to inform prospective buyers and tenants that these particulars are a guide and act as information only. All our details are given in good faith and believed to be correct at the time of printing but they don't form part of an offer or contract. No Winkworth employee has authority to make or give any representation or warranty in relation to this property. All fixtures and fittings, whether fitted or not are deemed removable by the vendor unless stated otherwise and room sizes are measured between internal wall surfaces, including furnishings.