



ST. CHARLES SQUARE, W10
£2,100 PER MONTH

Winkworth



ST. CHARLES SQUARE, W10

A bright and spacious, newly refurbished one-bedroom apartment ideally located in the heart of Ladbroke Grove. Set on the first floor of a charming period property, the apartment features a generous reception room, a well-proportioned bedroom with ample storage, large Victorian sash windows, a contemporary modern bathroom finished to a high standard, and a stunning newly fitted kitchen complete with modern appliances.

LOCATION

The property is just a short walk from the vibrant amenities of Portobello Road. Ladbroke Grove, one of North Kensington's most eclectic and multicultural hotspots, offers an exciting mix of independent restaurants, cafés, and antique furniture stores. The renowned Portobello Market and excellent transport links at Ladbroke Grove station are only moments away.





St. Charles Square

Approx. Gross Internal Area 430 Sq Ft - 39.95 Sq M

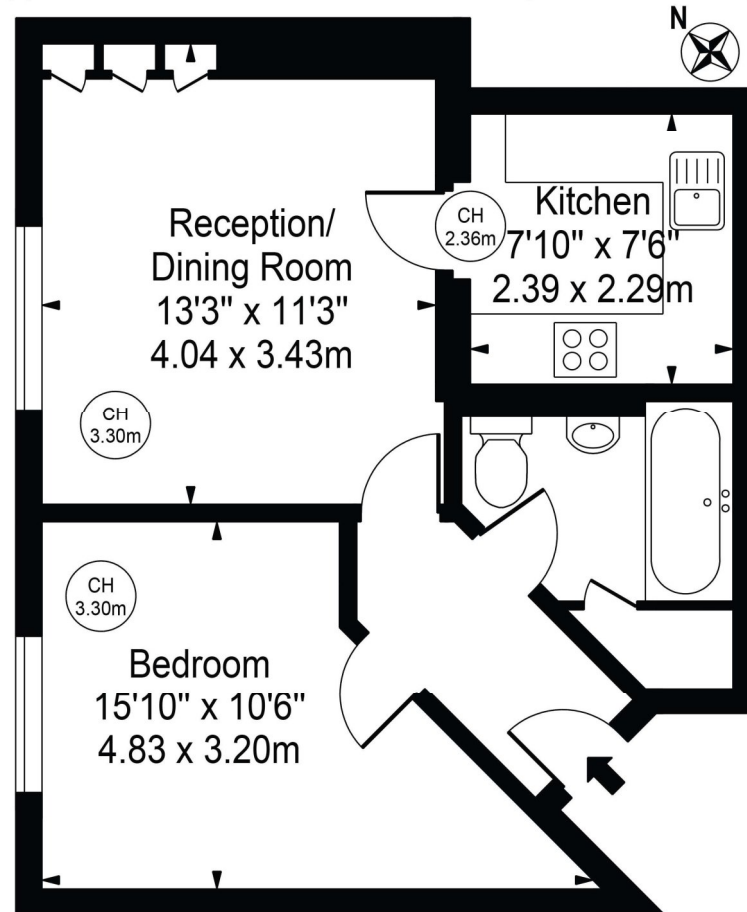

First Floor

For Illustration Purposes Only - Not To Scale

This floor plan should be used as a general outline for guidance only and does not constitute in whole or in part an offer or contract. Any intending purchaser or lessee should satisfy themselves by inspection, searches, enquiries and full survey as to the correctness of each statement. Any areas, measurements or distances quoted are approximate and should not be used to value a property or be the basis of any sale or let.

Copyright Morriarti Photography & Design LTD

| Energy Efficiency Rating | | Current | Potential |
|---|---|-------------------------|-----------|
| Very energy efficient - lower running costs | | | |
| (92-100) | A | | |
| (81-91) | B | | |
| (69-80) | C | | |
| (55-68) | D | | |
| (39-54) | E | 60 | 73 |
| (21-38) | F | | |
| (1-20) | G | | |
| Not energy efficient - higher running costs | | | |
| England, Scotland & Wales | | EU Directive 2002/91/EC | |

North Kensington | 020 7792 5000 | northkensington@winkworth.co.uk

winkworth.co.uk

Winkworth wishes to inform prospective buyers and tenants that these particulars are a guide and act as information only. All our details are given in good faith and believed to be correct at the time of printing but they don't form part of an offer or contract. No Winkworth employee has authority to make or give any representation or warranty in relation to this property. All fixtures and fittings, whether fitted or not are deemed removable by the vendor unless stated otherwise and room sizes are measured between internal wall surfaces, including furnishings.

Winkworth