



Deacons Hill Road, Borehamwood, Hertfordshire, WD6

£320,000 *Leasehold*



Two Double Bedroom First Floor Flat With Balcony in Elstree

KEY FEATURES

- Two Double Bedrooms
- Chain Free
- Westerly Facing Balcony
- Residents Parking
- 989 Year Lease
- Gas Central Heating



Borehamwood

020 8953 8899 | borehamwood@winkworth.co.uk



Winkworth

Located at the beginning of the highly sought after Deacons Hill Road, within walking distance of the Thameslink station and Borehamwood high street is this two double bedroom first floor purpose built flat.

The property offers approaching 700 square feet of bright and well-proportioned accommodation and would be ideal for downsizers, first time buyers or buy to let investors alike.



Winkworth



Winkworth



Winkworth



MATERIAL INFO

Tenure: Leasehold
Term: 988 year and 4 months
Service Charge: £2328.44 per annum
Ground Rent: £ 0 Annually (subject to increase)
Council Tax Band: D
EPC rating: C

Approximate Gross Internal Area = 63.4 sq m / 682 sq ft

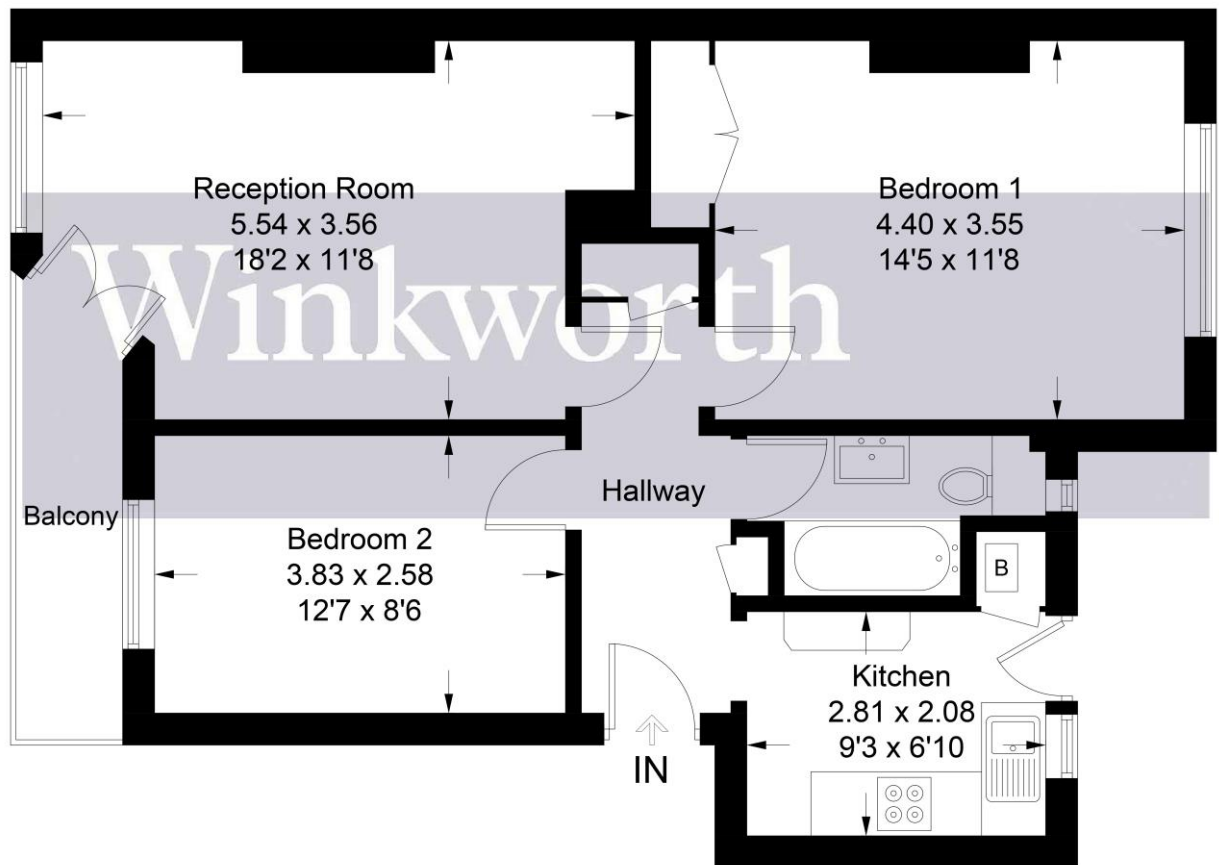
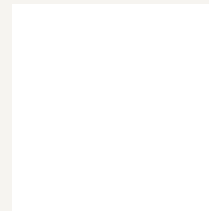

Illustration for identification purposes only, measurements are approximate, not to scale. Winkworth © 2024 (ID1105927)

Energy Efficiency Rating		
	Current	Potential
Very energy efficient - lower running costs		
(92+) A		
(81-91) B		81
(69-80) C	69	
(55-68) D		
(39-54) E		
(21-38) F		
(1-20) G		
Not energy efficient - higher running costs		
England, Scotland & Wales	EU Directive 2002/91/EC	

For more information, scan the QR code or visit the link below



<https://www.winkworth.co.uk/sale/property/BOR240237>

Where no figures are shown, we have been unable to ascertain the information. All figures that are shown were correct at the time of printing.

Borehamwood

020 8953 8899 | borehamwood@winkworth.co.uk