

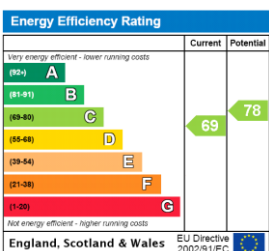

CRICKLEWOOD LANE, LONDON, NW2
£275,000 LEASEHOLD

A bright and conveniently located 1 bedroom conversion



1 bedroom/ 1 Bathroom/ Open Plan Kitchen/Living Room/
 Long Lease/ Low Outgoings/ Chain Free/ EPC Rating: C

DESCRIPTION:

A 1 bedroom flat with open plan kitchen and living room located on the second (top) floor of this period semi-detached house located on Cricklewood Lane close to the junction with Greenfield Gardens. Access to Golders Green, Brent X and the Thameslink at Cricklewood are within close proximity.

The flat is currently let with vacant possession from mid-February 2022 and would be most suitable for either a first time buyer or as a rental investment.

SC: TBC

Lease: 999 Years from 29/09/83

Cricklewood Lane, NW2
Approx. Gross Internal Floor Area 408 sq. ft / 37.93 sq. m

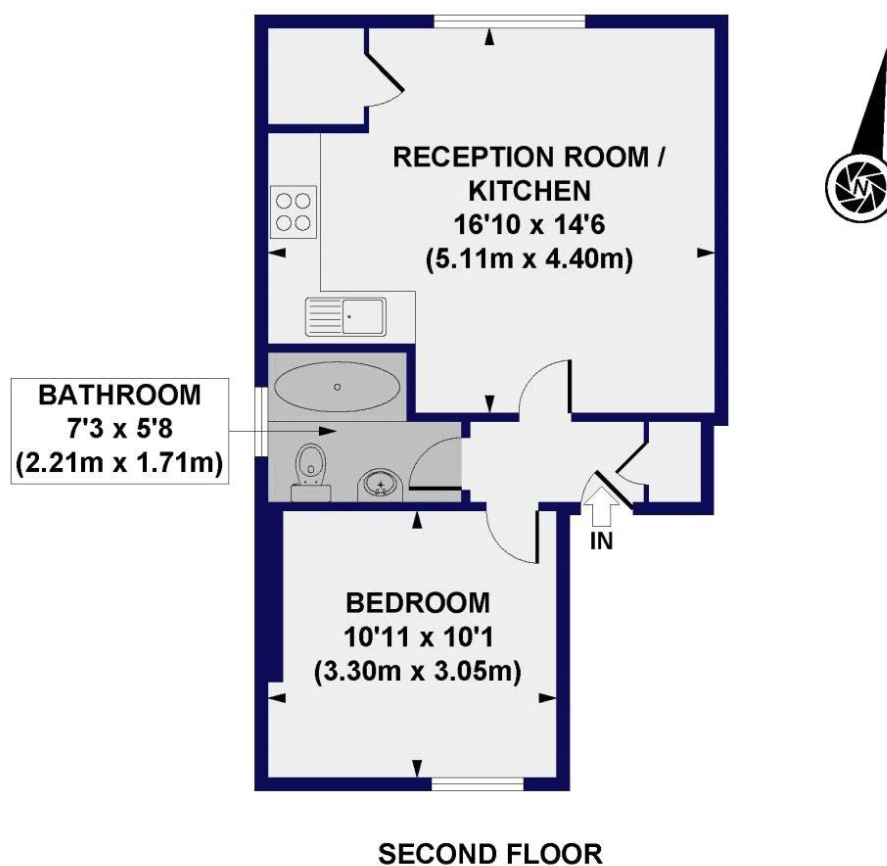

All measurements of walls, doors, windows, fittings and appliances, including their size and location, are shown as standard sizes and do not constitute any warranty or representation by the seller, their agent or CP Creative. Any intending purchaser must satisfy himself by inspection or otherwise as to the correctness of the information contained in these plans.