



**DEANSCROFT AVENUE, NW9**

**£500,000 FREEHOLD**

**DESCRIPTION:** This three bedroom semi-detached house of 1930s property is a perfect blank canvas for growing family looking for a property to put their personal mark on and create their forever home, or suited equally well for a developer or buy to let investor seeking a refurbishment opportunity. This property currently comprises of two reception rooms, a kitchen, three spacious bedrooms, a family bathroom, off street parking, a garage, and a generous rear garden. Plotted just off of ever-loved Salmon Street, and within close proximity to the landmarks of Wembley and heart of Kingsbury with great transport links via Kingsbury Station (Jubilee Line) and Wembley Park Station (Metropolitan and Jubilee Line) to the city centre. Also within walking distance are a variety of amenities, reputable schools including Lycée International de Londres, and St Robert Southwell Primary as well as places of worship. An internal viewing is advised to be able to appreciate the location and potential this home has to offer.

**Kingsbury** | 020 8204 0000 | [kingsbury@winkworth.co.uk](mailto:kingsbury@winkworth.co.uk)

**Winkworth**

for every step...

[winkworth.co.uk](http://winkworth.co.uk)

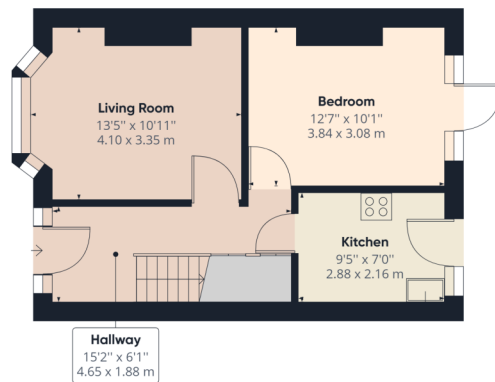

Ground Floor

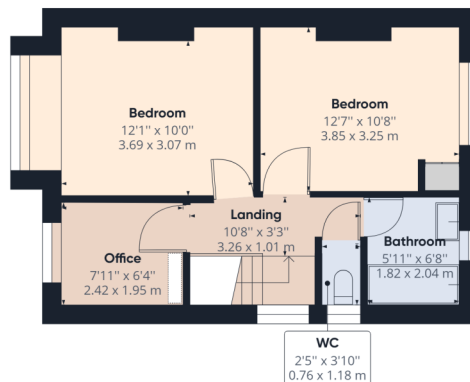

Floor 1

Winkworth

**Approximate total area<sup>(1)</sup>**  
850.68 ft<sup>2</sup>  
79.03 m<sup>2</sup>

(1) Excluding balconies and terraces

While every attempt has been made to ensure accuracy, all measurements are approximate, not to scale. This floor plan is for illustrative purposes only.

GIRAFFE360

This floorplan is for illustration purposes only and is not to scale. The position and size of doors, windows, appliances and other features are approximate.

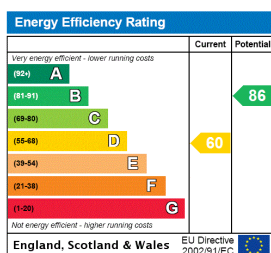

Kingsbury | 020 8204 0000 | kingsbury@winkworth.co.uk

Winkworth

for every step...

winkworth.co.uk

winkworth wishes to inform prospective buyers and tenants that these particulars are a guide and act as information only. All our details are given in good faith and believed to be correct at the time of printing but they don't form part of an offer or contract. No winkworth employee has authority to make or give any representation or warranty in relation to this property. All fixtures and fittings, whether fitted or not are deemed removable by the vendor unless stated otherwise and room sizes are measured between internal wall surfaces, including furnishings.