



PITSHANGER LANE, LONDON, W5
£450,000 LEASEHOLD

COUNCIL TAX BAND: C
EPC: E

Ealing & Acton | 0208 896 0123 | ealing@winkworth.co.uk

Winkworth

for every step...

winkworth.co.uk



DESCRIPTION:

Spacious split-level apartment which is located in the heart of Pitshanger Village. The maisonette offers over 660 sq ft of accommodation, with the kitchen and a guest cloakroom on the ground floor and two double bedrooms, living room, shower room and a separate toilet upstairs. The property further benefits from its own private entrance, period features and an outdoor patio area. Situated on the popular Pitshanger Lane, the property is just moments away from a variety of local amenities as well as the open green spaces of Pitshanger Park and Cleveland Park.



Winkworth

for every step...



Winkworth

for every step...

Pitshanger, W5 1QY

Approx Gross Internal Area = 61.9 sq m / 666 sq ft

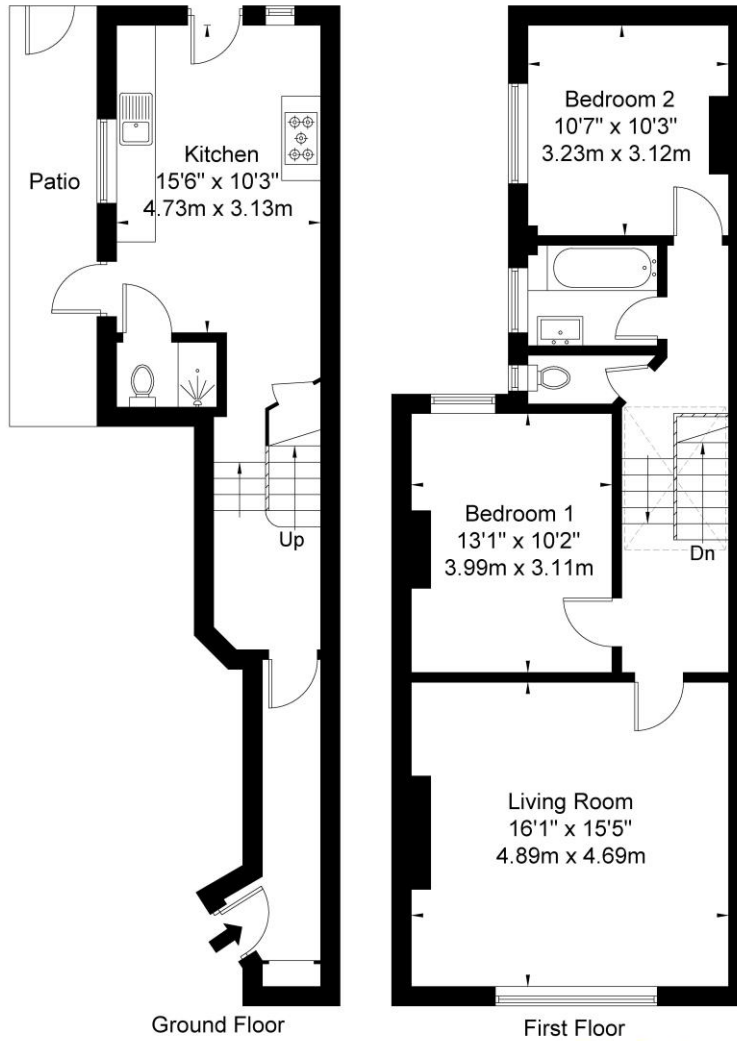

Ref

Copyright **BLEU PLAN**

The Floor plan is not to scale and measurements and areas shown are approximate and therefore should be used for illustrative purposes only. The plan has been prepared in accordance with the RICS code of Measuring Practice and whilst we have confidence in the information produced it must not be relied on. If there is any aspect of particular importance, you should carry out or commission your own inspection of the property.

Copyright @ BLEUPLAN

This floorplan is for illustration purposes only and is not to scale. The position and size of doors, windows, appliances and other features are approximate.

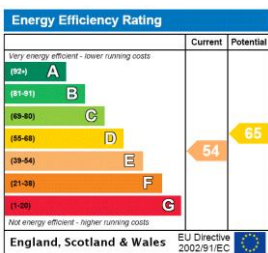

Ealing & Acton | 0208 896 0123 | ealing@winkworth.co.uk



for every step...

winkworth.co.uk

Winkworth wishes to inform prospective buyers and tenants that these particulars are a guide and act as information only. All our details are given in good faith and believed to be correct at the time of printing but they don't form part of an offer or contract. No Winkworth employee has authority to make or give any representation or warranty in relation to this property. All fixtures and fittings, whether fitted or not are deemed removable by the vendor unless stated otherwise and room sizes are measured between internal wall surfaces, including furnishings.