



DAYWORTH MEWS, READING, BERKSHIRE, RG30 2RR
£1,200 PER MONTH FURNISHED

MODERN TWO DOUBLE BEDROOM FIRST FLOOR APARTMENT LOCATED TO THE WEST OF READING TOWN CENTRE

Reading | 0118 4022 300 | reading@winkworth.co.uk

Winkworth

for every step...

winkworth.co.uk



DESCRIPTION:

Modern two double bedroom first floor apartment located to the west of Reading town centre. The property comprises of living room, separate kitchen, two double bedrooms and a three piece bathroom. Benefits include allocated parking space and a large storage cupboard. Available 6th September 2025. Furnished.

AT A GLANCE

- Two double bedrooms
- First floor apartment
- Separate Kitchen
- Council tax band C
- Allocated parking space
- Available 6th September
- Furnished



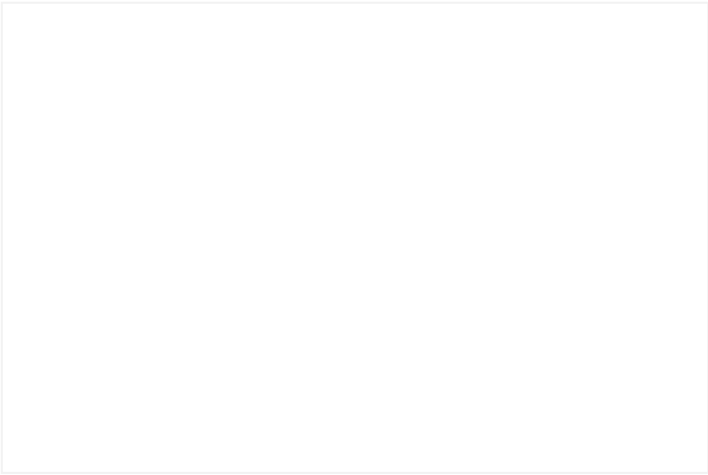

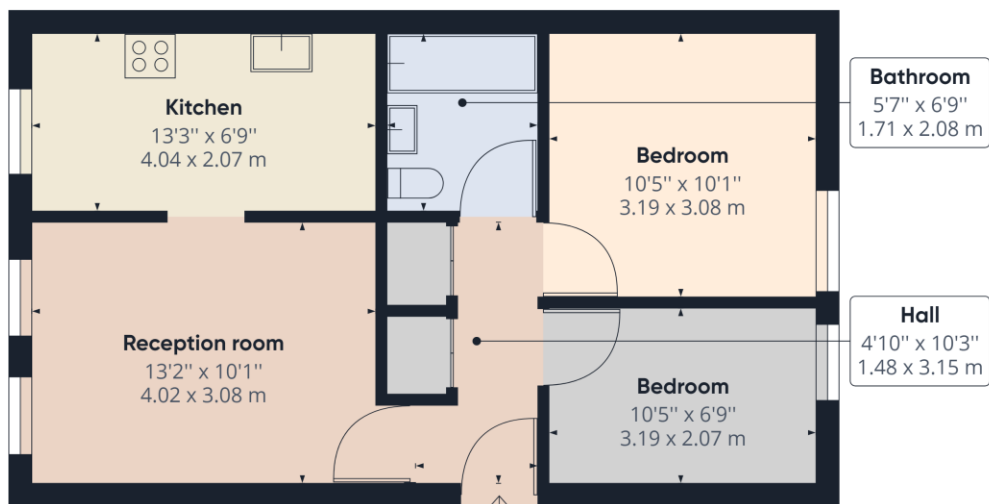

Approximate total area⁽¹⁾
514.33 ft²
47.78 m²

(1) Excluding balconies and terraces

While every attempt has been made to ensure accuracy, all measurements are approximate, not to scale. This floor plan is for illustrative purposes only.

GIRAFFE 360

This floorplan is for illustration purposes only and is not to scale. The position and size of doors, windows, appliances and other features are approximate.

Deposit: £1,384.62

Holding Deposit: £276.92

Council Tax Band: C

Where no figures are shown, we have been unable to ascertain the information. All figures that are shown were correct at the time of printing.

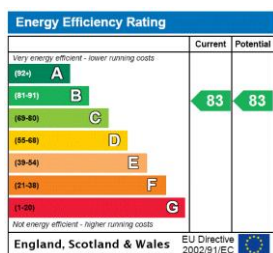

Reading | 0118 4022 300 | reading@winkworth.co.uk

Winkworth

for every step...

winkworth.co.uk

Winkworth wishes to inform prospective buyers and tenants that these particulars are a guide and act as information only. All our details are given in good faith and believed to be correct at the time of printing but they don't form part of an offer or contract. No Winkworth employee has authority to make or give any representation or warranty in relation to this property. All fixtures and fittings, whether fitted or not are deemed removable by the vendor unless stated otherwise and room sizes are measured between internal wall surfaces, including furnishings.