



**6 Plaza Mews, Winchester Road, Romsey, Hampshire, SO51 8JA**

**Winkworth**



## WONDERFUL TWO BEDROOM HOME IN ROMSEY

This lovely property is situated in a lovely location within easy walking distance of Romsey Town Centre. Romsey is a market town steeped in history, and provides an excellent range of leisure facilities and shops for everyday needs. Schools for all ages, both state and private, are readily available. There is easy access to the M27 and M3 motorways, serving the major centres of Southampton, Winchester and Bournemouth. In addition, there is an excellent local bus service and a train station within a pleasant 5 minute walk over the canal path linking with mainline services to London at Southampton. The New Forest National Park is within 6 miles of Romsey.

6 Plaza Mews is a beautifully presented, modern two-bedroom end of terrace property situated in a great location. The property has been fully updated throughout by the current owner in the past eight years. The porchway into the property leads you to the sitting room to the front elevation of the property. The fully fitted kitchen is equipped with a wide range of eye and base level units and a fitted breakfast bar. To the rear elevation is a light filled conservatory perfect for dining in. A W.C completes the ground floor. To the first floor are two good size double bedrooms, both comprising of built in wardrobes. Both bedrooms have use of the modern walk-in shower room.

There is allocated off road parking for two vehicles, both to the side of the property. The low maintenance garden to the rear is fully enclosed with an array of ornamental shrubs, complete with a raised flower bed. A perfect place to catch the sun and unwind in. The back garden is accessible via a gate.

- Ultrafast broadband available
- EPC Rating - C
- All mains utilities



# Winkworth

**Address: 6 Plaza Mews, Winchester Road, Romsey SO51 8JA**

**Council Tax Band: C**

**EPC: D**

**Tenure: Freehold**

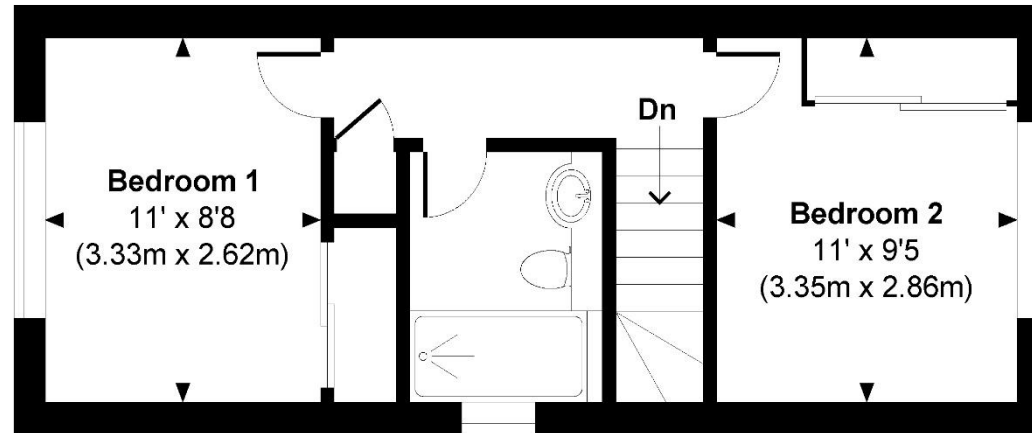

**Plaza Mews**  
Approximate Gross Internal Area  
Total = 768 Sq Ft / 71.39 Sq M

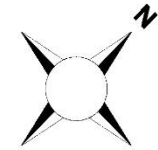

**FIRST FLOOR**

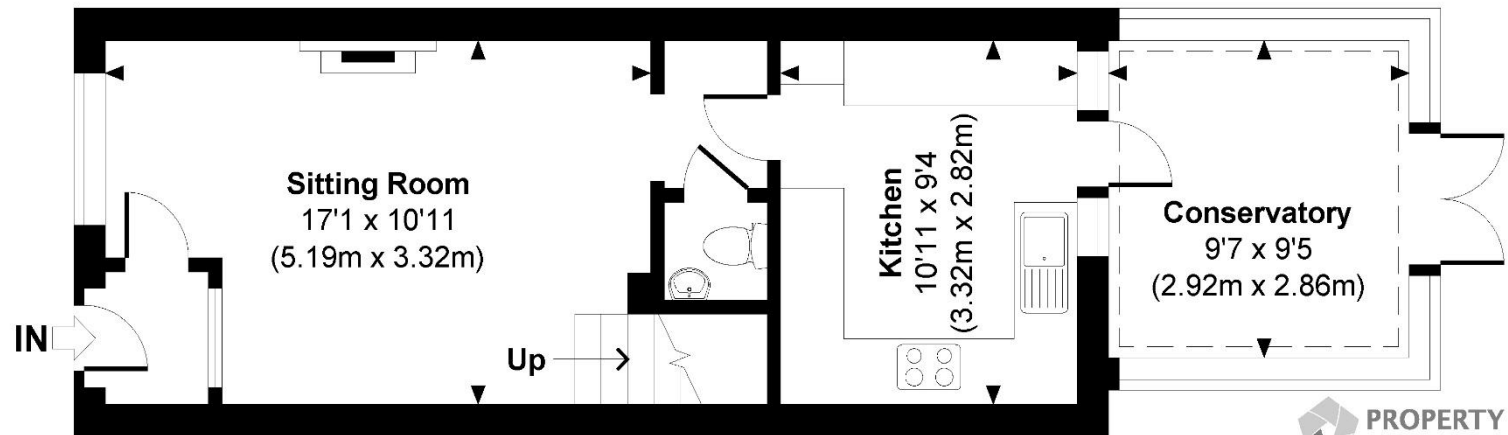

**GROUND FLOOR**

© www.propertyfocus.co | Professional Property Photography & Floorplans

This plan is for illustrative purposes only and is not to scale. If specified, the Gross Internal Area (GIA), dimensions, North point orientation and the size and placement of features are approximate and should not be relied on as a statement of fact. No guarantee is given for the GIA and no responsibility is taken for any error, omission or misrepresentation.

[winkworth.co.uk/romsey](http://winkworth.co.uk/romsey)

## Winkworth Romsey

18 Market Place, Romsey, Hampshire, SO51 8NA  
01794 511911 | [romsey@winkworth.co.uk](mailto:romsey@winkworth.co.uk)

[winkworth.co.uk/romsey](http://winkworth.co.uk/romsey)

## Winkworth Winchester

2 Black Swan Buildings, Southgate Street,  
Winchester, Hampshire, SO23 9DT  
01962 866777 | [winchester@winkworth.co.uk](mailto:winchester@winkworth.co.uk)

## Winkworth Mayfair & Country House Department

11 Berkeley Street, Mayfair, London, W1J 8DS  
020 7871 0589 | [countryhouse@winkworth.co.uk](mailto:countryhouse@winkworth.co.uk)

# Winkworth

See things differently