



MOUNT PLEASANT ROAD, N17
£400,000 SHARE OF FREEHOLD

DESCRIPTION:

Tucked down a quiet street in South Tottenham, this charming one/two bedroom ground floor, bay fronted Victorian conversion has original features and a larger than average back garden. Chain-Free

Harringay | 020 8800 5151 | harringay@winkworth.co.uk



for every step...

winkworth.co.uk

Ground Floor

Approx. 63.4 sq. metres (682.3 sq. feet)

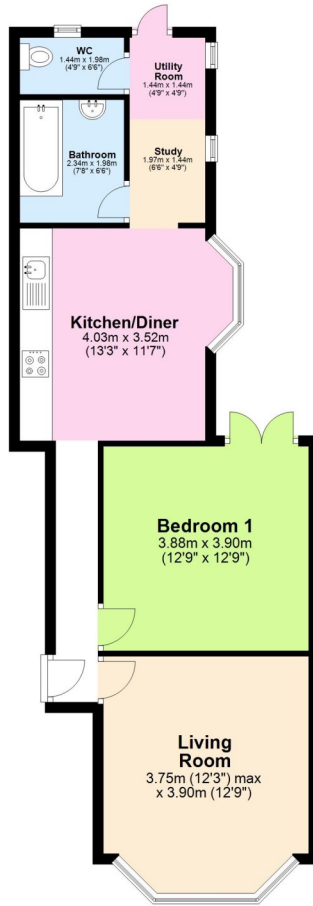

Total area: approx. 63.4 sq. metres (682.3 sq. feet)

This floorplan is for illustration purposes only and is not to scale. The position and size of doors, windows, appliances and other features are approximate.

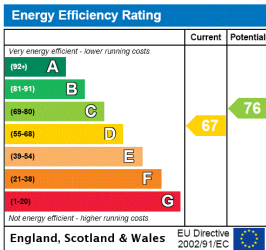

Harringay | 020 8800 5151 | harringay@winkworth.co.uk



for every step...

winkworth.co.uk

winkworth wishes to inform prospective buyers and tenants that these particulars are a guide and act as information only. All our details are given in good faith and believed to be correct at the time of printing but they don't form part of an offer or contract. No winkworth employee has authority to make or give any representation or warranty in relation to this property. All fixtures and fittings, whether fitted or not are deemed removable by the vendor unless stated otherwise and room sizes are measured between internal wall surfaces, including furnishings.