



CAVERSHAM PLACE, READING, BERKSHIRE, RG1 8BY  
**£1,600 PER MONTH FURNISHED**

## MODERN SECOND FLOOR TWO BEDROOM APARTMENT CLOSE TO READING TRAIN STATION.

Reading | 0118 4022 300 | [reading@winkworth.co.uk](mailto:reading@winkworth.co.uk)

**Winkworth**

for every step...

[winkworth.co.uk](http://winkworth.co.uk)





## DESCRIPTION:

Two bedroom apartment located on the second floor (with lift access) within a popular development close to Reading train station and the town centre. The property comprises living room, separate kitchen, three piece family bathroom, two double bedrooms with the master benefitting from an en suite. Further benefits include an allocated off road parking space and security entry phone system. Available 4th May 2024. Furnished.

## AT A GLANCE

- Two bedroom apartment
- Close to Reading town centre
- Two bathrooms
- Council tax band C
- Off road parking space
- Available 4th May
- Furnished



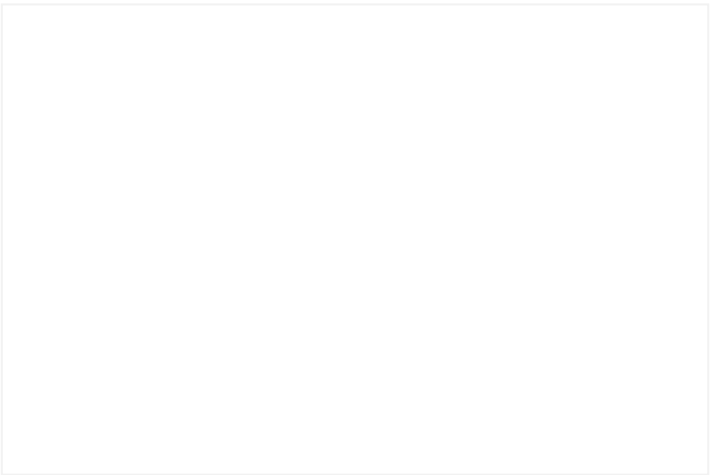

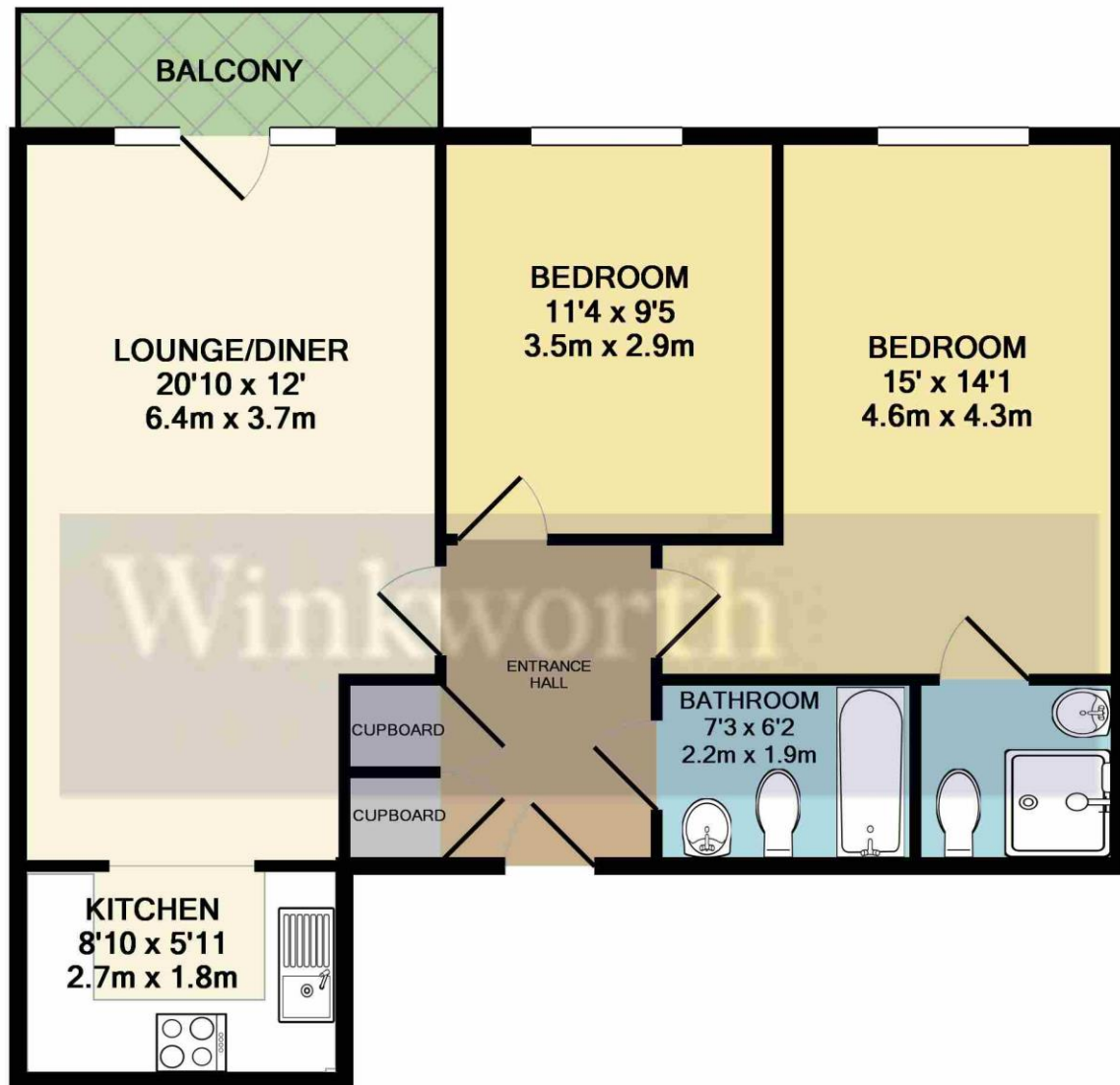

TOTAL APPROX. FLOOR AREA 668 SQ.FT. (62.0 SQ.M.)

Whilst every attempt has been made to ensure the accuracy of the floor plan contained here, measurements of doors, windows, rooms and any other items are approximate and no responsibility is taken for any error, omission, or mis-statement. This plan is for illustrative purposes only and should be used as such by any prospective purchaser. The services, systems and appliances shown have not been tested and no guarantee as to their operability or efficiency can be given

Made with Metropix ©2019

This floorplan is for illustration purposes only and is not to scale. The position and size of doors, windows, appliances and other features are approximate.

**Deposit: £1,846.15**

**Council Tax Band: C**

Where no figures are shown, we have been unable to ascertain the information. All figures that are shown were correct at the time of printing.

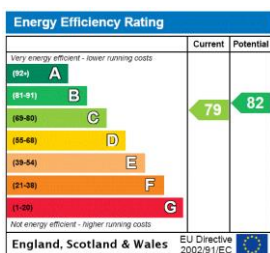

Reading | 0118 4022 300 | [reading@winkworth.co.uk](mailto:reading@winkworth.co.uk)

**Winkworth**

for every step...

[winkworth.co.uk](http://winkworth.co.uk)

Winkworth wishes to inform prospective buyers and tenants that these particulars are a guide and act as information only. All our details are given in good faith and believed to be correct at the time of printing but they don't form part of an offer or contract. No Winkworth employee has authority to make or give any representation or warranty in relation to this property. All fixtures and fittings, whether fitted or not are deemed removable by the vendor unless stated otherwise and room sizes are measured between internal wall surfaces, including furnishings.