



SPEZIA ROAD, NW10

**£3,750 PER MONTH UNFURNISHED**

## THREE BEDROOM FAMILY HOME FULL OF CHARACTER AND CHARM.

Kensal Rise & Queens Park | 0208 960 4947 | [kensalrise@winkworth.co.uk](mailto:kensalrise@winkworth.co.uk)

**Winkworth**

for every step...

[winkworth.co.uk](http://winkworth.co.uk)





### DESCRIPTION:

New to the lettings market this three bedroom family home comprises of double bedrooms and a family bathroom on the first floor. The ground floor offers many period features with a double reception room to the front and a rear open-plan kitchen diner leading to a private south west facing garden.

Additional features include a downstairs cloakroom, an abundance of storage throughout and is offered unfurnished.

- Three Double Bedrooms
- Rear Eat-In Kitchen / Diner
- Private South West Facing Garden
- Original Features
- Family Bathroom
- Close To Willesden Junction Station



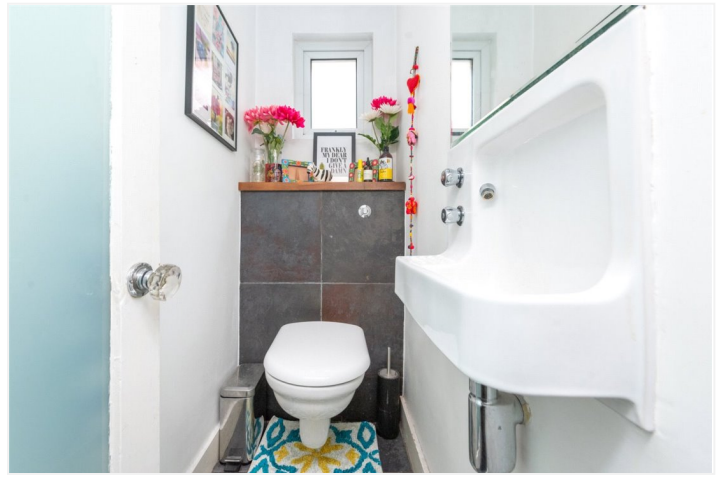



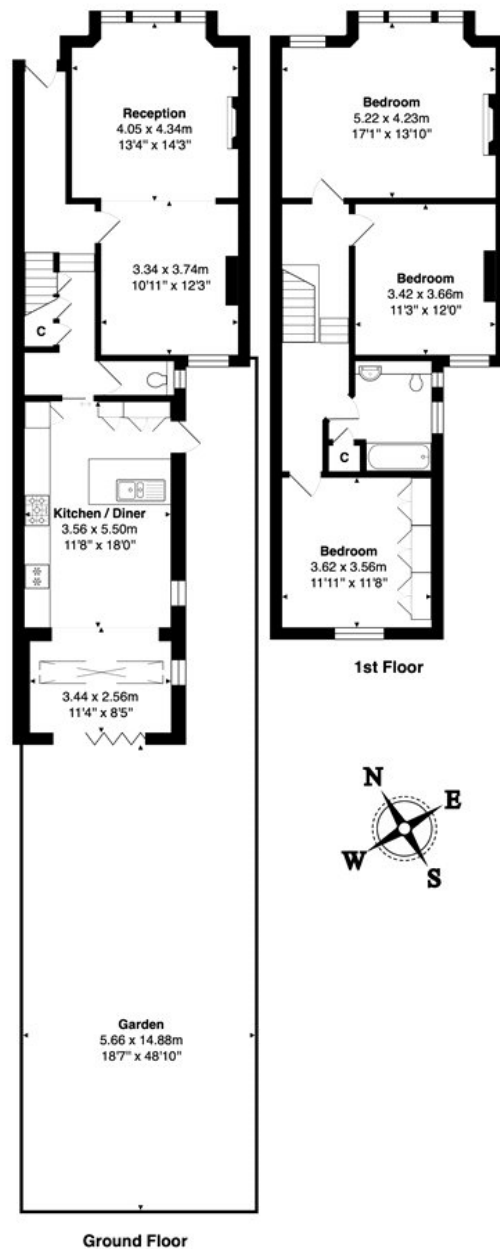

Total Area: 137.2 m<sup>2</sup> ... 1476 ft<sup>2</sup> (excluding garden)

All measurements are approximate and for display purposes only

This floorplan is for illustration purposes only and is not to scale. The position and size of doors, windows, appliances and other features are approximate.

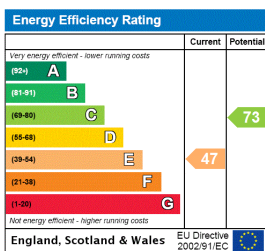

**Deposit:** 5 weeks rent

**Holding Deposit:** 1 weeks rent

**Council Tax Band:** E

Where no figures are shown, we have been unable to ascertain the information. All figures that are shown were correct at the time of printing.

**Winkworth**

Kensal Rise & Queens Park | 0208 960 4947 | kensalrise@winkworth.co.uk

for every step...

winkworth.co.uk

Winkworth wishes to inform prospective buyers and tenants that these particulars are a guide and act as information only. All our details are given in good faith and believed to be correct at the time of printing but they don't form part of an offer or contract. No Winkworth employee has authority to make or give any representation or warranty in relation to this property. All fixtures and fittings, whether fitted or not are deemed removable by the vendor unless stated otherwise and room sizes are measured between internal wall surfaces, including furnishings.