



GOLDERSLEA, LONDON, NW11
£550,000 SHARE OF FREEHOLD

**Generously sized 2 bedroom apartment,
located on the third floor of a sought-after
purpose built-block.**

**2 Bedrooms/ Reception Room/ Bathroom/ Balcony/
Communal Garden/ EPC Rating: D/ Council Tax Band: E**



DESCRIPTION:

We are pleased to present this generously sized two-bedroom apartment, located on the third floor of a sought-after purpose-built block, just a short walk from Golders Green Station (Northern Line).

Spanning 824 square feet, this well-appointed apartment features a spacious living room with direct access to a private balcony, two comfortable double bedrooms, a modern family bathroom, and a well-equipped separate kitchen.

Additional benefits include a private garage. Golderslea is ideally situated on Finchley Road, offering convenient access to the wide array of local amenities in Golders Green and its surrounding areas.

The property benefits from a share in the freehold and is chain-free.

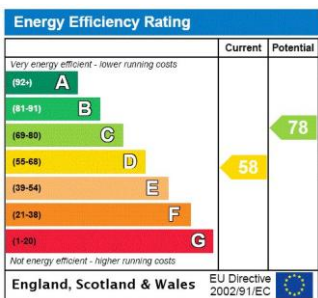



Golderslea, Finchley Road, London NW11 7SA

Third Floor
GROSS INTERNAL FLOOR AREA
APPROX. 77.16 SQ M / 831 SQ FT

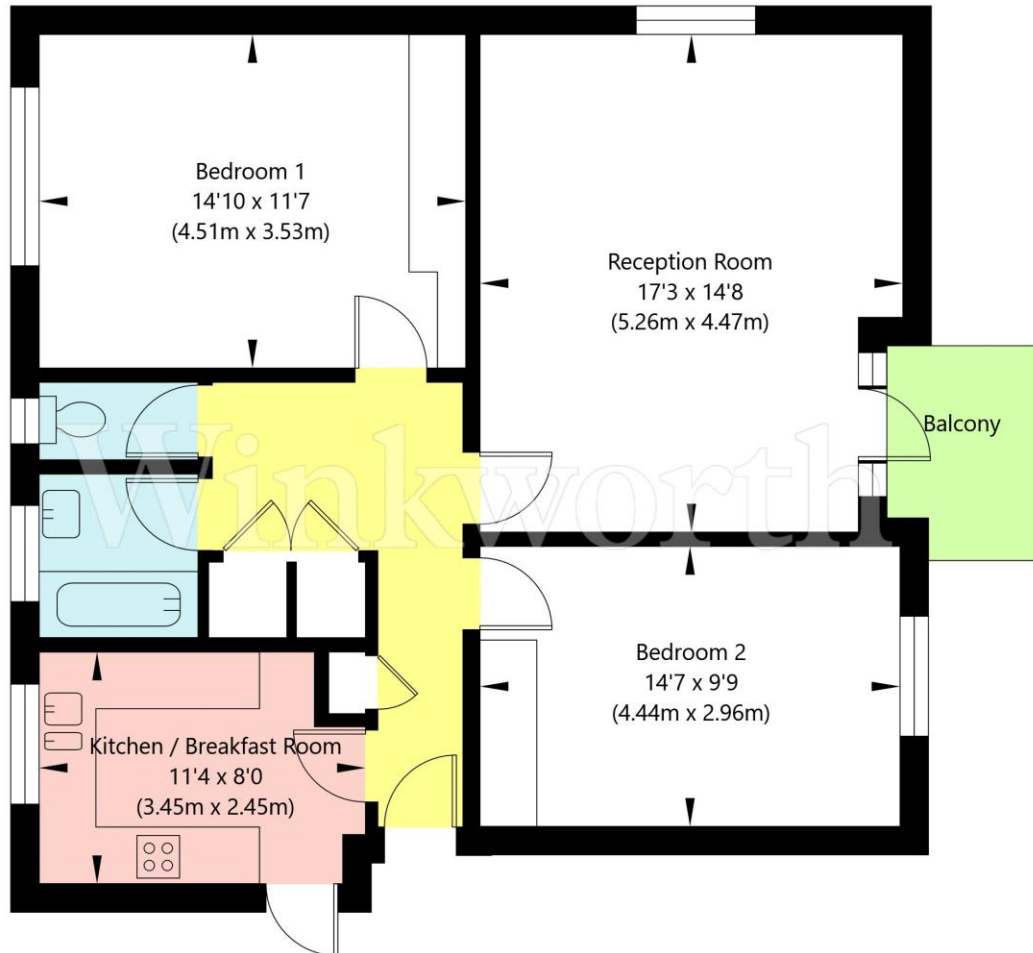

APPROXIMATE GROSS INTERNAL FLOOR AREA 77.16 SQ M / 831 SQ FT
THIS FLOOR PLAN IS FOR ILLUSTRATIVE PURPOSES ONLY AND
SHOULD BE USED FOR THIS PURPOSE BY PROSPECTIVE APPLICANTS AS ITS NOT TO SCALE.

(c) AMBERSHORE PIX LIMITED / PHOTO - VIDEO - FLOOR PLANS / 0800 999 1577 / WWW.AMBERSHOREPIX.CO.UK