



ASHBY GROVE, ISLINGTON, LONDON, N1  
**£399,950 LEASEHOLD**

## A BRIGHT ONE BEDROOM APARTMENT WITH SOUTH FACING BALCONY 0.7 MILES TO Highbury & Islington Station

Islington | 0207 354 2480 | [islington@winkworth.co.uk](mailto:islington@winkworth.co.uk)

**Winkworth**





### DESCRIPTION:

A bright, beautifully presented, top floor 524 sq. ft. (approx.) one bedroom apartment with separate kitchen/breakfast room and a South facing private balcony in a purpose-built block a short walk from Highbury & Islington, Angel and Canonbury stations.

Upon entering the property, the hallway leads to a three-piece modern family bathroom with bathtub and large, recently fitted kitchen/breakfast room on the left, whereas the generously sized bedroom with fitted wardrobes is located on the right. Adjacent to the bedroom is a bright living room with natural wood flooring that leads to a South facing private balcony overlooking the leafy communal gardens. Newly installed top of the range boiler with app controlled thermostat.

Ashby Grove is ideally located for easy living with an array of shops, restaurants and cafes located on Essex Road. The numerous restaurants of Upper Street are a short distance away and transport links are well served by bus, Tube and Overground lines. The flat is offered for sale with no onward chain.

**Winkworth**





Winkworth

# Ashby Grove, N1

Approx. Gross Internal Floor Area 524 sq. ft / 48.66 sq. m

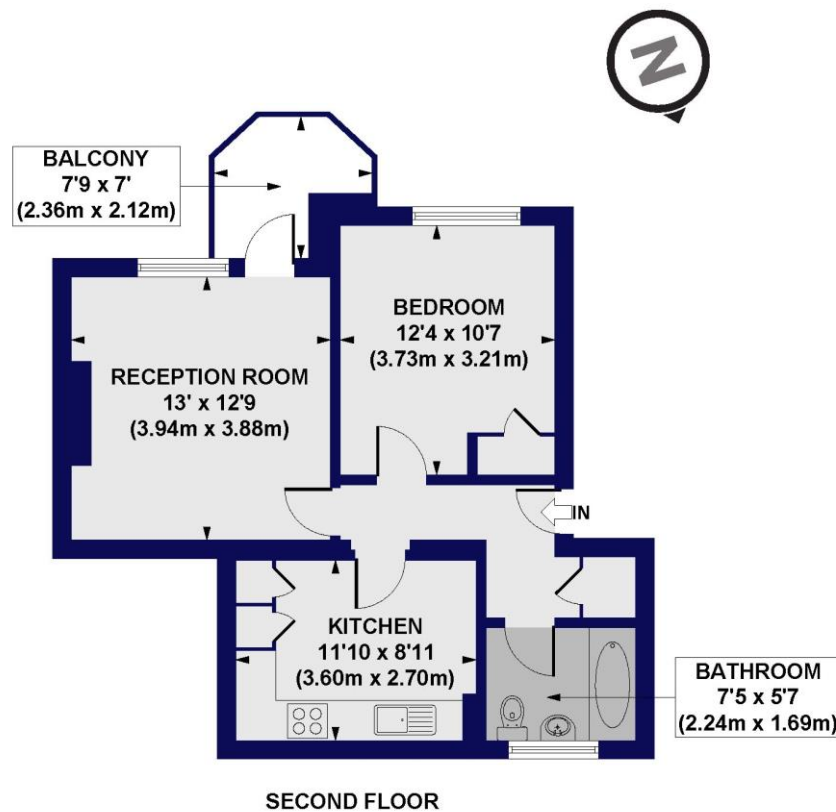

All measurements of walls, doors, windows, fittings and appliances, including their size and location, are shown as standard sizes and do not constitute any warranty or representation by the seller, their agent or CP Creative. Any intending purchaser must satisfy himself by inspection or otherwise as to the correctness of the information contained in these plans. This plan is for illustrative purposes only and should be used as such by any prospective purchasers.

**Winkworth**

This floorplan is for illustration purposes only and is not to scale. The position and size of doors, windows, appliances and other features are approximate.

Score	Energy rating	Current	Potential
92+	A		
81-91	B		
69-80	C	69 C	77 C
55-68	D		
39-54	E		
21-38	F		
1-20	G		



<https://www.winkworth.co.uk/sale/property/ISL210158>

**Tenure:** Leasehold

**Term:** 101 year and 11 months

**Service Charge:** £1700 per annum

**Ground Rent:** £ 10 Annually (subject to increase)

**Council Tax Band:**

Where no figures are shown, we have been unable to ascertain the information. All figures that are shown were

Islington | 0207 354 2480 | [islington@winkworth.co.uk](mailto:islington@winkworth.co.uk)

**Winkworth**

[winkworth.co.uk](https://www.winkworth.co.uk)

See things differently

Winkworth wishes to inform prospective buyers and tenants that these particulars are a guide and act as information only. All our details are given in good faith and believed to be correct at the time of printing but they don't form part of an offer or contract. No Winkworth employee has authority to make or give any representation or warranty in relation to this property. All fixtures and fittings, whether fitted or not are deemed removable by the vendor unless stated otherwise and room sizes are measured between internal wall surfaces, including furnishings.