



GRANGE ROAD, LONDON, NW10
£435,000

**A WELL-PRESENTED TWO BEDROOM FIRST FLOOR FLAT,
WELL LOCATED FOR ACCESS TO AN ARRAY OF
AMENITIES AND TRANSPORT LINKS.**

Kensal Rise & Queens Park | 0208 960 4947 | kensalrise@winkworth.co.uk



LOCATION:

Grange Road is a popular and quiet road located just north of Kensal Rise. Most local residents access the amenities of High Road in Willesden and both College Road and Chamberlayne Road in Kensal Rise, which have an array of independent shops, pubs, restaurants and large Sainsbury's at your fingertips. Transport links are great at Willesden Green Tube Station (Jubilee Line) to get in and out of London.



DESCRIPTION:

Set within a period Victorian conversion, we are pleased to offer this two bedroom, first floor flat. The flat comprises of a bright and airy full width front reception and dining room with large bay window, separate kitchen, main three-piece bathroom suite, and two spacious double bedrooms. Overall, the property is ready to move in to and viewing therefore comes highly recommended.

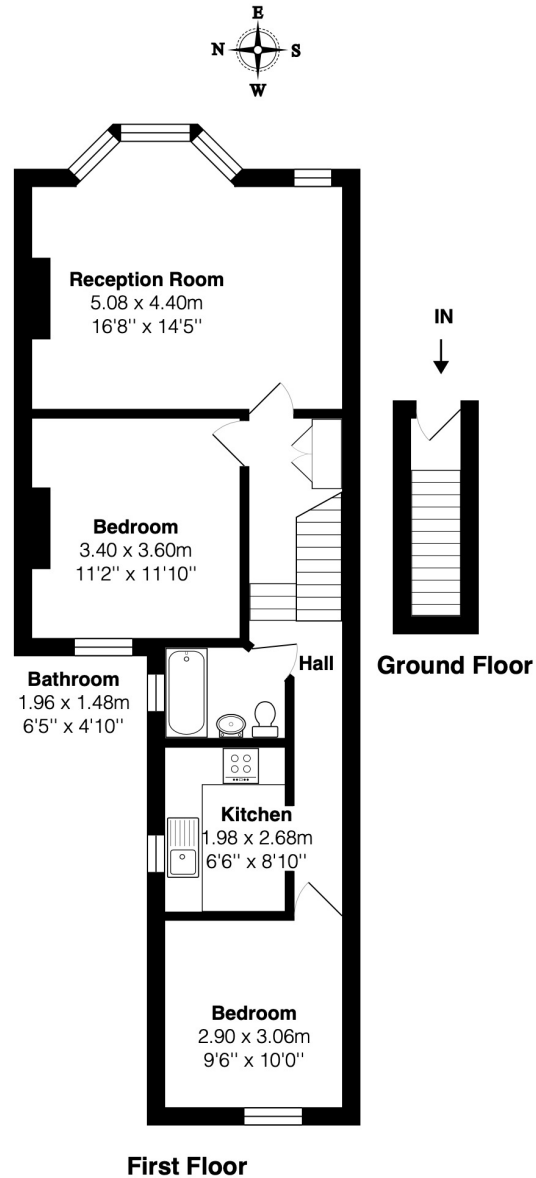

Total Area: 61.3 m² ... 659 ft²

All measurements are approximate and for display purposes only