



Monxton Place

Sherfield Park Hook RG27 0FB

Description

This is a delightful top floor apartment that benefits from plenty of natural light with views out over a central green. It is handily placed for the commuter between Basingstoke and Reading with a local railway station nearby at Bramley.

It has been well maintained and has a triple aspect kitchen/living room with a bay window. The kitchen has good storage space and integrated appliances including a gas hob, built-in oven and a washing machine.

There are two good size bedrooms with the master having a built-in double wardrobe. The bathroom has a modern white suite with contemporary wall tiling and has a shower end bath with a shower and fitted screen.

Externally there is an allocated parking space with additional visitor spaces.



Winkworth

Accommodation

Entrance hall
Kitchen/living room
Two bedrooms
Bathroom
Allocated parking space
Communal gardens
Gas central heating
Unfurnished

Under the Property Misdescriptions Act 1991, these Particulars are a guide and act as information only. All details are given in good faith and are believed to be correct at time of printing. Winkworth give no representation as to their accuracy and potential purchasers or tenants must satisfy themselves by inspection or otherwise as to their correctness. No employee of Winkworth has authority to make or give any representation or warranty in relation to this property.

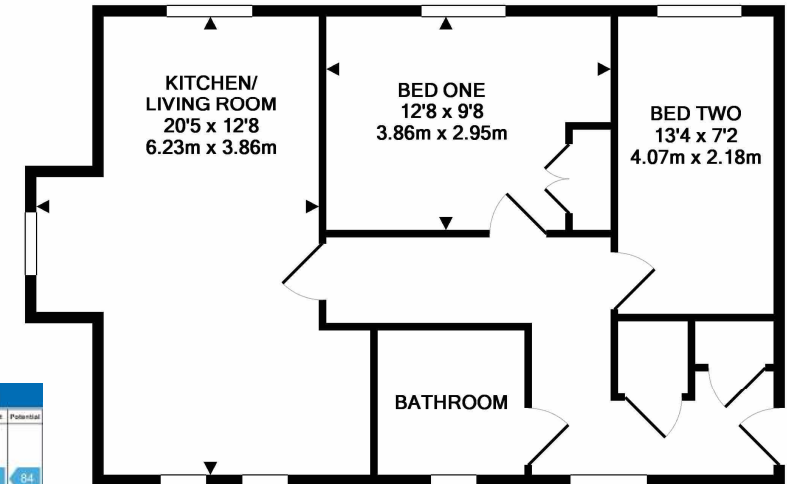
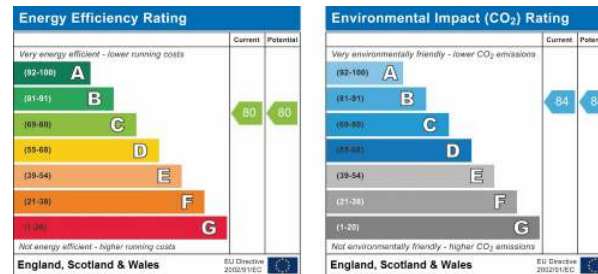

TOTAL APPROX. FLOOR AREA 623 SQ.FT. (57.9 SQ.M.)

Whilst every attempt has been made to ensure the accuracy of the floor plan contained here, measurements of doors, windows, rooms and any other items are approximate and no responsibility is taken for any error, omission, or mis-statement. This plan is for illustrative purposes only and should be used as such by any prospective purchaser. The services, systems and appliances shown have not been tested and no guarantee as to their operability or efficiency can be given
Made with Metropix ©2019



Basingstoke Office

10B Church Street, Basingstoke, Hampshire, RG21 7QE

01256 811730 | basingstoke@winkworth.co.uk

winkworth.co.uk/Basingstoke

Winkworth

See things differently.