



FLAT 9 STEVENS COURT, 405-411 READING ROAD, WINNERSH, WOKINGHAM, BERKSHIRE,
RG41 5GU
£155,000 LEASEHOLD

Winkworth



READING ROAD

This one bedroom ground floor garden apartment is offered with its own living room patio looking onto an attractive well-maintained garden. The apartment is newly carpeted and in excellent condition to move in immediately.

Stevens Court comprises 35 properties ideally located to all key amenities. Within 250m of its entrance residents have access to a GP Practice, dentist, Sainsbury supermarket, Winnersh Library, hairdresser, barbers, restaurants and takeaways.

It further benefits from being on the bus route to both Wokingham and Reading town centre and a two minute walk from Winnersh railway station offering a direct commute into London.

Stevens Court is a friendly community supported by a full-time development manager and a 24-hour emergency Appello call system. Events are held throughout the week and trips organised for those who may be interested. There is a guest suite for family and friends and private parking.

A current annual service charge will include building repairs, decoration, cleaning and heating of the common areas and lounge. It also includes gardening, car park maintenance and communal washing/drying facilities and refuse collection.

It is a condition of purchase that residents are over the age of 60 years, or in the event of a couple, one must be over the age of 60 years and the other 55 years.

EPC: C





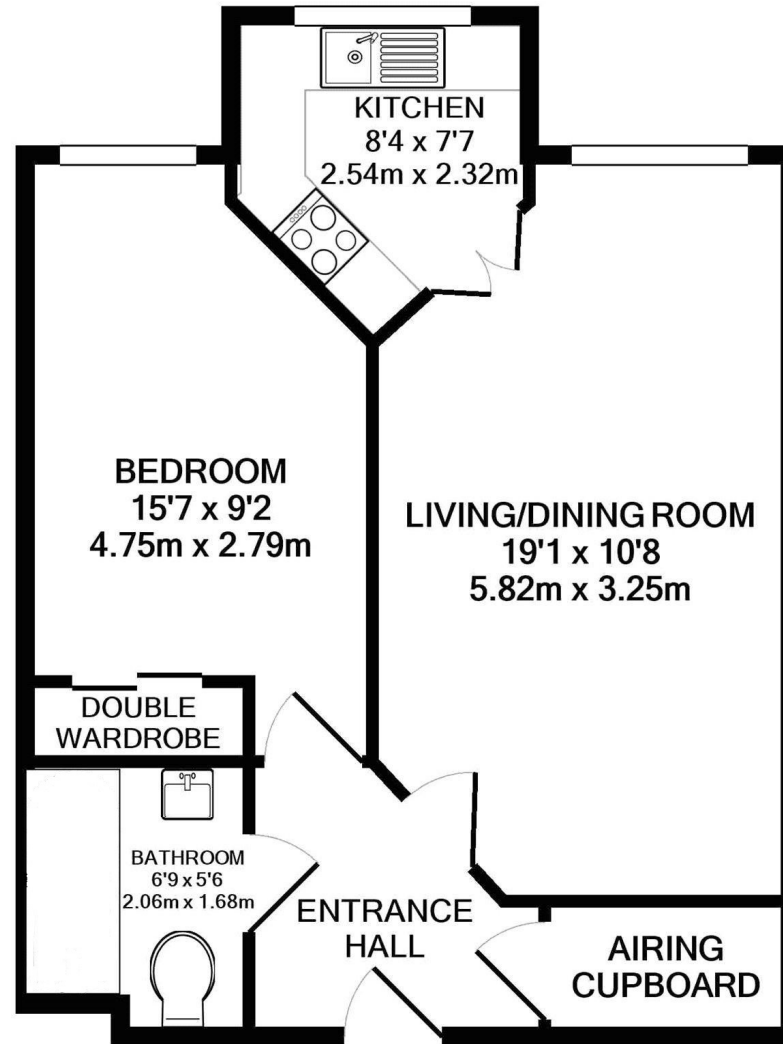

TOTAL APPROX. FLOOR AREA 465 SQ.FT. (43.2 SQ.M.)
Made with Metropix

Wokingham | 01189 072777 | wokingham@winkworth.co.uk

Winkworth wishes to inform prospective buyers and tenants that these particulars are a guide and act as information only. All our details are given in good faith and believed to be correct at the time of printing but they don't form part of an offer or contract. No Winkworth employee has authority to make or give any representation or warranty in relation to this property. All fixtures and fittings, whether fitted or not are deemed removable by the vendor unless stated otherwise and room sizes are measured between internal wall surfaces, including furnishings.

Winkworth