



26 Saxon Way, Romsey, Hampshire, SO51 5QF

Winkworth

EXTENDED, THREE BEDROOM SEMI-DETACHED HOME

The Property is located in the popular residential area of Halterworth on the outskirts of town. Romsey is a delightful old market town which has retained much of its original character, and provides excellent amenities for everyday needs. Romsey has a range of individual shops, schools, leisure facilities, doctors and dentist surgeries and public transport by way of bus and rail services. The M27 can be accessed about 3 ½ miles distant, and the major centres of Salisbury, Southampton and Winchester are also easily accessible.

The accommodation comprises entrance hallway with access to the spacious open plan living/dining room with patio doors to rear garden. The kitchen/breakfast room is of generous proportions with a good range of units and access door to side of the house. To the first floor are two double bedrooms and a third single, with a modern family bathroom.

Outside to the front the property has a driveway with access to the single garage and providing off road parking and side access to the garden. The rear garden is fully enclosed and laid mainly to lawn with a delightful decked area.





Winkworth

**Address: 26 Saxon Way, Romsey,
Hampshire, SO51 5QF**

Council Tax Band: "D"

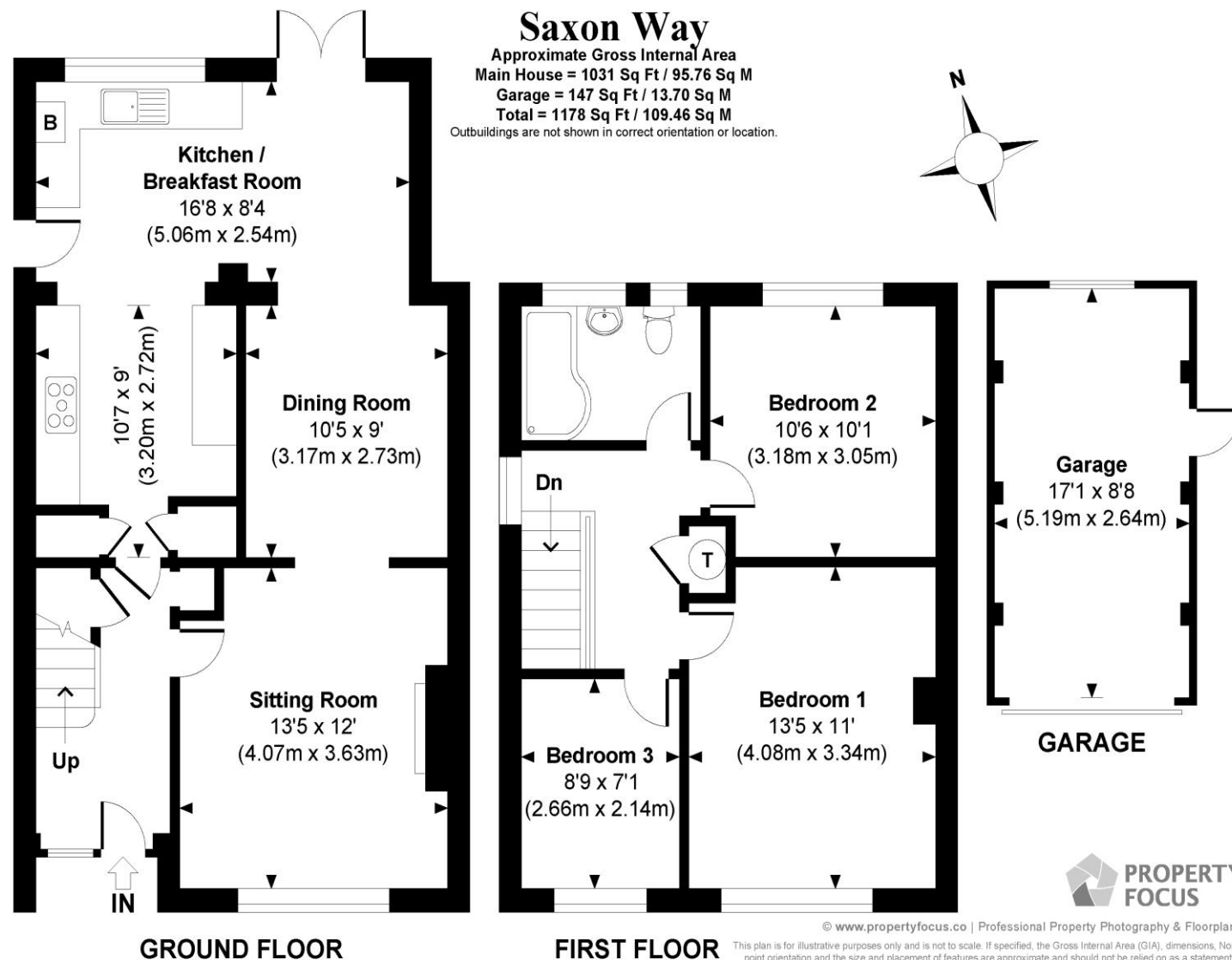

winkworth.co.uk/romsey

Winkworth Romsey

18 Market Place, Romsey, Hampshire, SO51 8NA
01794 511911 | romsey@winkworth.co.uk

winkworth.co.uk/romsey

Winkworth Winchester

2 Black Swan Buildings, Southgate Street,
Winchester, Hampshire, SO23 9DT
01962 866777 | winchester@winkworth.co.uk

Winkworth Mayfair & Country House Department

11 Berkeley Street, Mayfair, London, W1J 8DS
020 7871 0589 | countryhouse@winkworth.co.uk

Winkworth

See things differently