



GILBEY ROAD, SW17
£325,000 LEASEHOLD

**ONE BEDROOM FIRST FLOOR FLAT A SHORT
DISTANCE FROM THE UNDERGROUND.**

Tooting | 020 8767 5221 | tooting@winkworth.co.uk

Winkworth

for every step...

winkworth.co.uk



DESCRIPTION:

Introducing a generously proportioned one-bedroom first-floor period conversion. Nestled in a prime location, just moments away from the vibrant ambiance of Tooting Broadway and its Northern line underground station, this property offers convenience and charm.

Step inside to discover a well-appointed kitchen, a spacious lounge area, a comfortable double bedroom, and a bathroom. Added comforts include gas central heating and double glazing, ensuring a cozy and energy-efficient living space.

Situated on Gilbey Road, this residence enjoys proximity to a plethora of shops, eateries, and entertainment options in the lively neighbourhood of Tooting. Additional amenities can be found nearby in Earlsfield, offering convenience at your doorstep. Tooting Broadway underground station, serviced by the Northern Line, provides seamless transportation access.

(Disclaimer: Photos provided were captured in March 2019)

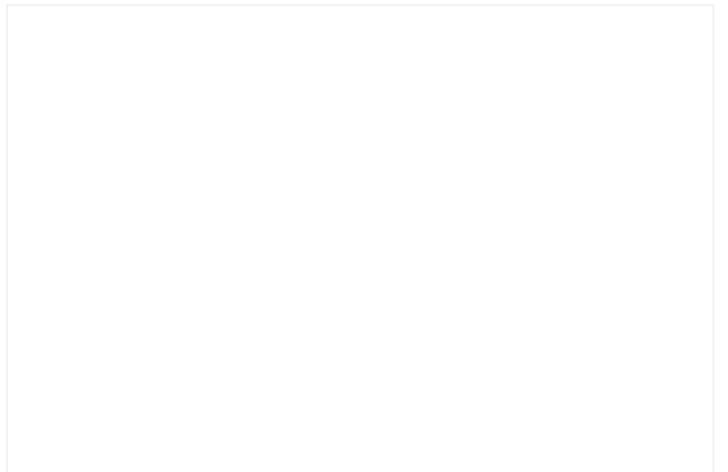
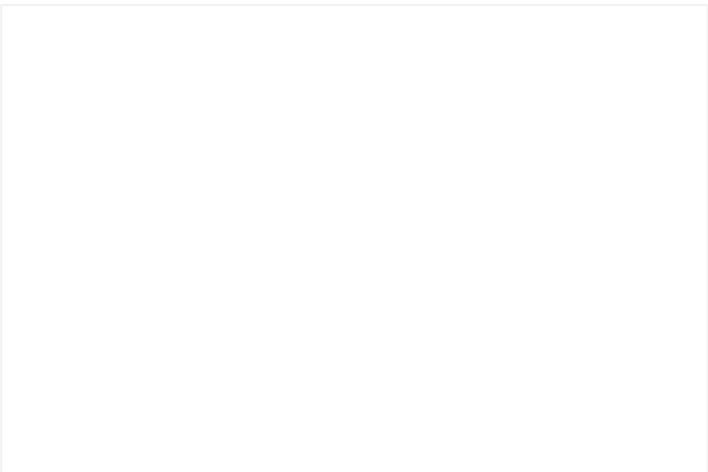
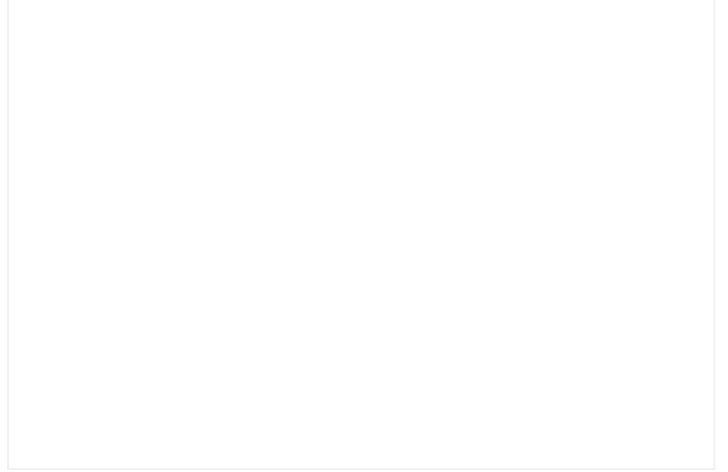
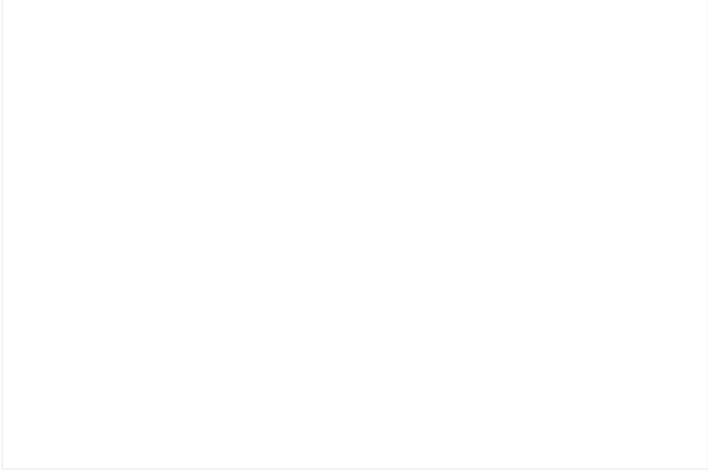

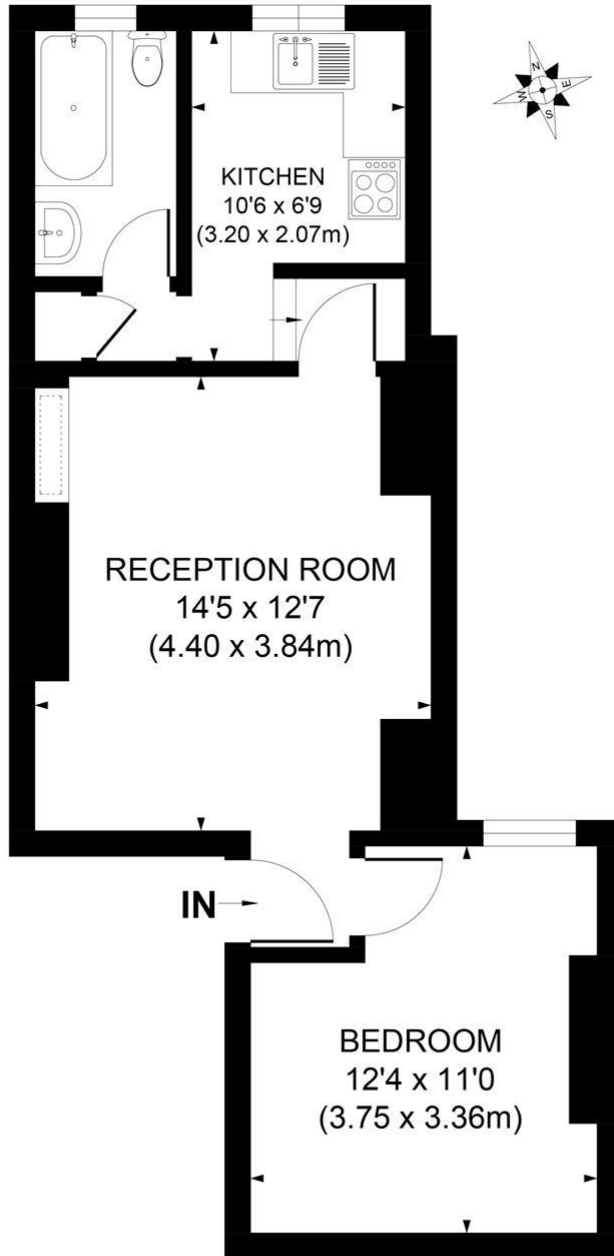

FIRST FLOOR

APPROX. GROSS INTERNAL FLOOR AREA 450 SQ. FT / 41.82 SQ. M

Illustration for identification purpose only, not to scale
All measurements are maximum, and includes wardrobes and window bays where applicable
Prepared by Pixangle ©. Tel 020 8870 2118

This floorplan is for illustration purposes only and is not to scale. The position and size of doors, windows, appliances and other features are approximate.

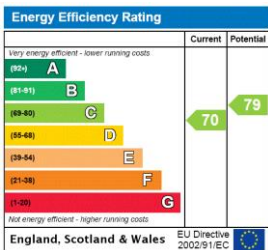

Tooting | 020 8767 5221 | tooting@winkworth.co.uk

for every step...

winkworth.co.uk

Winkworth wishes to inform prospective buyers and tenants that these particulars are a guide and act as information only. All our details are given in good faith and believed to be correct at the time of printing but they don't form part of an offer or contract. No Winkworth employee has authority to make or give any representation or warranty in relation to this property. All fixtures and fittings, whether fitted or not are deemed removable by the vendor unless stated otherwise and room sizes are measured between internal wall surfaces, including furnishings.