

## AYLESFORD STREET, SW1V

£595,000

SHARE OF FREEHOLD

### At a glance...

- One Double Bedroom
- Recently Refurbished
- 1st Floor
- Close to Underground
- Balcony
- Council Tax Band: D

**Winkworth**

for every step...



Score	Energy rating	Current	Potential
92+	A		
81-91	B		
69-80	C		77 C
55-68	D	67 D	
39-54	E		
21-38	F		
1-20	G		

## AYLESFORD STREET, SW1V

£595,000

SHARE OF FREEHOLD

A lovely 1 double bedroom flat located on the 1st floor of this handsome, period Pimlico building.

The flat has recently undergone major renovation including levelling of the floors and wood being laid, installation of extra insulation to aide soundproofing and heat retention and underfloor heating in the reception room and kitchen.

With excellent ceiling height, generously sized rooms and a fantastic balcony the flat would make an ideal 1st time buy, secure London base or great rental investment.

Aylesford Street is a perfect location and the flat is a mere 0.1 miles from Pimlico underground station as well as a short walk to Victoria, Vauxhall and Westminster.



winkworth wishes to inform prospective buyers and tenants that these particulars are a guide and act as information only. All our details are given in good faith and believed to be correct at the time of printing but they don't form part of an offer or contract. No winkworth employee has authority to make or give any representation or warranty in relation to this property. All fixtures and fittings, whether fitted or not are deemed removable by the vendor unless stated otherwise and room sizes are measured between internal wall surfaces - including fire-chimneys.

## Aylesford Street, SW1

Approx. Gross Internal Area  
433 Sq Ft - 40.23 Sq M

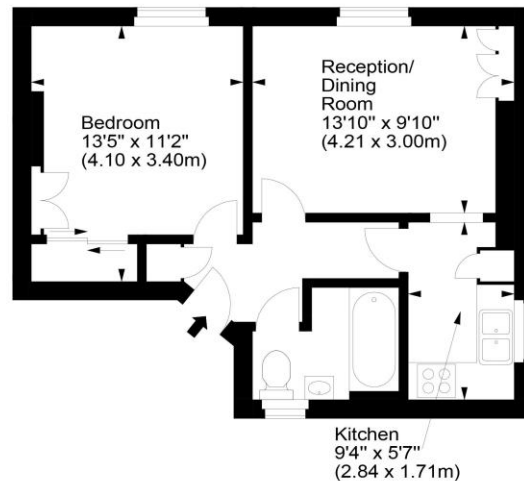

First Floor

Winkworth

Pimlico & Westminster

020 7828 1786

pimlico@winkworth.co.uk

winkworth.co.uk/pimlico-westminster

Winkworth

for every step...