



KENT COURT, KENT STREET, LONDON, E2
'OFFERS IN EXCESS OF' £400,000 LEASEHOLD

A SPACIOUS TWO DOUBLE BEDROOM GROUND FLOOR FLAT WITHIN WALKING DISTANCE TO HOXTON STATION

Hackney | 020 8986 4216 | hackney@winkworth.co.uk

Winkworth



DESCRIPTION:

The highlight of this flat is its inviting open plan kitchen and living room, creating a spacious and versatile area. The modern kitchen is equipped with integrated appliances and provides ample room for a dining table. Both bedrooms in this flat are generously sized double rooms, ensuring a comfortable living experience. Each bedroom offers plenty of space for wardrobes, and one of them features a convenient built-in cupboard, providing additional storage. There is also a well-appointed 3-piece bathroom suite.

Situated in the vibrant E2 area opposite Haggerston Park this property enjoys proximity to a plethora of local amenities. Explore the eclectic mix of cafes, restaurants, and boutiques that characterize the neighbourhood, creating a lively and diverse community atmosphere. Transportation is easy with excellent links, including several bus routes and the convenience of Hoxton and Haggerston stations just a short walk away, connecting you effortlessly to the wider London network.

Winkworth



Winkworth

Kent Court, Kent Street, E2
 Approx. Gross Internal Floor Area 681 sq. ft / 63.29 sq. m

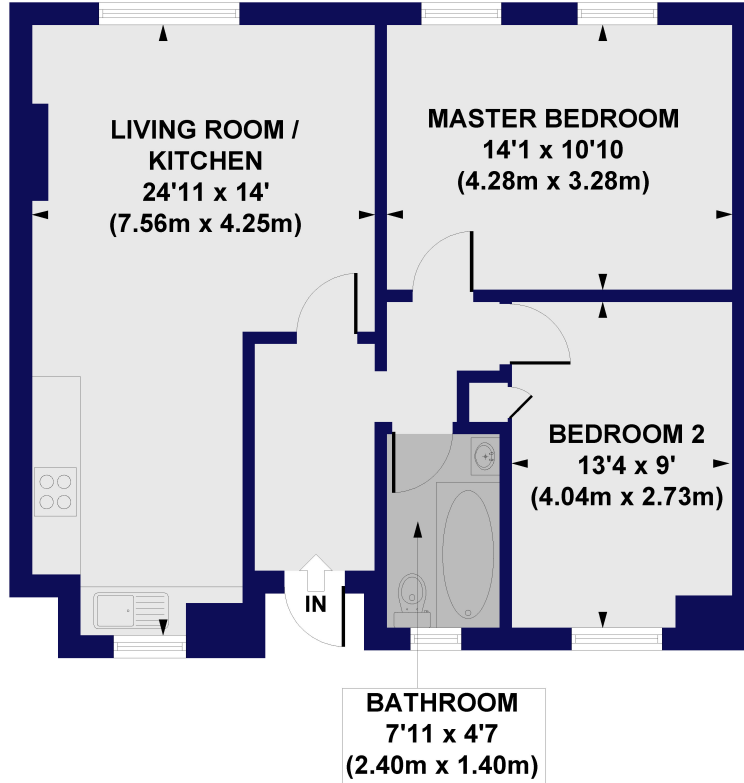

GROUND FLOOR

All measurements of walls, doors, windows, fittings and appliances, including their size and location, are shown as standard sizes and do not constitute any warranty or representation by the seller, their agent or CP Creative. Any intending purchaser must satisfy himself by inspection or otherwise as to the correctness of the information contained in these plans. This plan is for illustrative purposes only and should be used as such by any prospective purchasers.

Winkworth

This floorplan is for illustration purposes only and is not to scale. The position and size of doors, windows, appliances and other features are approximate.

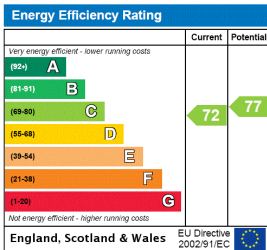

Hackney | 020 8986 4216 | hackney@winkworth.co.uk

Winkworth

winkworth.co.uk

See things differently

Winkworth wishes to inform prospective buyers and tenants that these particulars are a guide and act as information only. All our details are given in good faith and believed to be correct at the time of printing but they don't form part of an offer or contract. No Winkworth employee has authority to make or give any representation or warranty in relation to this property. All fixtures and fittings, whether fitted or not are deemed removable by the vendor unless stated otherwise and room sizes are measured between internal wall surfaces, including furnishings.