



WELL END ROAD, BOREHAMWOOD, HERTFORDSHIRE, WD6

£1,299,000 FREEHOLD

**AN IMMACULATELY PRESENTED FOUR BEDROOM
TWO BATHROOM DETACHED FAMILY HOUSE IN
WELL END**

Borehamwood | 020 8953 8899 | borehamwood@winkworth.co.uk



DESCRIPTION:

Located in the highly desirable, semi-rural area on the outskirts of Borehamwood known as Well End is this much improved and immaculately presented detached family house.

The accommodation, totalling in excess of 1800 square feet, has been meticulously maintained throughout and comprises of four double bedrooms, two bathrooms, study, lounge, utility room and generous kitchen/dining/family room with direct access to the large South Westerly facing rear garden. Improvements, amongst many, include electric car charging point, garden irrigation system, air conditioning, summer house and CCTV.

AT A GLANCE

- 4 Double Bedrooms
- Two Bathrooms
- Large South Westerly Rear Garden
- 1817 Square Feet
- Chain Free
- Off Street Parking for Multiple Cars
- Air Conditioning



Winkworth



Winkworth



Ground Floor

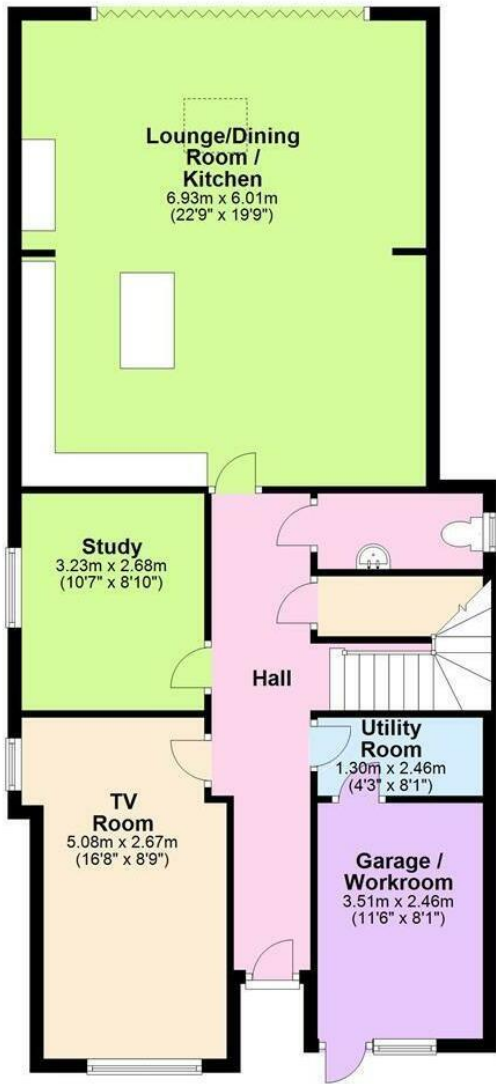

First Floor

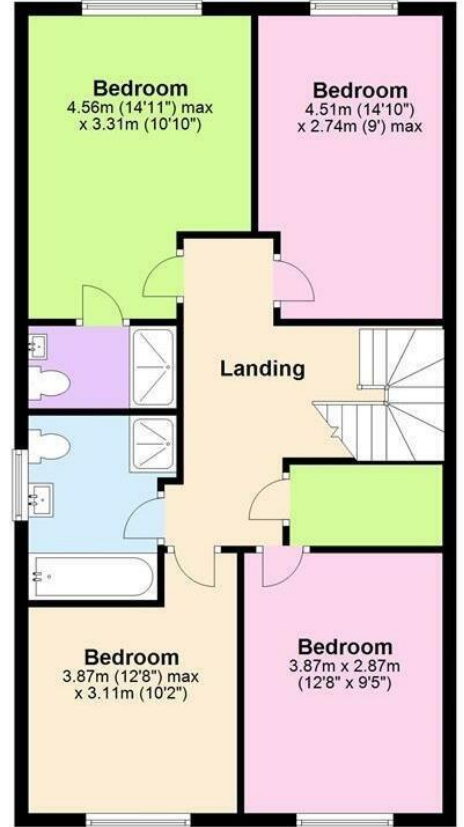

Total area: approx. 168.8 sq. metres (1817.3 sq. feet)

The measurements given are approximate and are for illustration only. They should not be relied on for valuation. Plan produced using PlanUp.

This floorplan is for illustration purposes only and is not to scale. The position and size of doors, windows, appliances and other features are approximate.

