



LADBROKE GROVE, W10
£375,000 LEASEHOLD

**A STYLISH SPACIOUS ONE BEDROOM FLAT
 WITH LARGE BRIGHT SASH WINDOWS AND
 HIGH CEILINGS**

North Kensington | 020 7792 5000 | northkensington@winkworth.co.uk

Winkworth

for every step...

winkworth.co.uk



DESCRIPTION:

Located moments from Portobello Road and Golborne Road, lies this fantastic first floor flat. The property comprises of a good-sized living room, separate kitchen, double bedroom and bathroom.

Ladbroke Grove is ideally located for the fashionable restaurants, shops and bars of the famous Portobello Road and a short walk to Ladbroke Grove underground.

AT A GLANCE

- Period Property
- One Bedroom Flat
- High Ceilings
- Sash Windows
- Wooden Floors Throughout
- Great Location
- EPC Rating C





Kerrington Court

Approx. Gross Internal Area 404 Sq Ft - 37.53 Sq M

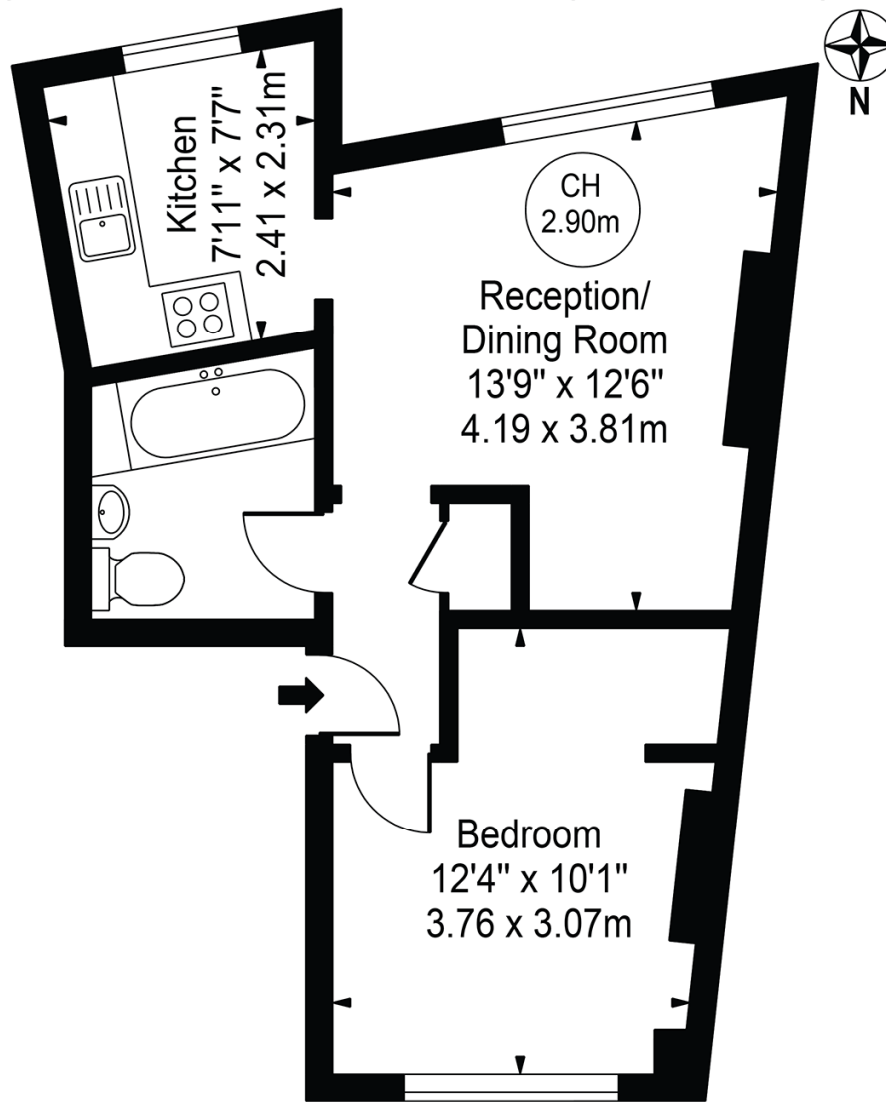

First Floor

For Illustration Purposes Only - Not To Scale

This floor plan should be used as a general outline for guidance only and does not constitute in whole or in part an offer or contract. Any intending purchaser or lessee should satisfy themselves by inspection, searches, enquiries and full survey as to the correctness of each statement. Any areas, measurements or distances quoted are approximate and should not be used to value a property or be the basis of any sale or let. Copyright Morriarti Photography & Design LTD

This floorplan is for illustration purposes only and is not to scale. The position and size of doors, windows, appliances and other features are approximate.

Score	Energy rating	Current	Potential
92+	A		
81-91	B		
69-80	C		
55-68	D		
39-54	E		
21-38	F		
1-20	G		

Tenure: Leasehold

Term: 164 years

Service Charge: £1600 per annum

Ground Rent: Peppercorn

Council Tax Band: RBKC Band B

Where no figures are shown, we have been unable to ascertain the information. All figures that are shown were correct at the time of printing.

North Kensington | 020 7792 5000 | northkensington@winkworth.co.uk

Winkworth

for every step...

winkworth.co.uk

Winkworth wishes to inform prospective buyers and tenants that these particulars are a guide and act as information only. All our details are given in good faith and believed to be correct at the time of printing but they don't form part of an offer or contract. No Winkworth employee has authority to make or give any representation or warranty in relation to this property. All fixtures and fittings, whether fitted or not are deemed removable by the vendor unless stated otherwise and room sizes are measured between internal wall surfaces, including furnishings.