



RIVERVIEW HEIGHTS, SHOOTERS HILL, LONDON, SE18
£1,850 PER MONTH UNFURNISHED

DESCRIPTION:

A two double bedroom apartment with balcony and garage with absolutely stunning views over London and the River Thames from this elevated position at the top of Shooters Hill Slopes. Offered unfurnished and available from 9th November 2025, your earliest viewing is highly advised.

Blackheath | 0208 8520999 | blackheath@winkworth.co.uk

First Floor

Approx. 75.0 sq. metres (807.5 sq. feet)

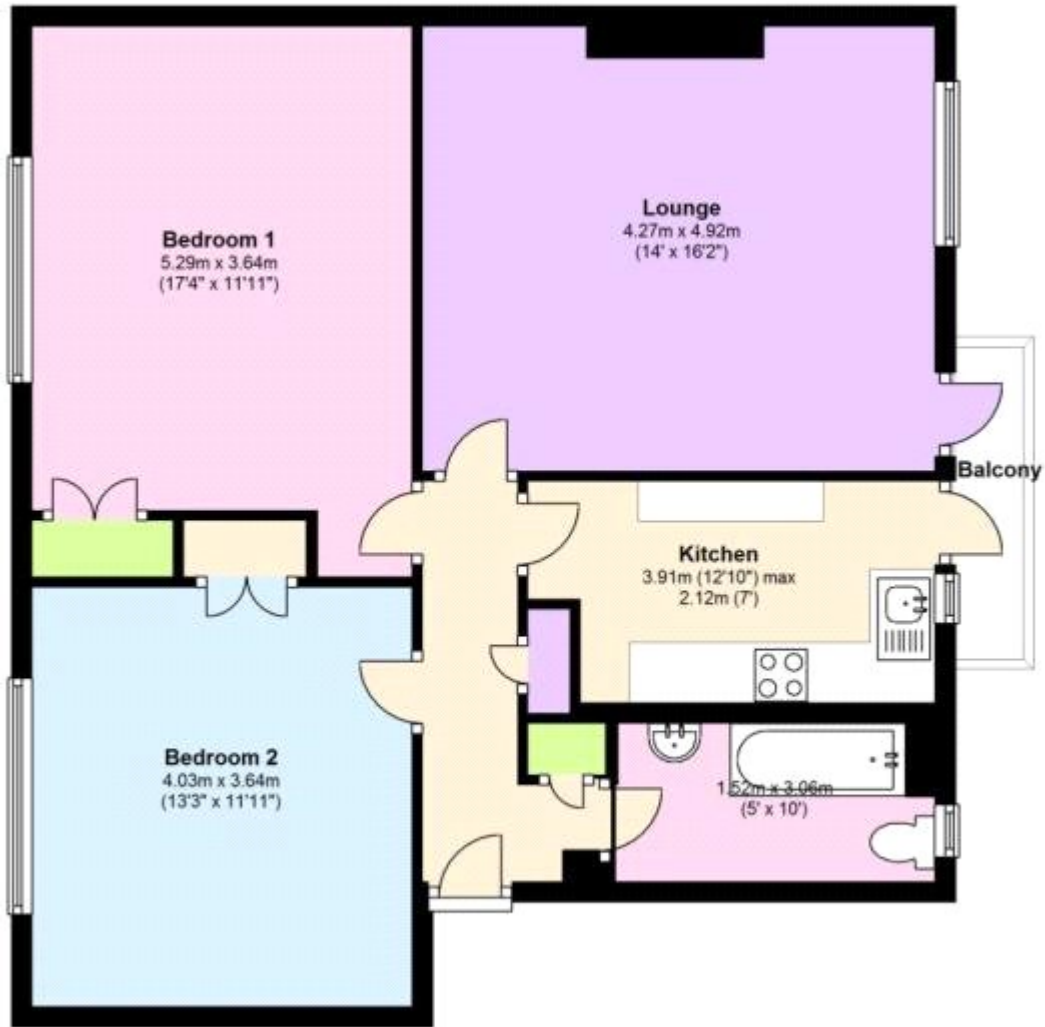

Total area: approx. 75.0 sq. metres (807.5 sq. feet)

This floorplan is for illustration purposes only and is not to scale. The position and size of doors, windows, appliances and other features are approximate.

Energy Efficiency Rating		
	Current	Potential
Very energy efficient - lower running costs		
A (92+)		81
B (81-91)		
C (69-80)		
D (55-68)	67	
E (39-54)		
F (21-38)		
G (1-20)		
Not energy efficient - higher running costs		
England, Scotland & Wales EU Directive 2002/91/EC		

Deposit: £2,134.62

Holding Deposit:

Council Tax Band:

Where no figures are shown, we have been unable to ascertain the information. All figures that are shown were correct at the time of printing.