



BULLHEAD ROAD, HERTFORDSHIRE, WD6
£485,000 FREEHOLD

AN EXTENDED THREE BEDROOM END OF TERRACE HOUSE IN SOUTH BOREHAMWOOD

Borehamwood | 020 8953 8899 | borehamwood@winkworth.co.uk



DESCRIPTION:

Located on the South side of Borehamwood, a short walk from the highly regarded Monksmead primary and Yavneh Primary and Secondary Schools is this extended three bedroom end of terrace family house.

Offered for sale chain free, the property has been subject to a part single storey rear extension and should the need arise could be extended further subject to the usual planning consents.

A large paved front garden provides off street parking for several cars and to the rear there is a mature Westerly facing rear garden.

AT A GLANCE

- 3 Bedrooms
- South Borehamwood
- Chain Free
- Walking distance to Yavneh and Monksmead Schools
- Westerly Rear Garden
- Off Street Parking
- 761 Square Feet
- Gas Central Heating





Approximate Gross Internal Area
70.7 sq m / 761 sq ft

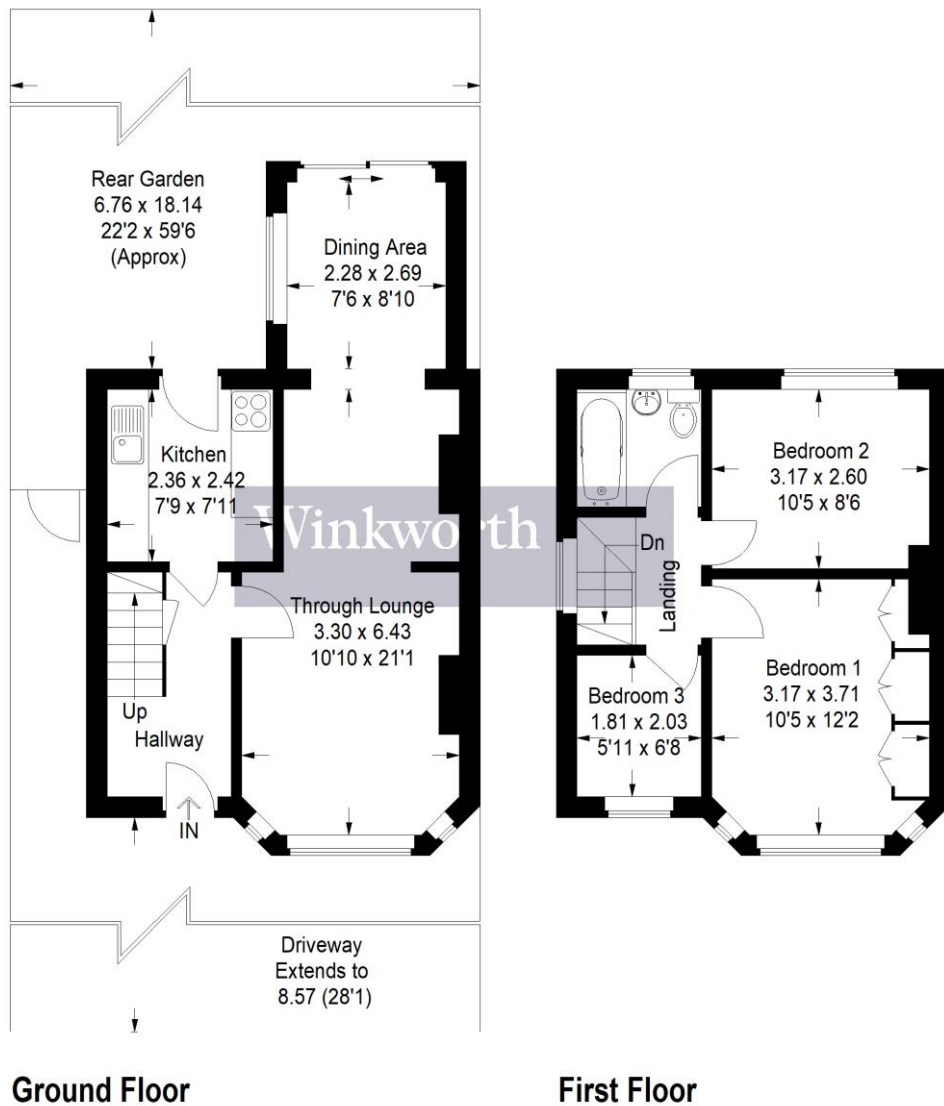

Illustration for identification purposes only, measurements are approximate, not to scale. Winkworth © 2021 (ID788053)

This floorplan is for illustration purposes only and is not to scale. The position and size of doors, windows, appliances and other features are approximate.

