



**Highfield, Whitenap Lane, Romsey, SO51 5RS**

**Winkworth**



## BEAUTIFUL DETACHED BUNGALOW

This deceptively spacious three-bedroom detached bungalow is located in the popular Whitenap area, on the outskirts of Romsey. The accommodation comprises large entrance hallway leading to all principal rooms. To the front elevation are the master bedroom and bedroom two. The master has a lovely bay window, and benefits from a modern en-suite shower room. The spacious kitchen is flooded with light and is fitted with a wide range of eye and base level units and some integral appliances. The light and airy sitting/dining room overlooks the lovely garden and provides access to a terrace through French doors. Bedrooms two and three are serviced by a family bathroom. The property benefits from gas central heating.

With a wonderful outlook to the front, overlooking playing fields, the gravel driveway offers ample off-road parking. The rear garden is a lovely relaxing space mainly laid to lawn, enclosed by fencing for privacy.

Highfield is a superb detached family home situated in the very sought-after area of Whitenap. Located within easy walking distance to both Mountbatten and Halterworth schools making this location extremely desirable. Whitenap also boasts bus routes to the town centre, Winchester and Southampton. Within the district there is the renowned Luzborough Public House, a handy convenience store and large park with play area. Located to the south east of Romsey town, Whitenap is approximately 1.7 miles from the town centre and 1.5 miles from Romsey train station. Romsey, a delightful old market town has retained much of its original character and provides an excellent range of amenities for everyday needs. Facilities include a range of individual shops, schools, leisure facilities, doctors and dentist surgeries. The M27 can be accessed at junction 3, about 3 ½ miles distant. The major centres of Salisbury, Southampton, Winchester and Portsmouth are all easily accessed.

The property is offered with no forward chain



# Winkworth

**Address: Highfield, Whitenap Lane,  
Romsey, Hampshire SO51 5RS**

**Council Tax Band: "C" EPC "D"**



## Highfield, Whitenap Lane, Romsey, SO51

Approximate Area = 872 sq ft / 81 sq m

For identification only - Not to scale

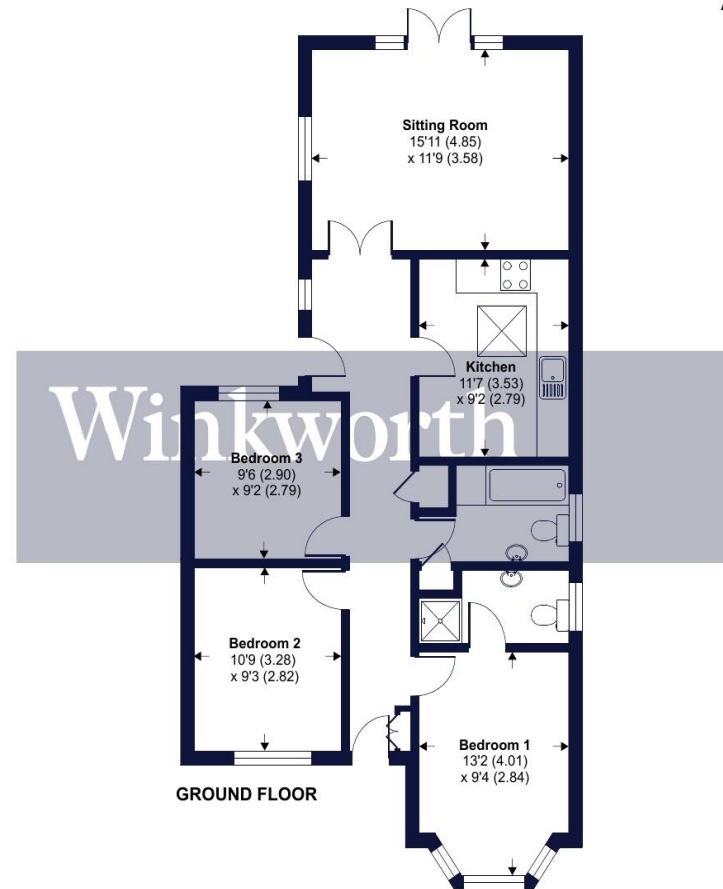

Floor plan produced in accordance with RICS Property Measurement Standards incorporating International Property Measurement Standards (IPMS2 Residential). © nrdhecom 2022. Produced for Winkworth. REF: 859222

[winkworth.co.uk/romsey](http://winkworth.co.uk/romsey)

### Winkworth Romsey

18 Market Place, Romsey, Hampshire, SO51 8NA  
01794 511911 | [romsey@winkworth.co.uk](mailto:romsey@winkworth.co.uk)

[winkworth.co.uk/romsey](http://winkworth.co.uk/romsey)

### Winkworth Winchester

2 Black Swan Buildings, Southgate Street,  
Winchester, Hampshire, SO23 9DT  
01962 866777 | [winchester@winkworth.co.uk](mailto:winchester@winkworth.co.uk)

### Winkworth Mayfair & Country House Department

11 Berkeley Street, Mayfair, London, W1J 8DS  
020 7871 0589 | [countryhouse@winkworth.co.uk](mailto:countryhouse@winkworth.co.uk)

# Winkworth

See things differently