



BULLHEAD ROAD, HERTFORDSHIRE, WD6
£325,000 LEASEHOLD

A CHAIN FREE TWO/THREE BEDROOM GARDEN MAISONETTE IN SOUTH BOREHAMWOOD

Borehamwood | 020 8953 8899 | borehamwood@winkworth.co.uk



DESCRIPTION:

Located on the South side of Borehamwood and offered for sale Chain Free is this extended two/three-bedroom ground floor purpose built garden maisonette.

Having historically been subject to a rear extension the property now provides in excess of 700 square feet of well-proportioned accommodation which is complimented by its own large Westerly facing rear garden.

Located a short walk to the highly regarded Monksmead primary and Yavneh Primary and Secondary Schools the property would be ideal for a young family, first time buyer or downsizer.

AT A GLANCE

- 2/3 Bedrooms
- 131 Year Lease
- Chain Free
- Own Rear Garden
- 710 Square Feet
- Gas Central; Heating
- Double Glazed
- South Borehamwood





Approximate Gross Internal Area = 66.0 sq m / 710 sq ft

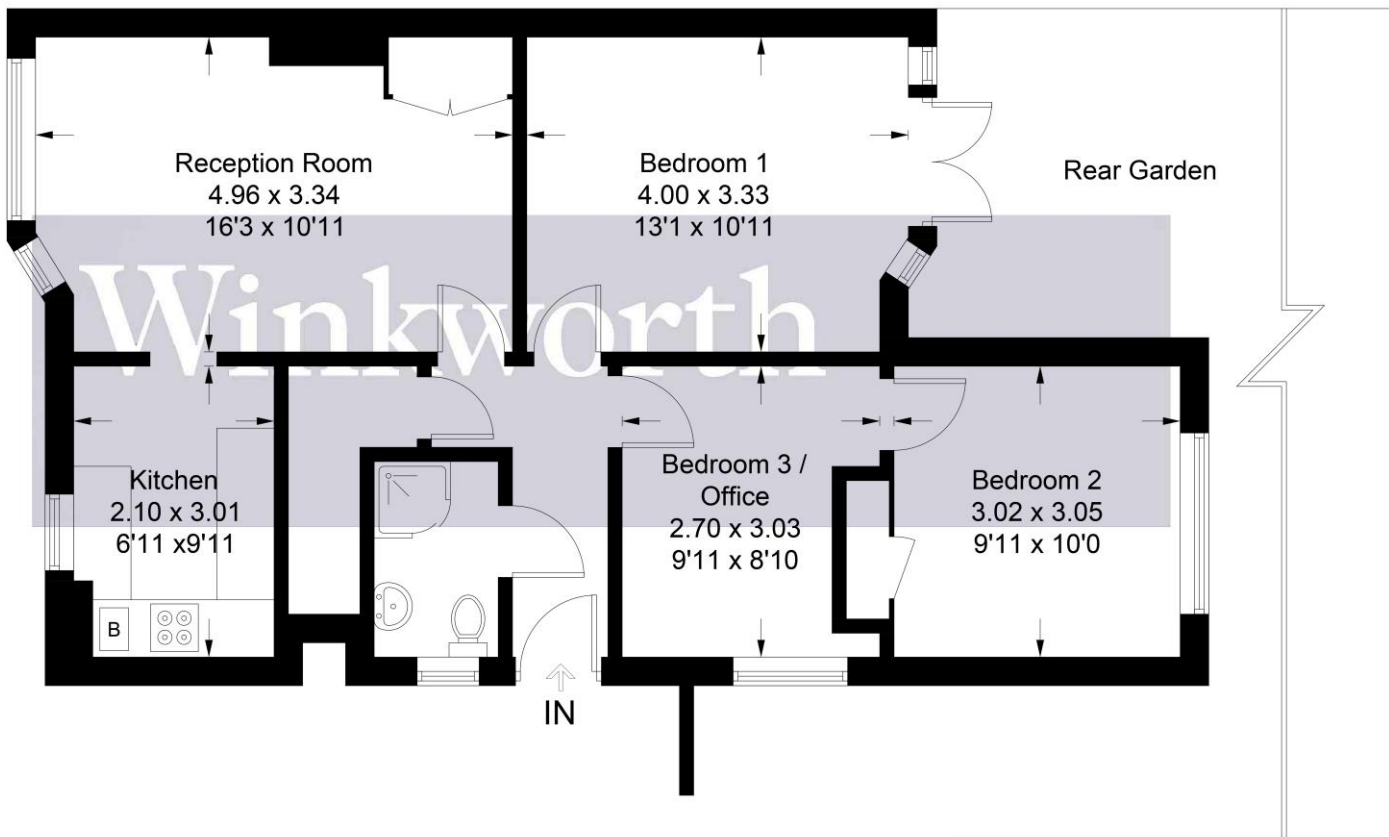

Illustration for identification purposes only, measurements are approximate, not to scale. Winkworth © 2025 (ID1221496)

This floorplan is for illustration purposes only and is not to scale. The position and size of doors, windows, appliances and other features are approximate.

Score	Energy rating	Current	Potential
92+	A		
81-91	B		
69-80	C	70 C	75 C
55-68	D		
39-54	E		
21-38	F		
1-20	G		

Tenure: Leasehold

Term: 131 year and 3 months

Service Charge: £417.16 per annum

Ground Rent: £ 50 Annually (subject to increase)

Council Tax Band: C

Where no figures are shown, we have been unable to ascertain the information. All figures that are shown were correct at the time of printing.