



CROCKERTON ROAD, SW17  
**£575,000 LEASEHOLD**

**AN EXCEPTIONAL TWO DOUBLE BEDROOM GARDEN FLAT  
SITUATED ON ONE OF TOOTING BECS MOST SOUGHT  
AFTER ROADS.**

Tooting | 020 8767 5221 | [tooting@winkworth.co.uk](mailto:tooting@winkworth.co.uk)

**Winkworth**

for every step...

[winkworth.co.uk](http://winkworth.co.uk)



## DESCRIPTION

A fabulous two bedroom ground floor garden flat presented in immaculate condition throughout.

Offering just over 730 sq.ft and provides a wonderful open plan living space with direct access to the enormous South facing garden.

This exceptional flat has beautiful original parquet flooring throughout the living area and bedrooms. On accessing the flat there is a generous hallway, with the bathroom and fully fitted kitchen with access to the garden situated on the left and the two generous double bedrooms on the right. At the end of the hallway is a wonderful open plan reception room. There is an abundance of natural light from the large window overlooking the garden. There is a door that leads out to the private large south-facing garden which is mainly laid. There is generous sized patio area and a useful shed for further storage.

Crockerton Road is well located within a short walk of the shops and restaurants of Bellevue road and the open expanses of both Wandsworth Common and Tooting Common. Wandsworth Common over ground station is nearby and gives quick access into Victoria/Waterloo via Clapham Junction and underground services to the City can be found at Tooting Bec (northern line). Perfectly situated equidistance from Balham and Tooting Broadway and the market which are both around a 15 minute walk. The area is well served by both state and private schools, with the popular Finton House close by.





# CROCKERTON ROAD, SW17

Approx. Gross Internal Floor Area

734 Sq. ft/68.21 Sq. m

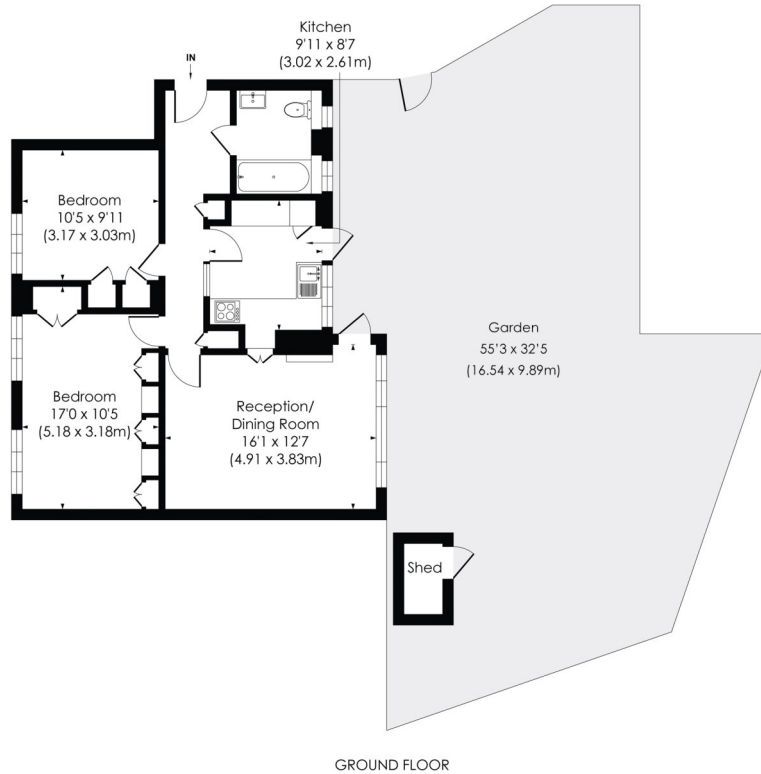

© Pixangle Property Marketing Ltd. info@pixangle.com Tel: 0208 870 2118



This floor plan has been prepared for the purpose of illustration only in accordance with the latest RICS code of measuring practice and is not to scale. All measurements and areas are approximate and whilst every effort has been made to ensure the accuracy of the plan contained here, no responsibility is taken for any error, omission or misstatement.

This floorplan is for illustration purposes only and is not to scale. The position and size of doors, windows, appliances and other features are approximate.

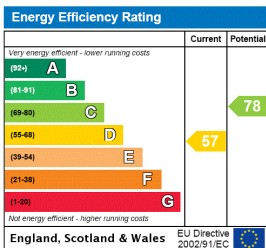

Tooting | 020 8767 5221 | tooting@winkworth.co.uk

for every step...

winkworth.co.uk

Winkworth wishes to inform prospective buyers and tenants that these particulars are a guide and act as information only. All our details are given in good faith and believed to be correct at the time of printing but they don't form part of an offer or contract. No Winkworth employee has authority to make or give any representation or warranty in relation to this property. All fixtures and fittings, whether fitted or not are deemed removable by the vendor unless stated otherwise and room sizes are measured between internal wall surfaces, including furnishings.