



CURNESS STREET, LEWISHAM, LONDON, SE13 6JY
OFFERS IN EXCESS OF £290,000 LEASEHOLD

**A SPACIOUS TWO BEDROOM, TWO BATHROOM
 GROUND FLOOR APARTMENT WITH DIRECT ACCESS
 ONTO THE COMMUNAL GARDENS, SOLD CHAIN FREE.**

Blackheath | 0208 8520999 | blackheath@winkworth.co.uk

Winkworth

for every step...

winkworth.co.uk



DESCRIPTION:

Spanning 625 sq. ft the property briefly comprises; a large (18'8x11'3) reception room with open plan kitchen complete with integrated appliances. There are two generously sized bedrooms, the master with en suite shower room and finally is the main family bathroom.

The property is sold chain free and has the rare benefit of having direct access onto the well maintained communal gardens. Your immediate viewing is highly recommended.

Curness Street is located just 300 metres from Ladywell Village, renowned for its quirky range of independent shops, gastro pub, deli and patisserie. Brockley farmers market is close by, a great place to visit Saturday mornings. Lewisham has extensive shopping choices and is being enhanced by new investment, attracting new restaurants and amenities. The popular street food Model Market is a two minute walk. Blackheath Village and Greenwich with its array of boutiques, bars and restaurants are also close by. For the commute, Ladywell Train Station is a two minute walk, which has regular connections to the City and Charing Cross and only 9 minutes from London Bridge. Lewisham Station and DLR is also a short walk. The promise of the Bakerloo Line tube coming into the location offers more attraction. The open spaces of Ladywell Fields (150 metres) with its river walks and cafe, Hilly Fields, (395 metres), with its stunning views of London and a café, Manor House Gardens, (0.7 miles), Blackheath Common, (1.2 miles), and Greenwich Park, (1.28 miles), are all within easy reach. There are popular primary schools close by including the "Outstanding" Prendergast Hilly Fields as well as several sought-after private schools.





Ground Floor

Approx. 58.1 sq. metres (625.5 sq. feet)

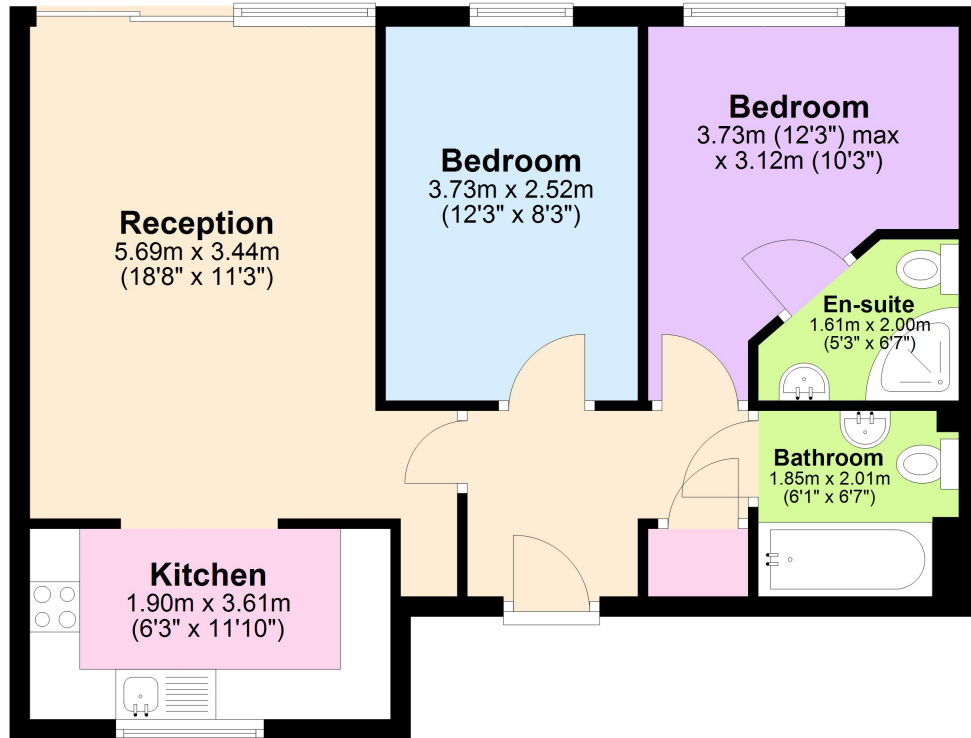

Total area: approx. 58.1 sq. metres (625.5 sq. feet)

This floorplan is for illustration purposes only and is not to scale. The position and size of doors, windows, appliances and other features are approximate. Any lease and service charge details have been provided by the vendor. Any interest party should have these checked by a solicitor as part of the purchase process.

Score	Energy rating	Current	Potential
92+	A		
81-91	B	81 B	81 B
69-80	C		
55-68	D		
39-54	E		
21-38	F		
1-20	G		

Blackheath | 0208 8520999 | blackheath@winkworth.co.uk

Winkworth

for every step...

winkworth.co.uk

Winkworth wishes to inform prospective buyers and tenants that these particulars are a guide and act as information only. All our details are given in good faith and believed to be correct at the time of printing but they don't form part of an offer or contract. No Winkworth employee has authority to make or give any representation or warranty in relation to this property. All fixtures and fittings, whether fitted or not are deemed removable by the vendor unless stated otherwise and room sizes are measured between internal wall surfaces, including furnishings.