



## Roundwood Road, London, NW10

£525,000 *Share of Freehold*



A well appointed and fully extended, three bedroom, two bathroom, ground floor flat with private rear garden and studio/summerhouse with share of freehold.

### KEY FEATURES

- THREE BEDROOMS
- TWO BATHROOM
- PRIVATE GARDEN
- STUDIO/SUMMER HOUSE
- SHARE OF FREEHOLD
- EXTENDED



## Kensal Rise & Queens Park

0208 960 4947 | [kensalrise@winkworth.co.uk](mailto:kensalrise@winkworth.co.uk)

**Winkworth**

for every step...

Winkworth wishes to inform prospective buyers and tenants that these particulars are a guide and act as information only. All our details are given in good faith and believed to be correct at the time of printing but they don't form part of an offer or contract. No Winkworth employee has authority to make or give any representation or warranty in relation to this property. All fixtures and fittings, whether fitted or not are deemed removable by the vendor unless stated otherwise and room sizes are measured between internal wall surfaces, including furnishings.





#### DESCRIPTION

This fantastic and spacious flat offers 960 sqft of internal space, comprising of two double bedrooms and large single room to the front section of the flat - all with bespoke fitted wardrobes. The main bathroom, as well as the additional shower room located under the stairs, are both three piece tiled suites.

To the rear of the flat, you will find an incredible extended open plan reception room and modern kitchen with dining space. The bi-folding doors slide open the entire width of the property leading you on to the private garden. As part of the side and rear extension works, multiple sky lights were installed, flooding this entire space with natural light.

Additionally, there is a studio/summer house in the garden – perfect for additional storage, a home office or gym.

The property further benefits from no upper chain, and share of freehold.







### LOCATION

Roundwood Road is an attractive, tree lined street and benefits from being near to the open green spaces of Roundwood Park.

Willesden Junction, Dollis Hill and Willesden Green Stations also offer excellent transport links in and out of town via the Bakerloo, Jubilee and London Overground services.

There are an array of amenities within easy access making this a popular location.

For more information, scan the QR code or visit the link below



<https://www.winkworth.co.uk/sale/property/KQP250210>

Where no figures are shown, we have been unable to ascertain the information. All figures that are shown were correct at the time of printing.

### MATERIAL INFO

**Tenure:** Share of Freehold

**Service Charge:** Ask Agent

**Ground Rent:** Ask Agent

**Council Tax Band:** C

**EPC rating:** C

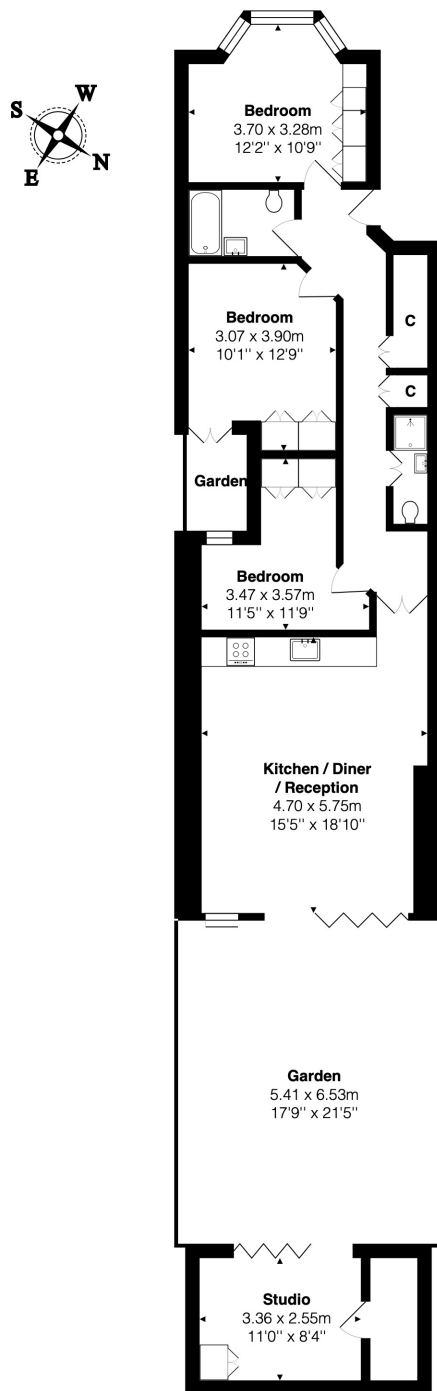

#### Ground Floor

Total Area: 89.2 m<sup>2</sup> ... 960 ft<sup>2</sup> (excluding garden)

All measurements are approximate and for display purposes only

**Kensal Rise & Queens Park**

0208 960 4947 | [kensalrise@winkworth.co.uk](mailto:kensalrise@winkworth.co.uk)

**Winkworth**

for every step...

Winkworth wishes to inform prospective buyers and tenants that these particulars are a guide and act as information only. All our details are given in good faith and believed to be correct at the time of printing but they don't form part of an offer or contract. No Winkworth employee has authority to make or give any representation or warranty in relation to this property. All fixtures and fittings, whether fitted or not are deemed removable by the vendor unless stated otherwise and room sizes are measured between internal wall surfaces, including furnishings.