



**DOWNHURST COURT, HENDON, LONDON, NW4**  
**£450,000 LEASEHOLD**

**A WELL PRESENTED TWO DOUBLE BEDROOM SECOND FLOOR APARTMENT WITH LIFT SITUATED WITHIN A POPULAR AND WELL LOCATED PURPOSE BUILT BLOCK**

Hendon | 020 8202 1031 | [hendon@winkworth.co.uk](mailto:hendon@winkworth.co.uk)

**Winkworth**

for every step...

*winkworth.co.uk*





## DESCRIPTION:

This is a beautifully presented and spacious two double bedroom apartment situated within a fantastic purpose built block. The apartment comprises two double bedrooms, modern bathroom suite, separate fully fitted eat-in kitchen, large living room and guest W.C.

Further benefits include: entry phone system, long lease, gas central heating, lift, garage and immaculately maintained communal gardens. The property is located close to the many local amenities which Hendon has to offer. Sold chain free

Viewing is highly recommended

EPC: D

## AT A GLANCE

- BEAUTIFULLY PRESENTED TWO DOUBLE BEDROOM SECOND FLOOR APARTMENT
- LOCATED WITHIN A POPULAR PURPOSE BUILT BLOCK
- LARGE LIVING ROOM
- LONG LEASE
- IMMACULATEDLY MAINTAINED COMMUNAL GARDENS
- CLOSE PROXIMITY TO LOCAL AMENITIES







**Downhurst Court, NW4**  
**Approx. Gross Internal Floor Area 780 sq. ft / 72.54 sq. m**

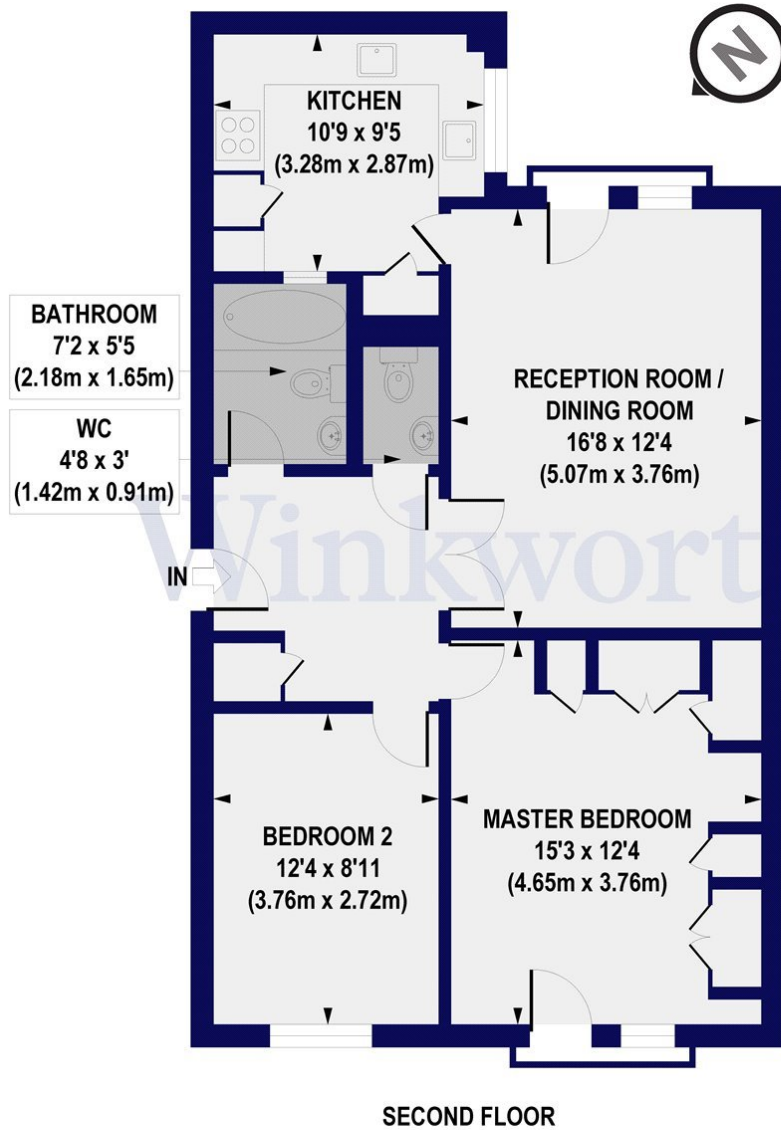

All measurements of walls, doors, windows, fittings and appliances, including their size and location, are shown as standard sizes and do not constitute any warranty or representation by the seller, their agent or CP Creative. Any intending purchaser must satisfy himself by inspection or otherwise as to the correctness of the information contained in these plans. This plan is for illustrative purposes only and should be used as such by any prospective purchasers.

**Winkworth**

This floorplan is for illustration purposes only and is not to scale. The position and size of doors, windows, appliances and other features are approximate.

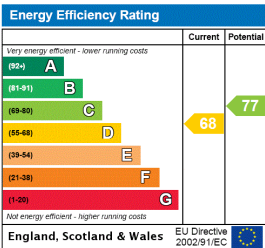

**Winkworth**

Hendon | 020 8202 1031 | hendon@winkworth.co.uk

for every step...

winkworth.co.uk

Winkworth wishes to inform prospective buyers and tenants that these particulars are a guide and act as information only. All our details are given in good faith and believed to be correct at the time of printing but they don't form part of an offer or contract. No Winkworth employee has authority to make or give any representation or warranty in relation to this property. All fixtures and fittings, whether fitted or not are deemed removable by the vendor unless stated otherwise and room sizes are measured between internal wall surfaces, including furnishings.