



**Dudsbury Road**  
West Parley, Ferndown BH22 8RB  
**Offers Over £700,000**

**Winkworth**





**Offers Over £700,000  
FREEHOLD**

**This stunning five bedroom, three bathroom detached house is positioned on a generous secluded plot in one of the areas most sought after roads.**

**The property has been finished to an excellent standard throughout with many lovely features including a fabulous open plan kitchen/dining/family room with bi folding doors onto a south facing garden, with hot tub including a bespoke seating area and pizza oven – the perfect space for al fresco dining and to enjoy sunny days from!**

**Further benefits include off road parking for multiple vehicles, a 65ft south facing garden and a double garage currently arranged as a home gym.**

Five Bedroom Detached Family Home  
Three Bathrooms & Guest WC  
Hot Tub & Log Burner  
Double Garage/Home Gym  
Stunning Interior  
Sought After Location  
Driveway For Several Vehicles  
Open Plan Kitchen/Breakfast/Family Room  
Utility Room  
CCTV  
Versatile Layout  
Secluded 65ft South Facing Garden  
Bedroom With En-suite  
EPC D | Council Tax Band F

**01202 434365  
ferndown@winkworth.co.uk**









## Dudsbury Road

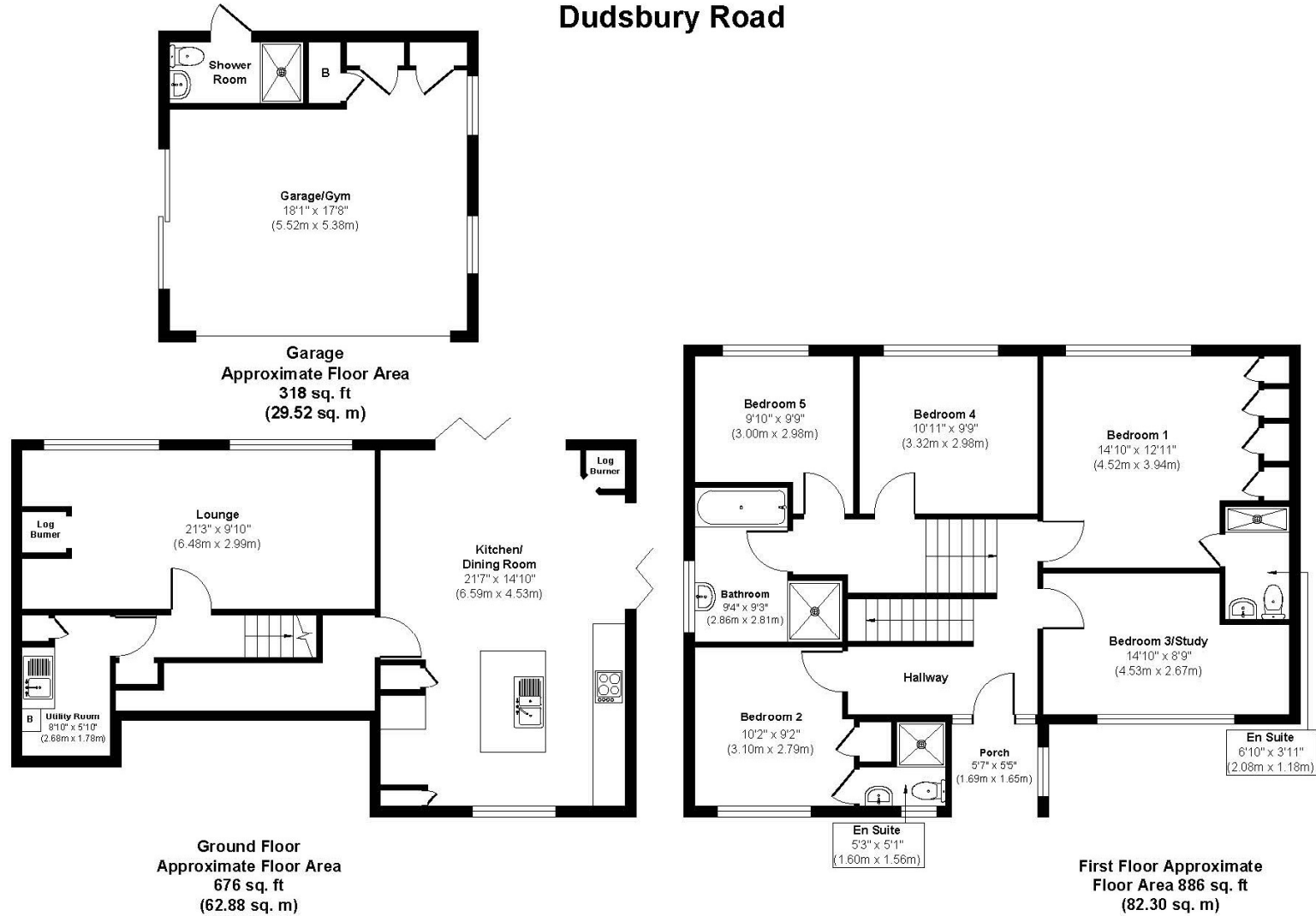

Approx. Gross Internal Floor Area 1880 sq. ft / 174.70 sq. m  
Illustration for identification purposes only, measurements approximate and not to scale.





#### LOCATION

Dudsbury Road is a particularly sought after location within West Parley, conveniently close to Ferndown town centre which has a range of amenities including an M&S Foodhall, independent cafés, and restaurants. Within catchment for Ferndown Schools and walking distance of Ferndown Championship Golf Course which is located on nearby Golf Links Road. There are good transport links giving you easy access to Bournemouth, Wimborne and Poole, all of which have an excellent range of shops, bars, restaurants and leisure facilities. Award winning sandy beaches are just twenty minutes away and the A31 provides quick access to the New Forest, Southampton, London and beyond.

Winkworth Ferndown

406 Ringwood Road, Ferndown, Dorset, BH22 9AU

01202 434365 | [ferndown@winkworth.co.uk](mailto:ferndown@winkworth.co.uk)

[winkworth.co.uk/ferndown](http://winkworth.co.uk/ferndown)

**Winkworth**