



WITHERINGTON ROAD, LONDON, N5
£425 PER WEEK FURNISHED

**ARRANGED OVER THE FIRST FLOOR OF A
 CONVERTED VICTORIAN CONVERSION, IS
 THIS BRIGHT, AIRY AND SPACIOUS ONE**

Islington | 0207 354 2480 | islington@winkworth.co.uk

Winkworth

Tenant Fees Apply: Details of fees for tenant referencing, tenancy agreement admin fees and renewal fees are available on the Winkworth website and the link can be found with the displayed rent for the property. Tenants should ensure they are fully conversant with these upfront fees and other costs that are involved at the outset of the tenancy before making an offer to rent and your local Winkworth office will provide written details upon request.

winkworth.co.uk

See things differently



DESCRIPTION:

Arranged over the first floor of a converted Victorian conversion, is this bright, airy and spacious one bedroom apartment. Recently refurbished to a very high standard and standing at over 500 sqft, with great transport links and wooden flooring throughout this property is essential viewing for a busy professional. Witherington Road is wonderfully quiet, tree lined street conveniently located just off Highbury Fields and moments from Highbury and Islington station (Victoria and East London Lines), Drayton Park over ground station and Arsenal underground stations. Upper Street is close by and provides an assortment of bars and restaurants alongside an array of boutique shops. Highbury Barn also offers a great variety of local amenities including renowned deli's, butchers and vintners.

Winkworth



Winkworth

Witherington Road, N5
Approx. Gross Internal Floor Area 519 sq. ft / 48.26 sq. m

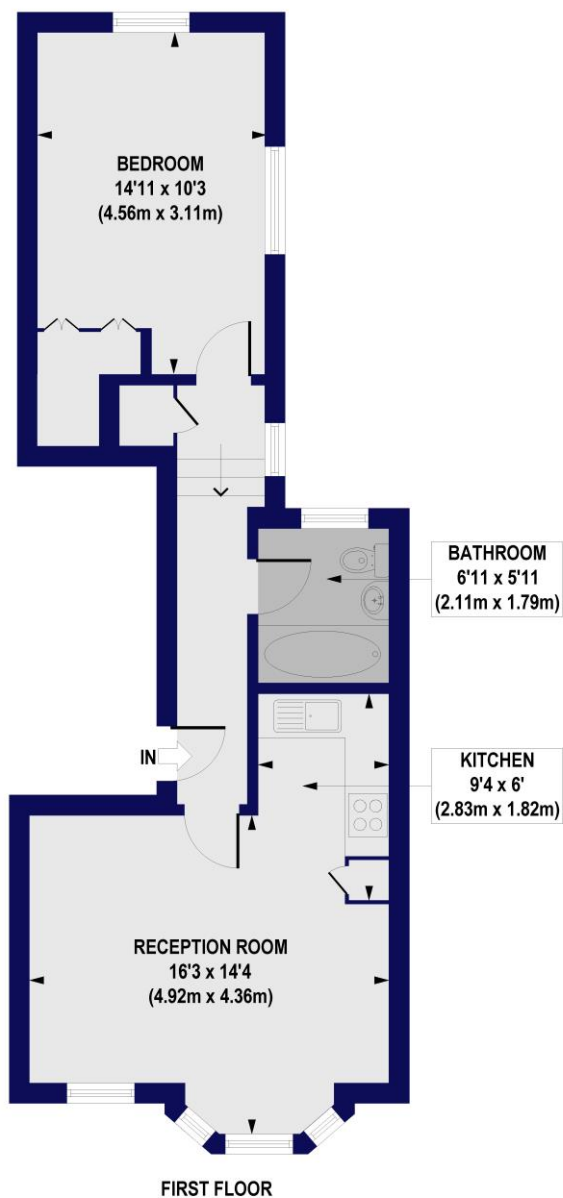

All measurements of walls, doors, windows, fittings and appliances, including their size and location, are shown as standard sizes and do not constitute any warranty or representation by the seller, their agent or CP Creative. Any intending purchaser must satisfy himself by inspection or otherwise as to the correctness of the information contained in these plans. This plan is for illustrative purposes only and should be used as such by any prospective purchasers.

Winkworth

This floorplan is for illustration purposes only and is not to scale. The position and size of doors, windows, appliances and other features are approximate.

Islington | 0207 354 2480 | islington@winkworth.co.uk

Winkworth

winkworth.co.uk

See things differently

Winkworth wishes to inform prospective buyers and tenants that these particulars are a guide and act as information only. All our details are given in good faith and believed to be correct at the time of printing but they don't form part of an offer or contract. No Winkworth employee has authority to make or give any representation or warranty in relation to this property. All fixtures and fittings, whether fitted or not are deemed removable by the vendor unless stated otherwise and room sizes are measured between internal wall surfaces, including furnishings.