



LADBROKE GROVE, LONDON, W10  
**£2,350 PER MONTH**

**Winkworth**



## LADBROKE GROVE, LONDON, W10

Newly Refurbished 1-Bedroom Apartment in the Heart of Ladbroke Grove, Notting Hill

A beautifully refurbished one-bedroom apartment ideally situated in the vibrant heart of Ladbroke Grove, Notting Hill.

This stunning property has been recently redeveloped and benefits from a comprehensive modernisation throughout. Finished to an exceptional standard, the apartment is tastefully decorated and offers:

A spacious and bright double bedroom

A stylish open-plan kitchen and reception area

A sleek, modern bathroom suite

Contemporary finishes and high-quality fittings throughout

Located in North Kensington's multicultural hotspot, Ladbroke Grove is the epitome of modern urban living. The area boasts an eclectic mix of unique restaurants, artisan coffee shops, and antique furniture stores. The world-famous Portobello Market is just a short stroll away, along with excellent transport links via Ladbroke Grove Underground Station.

This is an ideal home for professionals, first-time buyers, or investors seeking a prime London location with character and connectivity.

Viewing highly recommended.







# Ladbroke Grove

Approx. Gross Internal Area 425 Sq Ft - 39.48 Sq M

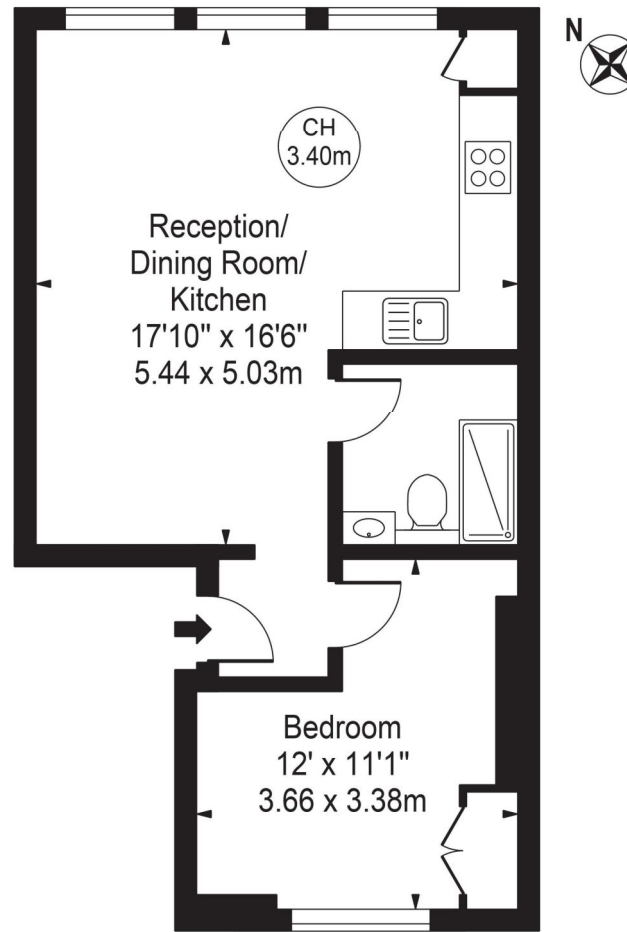

## First Floor

For Illustration Purposes Only - Not To Scale

This floor plan should be used as a general outline for guidance only and does not constitute in whole or in part an offer or contract. Any intending purchaser or lessee should satisfy themselves by inspection, searches, enquiries and full survey as to the correctness of each statement. Any areas, measurements or distances quoted are approximate and should not be used to value a property or be the basis of any sale or let. Copyright Morriart Photography & Design LTD

North Kensington | 020 7792 5000 | northkensington@winkworth.co.uk

[winkworth.co.uk](http://winkworth.co.uk)

Winkworth wishes to inform prospective buyers and tenants that these particulars are a guide and act as information only. All our details are given in good faith and believed to be correct at the time of printing but they don't form part of an offer or contract. No Winkworth employee has authority to make or give any representation or warranty in relation to this property. All fixtures and fittings, whether fitted or not are deemed removable by the vendor unless stated otherwise and room sizes are measured between internal wall surfaces, including furnishings.

**Winkworth**