



NETHER STREET, LONDON, N3
£990,000 FREEHOLD

A BEAUTIFULLY PRESENTED FIVE BEDROOM DETACHED HOUSE

Finchley | 020 8349 3388 | finchley@winkworth.co.uk



DESCRIPTION:

We are pleased to offer this five bedroom detached house, ideally located for West Finchley Underground and recreational parkland. The property comprises through-lounge, separate kitchen, conservatory, study, downstairs shower room + wc, five bedrooms, bathroom, front driveway and rear garden. An internal viewing is highly recommended!

COUNCIL TAX:

Band F - £2319.55 per annum

AT A GLANCE

- Detached house
- Five bedrooms
- Conservatory
- Downstairs shower + wc
- Driveway





Nether Street, N3

Approx. Gross Internal Floor Area 1853 sq. ft / 172.15 sq. m(Including Restricted Height Area)

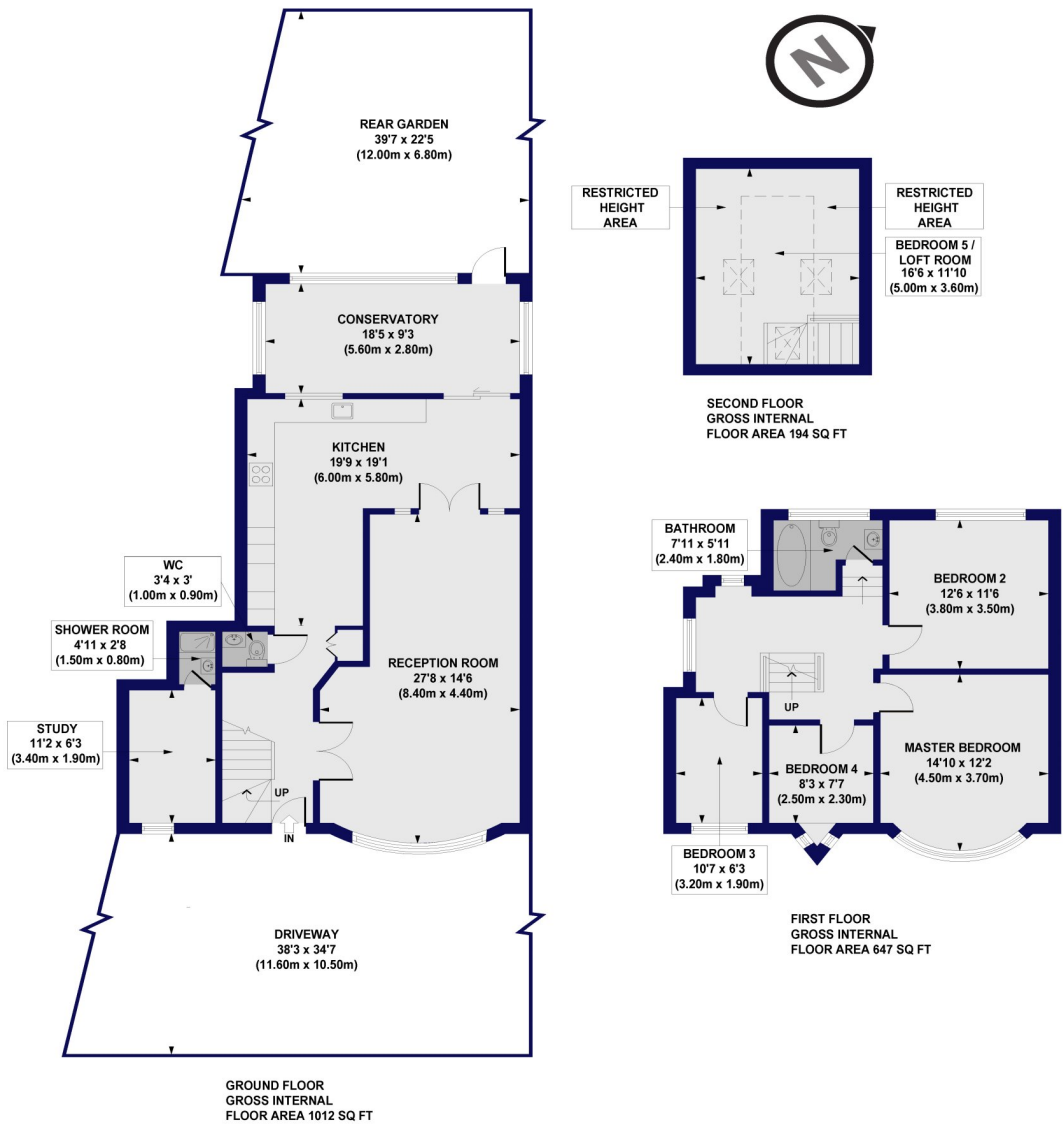

All measurements of walls, doors, windows, fittings and appliances, including their size and location, are shown as standard sizes and do not constitute any warranty or representation by the seller, their agent or CP Creative. Any intending purchaser must satisfy himself by inspection or otherwise as to the correctness of the information contained in these plans. This plan is for illustrative purposes only and should be used as such by any prospective purchasers.

Winkworth

This floorplan is for illustration purposes only and is not to scale. The position and size of doors, windows, appliances and other features are approximate.

