



**LONG LANE, LONDON, N3**  
**£600,000 LEASEHOLD**

## **A TWO DOUBLE BEDROOM TWO BATHROOM GROUND FLOOR GARDEN FLAT**

Finchley | 020 8349 3388 | [finchley@winkworth.co.uk](mailto:finchley@winkworth.co.uk)





## DESCRIPTION:

A Must See!!

A two double bedroom, two bathroom ground floor garden conversion flat. Situated within walking distance to Finchley Central underground, Victoria Park, Outstanding Ofsted Rated schools and local amenities. This lovely property comprises of two double bedrooms, two bathrooms (one en-suite), a large separate fully fitted eat-in kitchen and utility area, good size living room, and private South facing garden. Further benefits include a long lease.

## AT A GLANCE

- Ground floor garden flat
- Two double bedrooms
- Two bathrooms (one en suite)
- Long Lease
- Ideally located

## COUNCIL TAX:

Band D







Winkworth



Winkworth



Winkworth



Winkworth



Winkworth



# Long Lane, N3

Approx. Gross Internal Floor Area 900 sq. ft / 83.60 sq. m

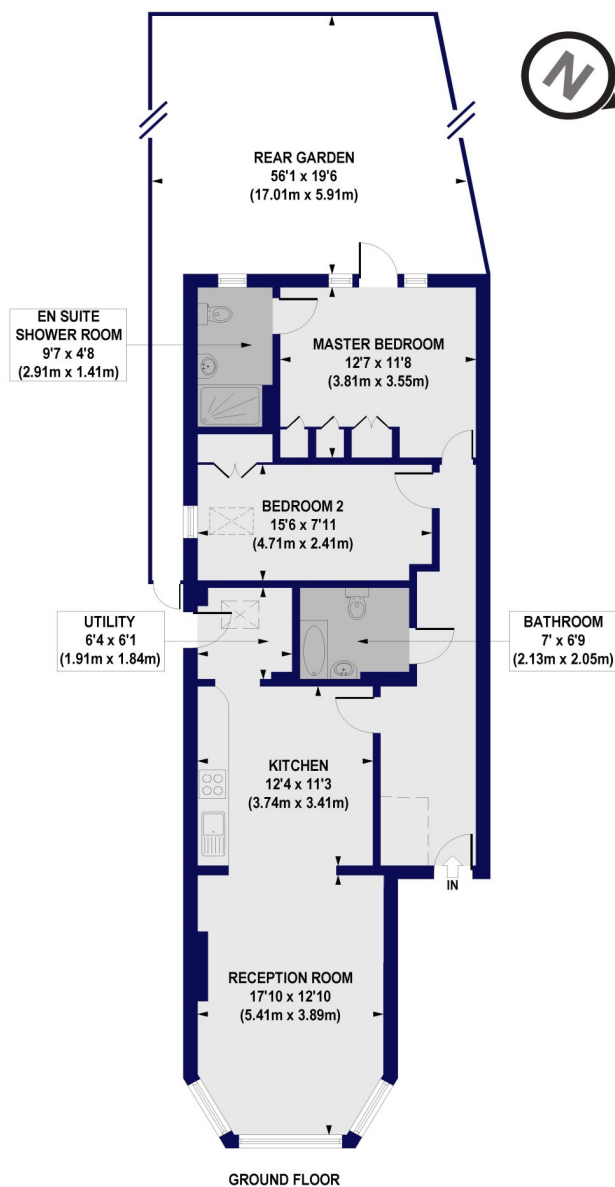

All measurements of walls, doors, windows, fittings and appliances, including their size and location, are shown as standard sizes and do not constitute any warranty or representation by the seller, their agent or CP Creative. Any intending purchaser must satisfy himself by inspection or otherwise as to the correctness of the information contained in these plans. This plan is for illustrative purposes only and should be used as such by any prospective purchasers.

**Winkworth**

